

**IMPORTANT** - READ CAREFULLY BEFORE INSTALLING FIXTURE. RETAIN THESE INSTRUCTIONS FOR FUTURE REFERENCE. THIS PRODUCT MUST BE INSTALLED IN ACCORDANCE WITH THE NATIONAL ELECTRICAL CODE AND ALL APPLICABLE LOCAL CODES, BY A PERSON FAMILIAR WITH THE CONSTRUCTION AND OPERATION OF THE PRODUCT, AND THE HAZARDS INVOLVED. PROPER GROUNDING IS REQUIRED FOR SAFETY.

**⚠ DISCONNECT THE MAIN LINE BEFORE WIRING SECONDARY CONNECTORS.**

## INSTALLING PROJECTOR WITH CANOPY (120-277V)

- A- MAKE ALL NECESSARY CONNECTIONS (**FOLLOWING WIRING DIAGRAM**) BETWEEN THE DRIVER, THE BRANCH CIRCUIT AND 0-10V DIMMING (OPTIONAL) USING TWIST CONNECTORS (**NOT INCLUDED**).
- B- FASTEN THE MOUNTING BRACKET TO THE JUNCTION BOX USING (2) 8-32 PHILLIPS SCREWS (**NOT INCLUDED**).
- C- CONNECT THE DRIVER TO THE LIGHTING FIXTURE (**FOLLOWING POLARITY MARKING**) WITH THE QUICK CONNECTORS (**INCLUDED**).  
\*PUSH THE CONNECTORS AND WIRES INTO THE JUNCTION BOX.
- D- FASTEN THE CANOPY TO THE THE MOUNTING BRACKET USING THE (2) PHILLIPS SCREWS (**INCLUDED**).

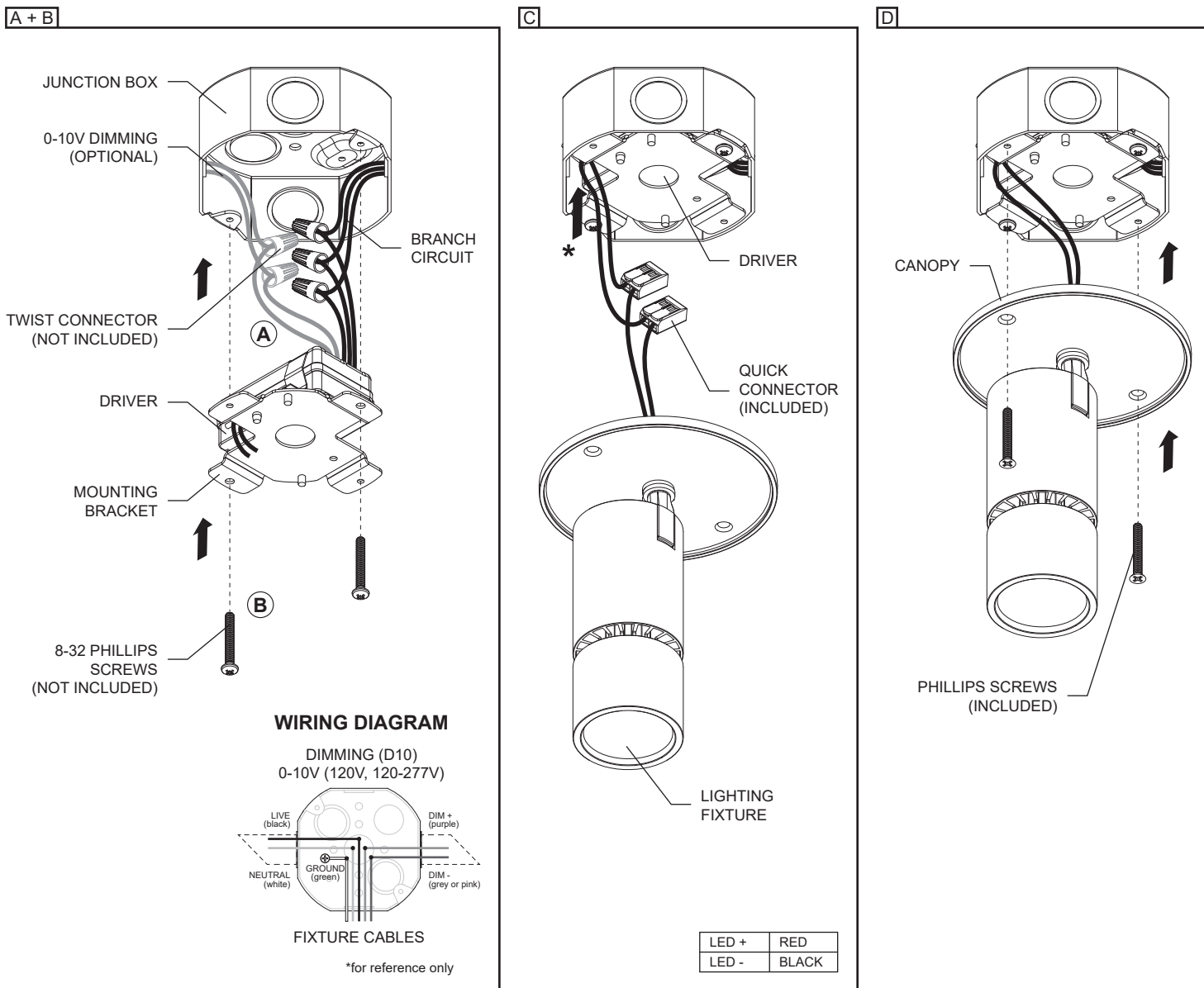

**INSTALLING PROJECTOR WITH CANOPY AND LTE DIMMING (120V)**

- A- MAKE ALL NECESSARY CONNECTIONS (**FOLLOWING WIRING DIAGRAM**) BETWEEN THE DRIVER AND THE BRANCH CIRCUIT USING TWIST CONNECTORS (**NOT INCLUDED**).
- B- FASTEN THE MOUNTING BRACKET TO THE JUNCTION BOX USING (2) 8-32 PHILLIPS SCREWS (**NOT INCLUDED**).
- C- CONNECT THE DRIVER TO THE LIGHTING FIXTURE (**FOLLOWING POLARITY MARKING**) WITH THE QUICK CONNECTORS (**INCLUDED**).
- D- FASTEN THE CANOPY TO THE THE MOUNTING BRACKET WITH THE (2) SET SCREWS (**INCLUDED**) USING AN ALLEN KEY (**INCLUDED**).

**A + B**

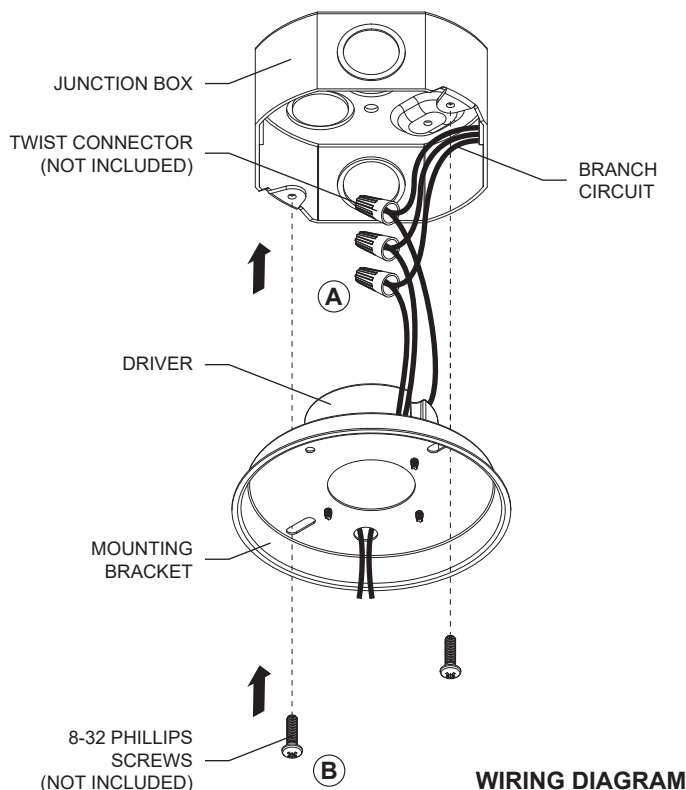

**WIRING DIAGRAM**

DIMMING (LTE)  
TRIAC/ELV (120V ONLY)

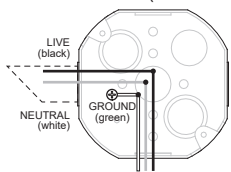

\*for reference only

**C + D**

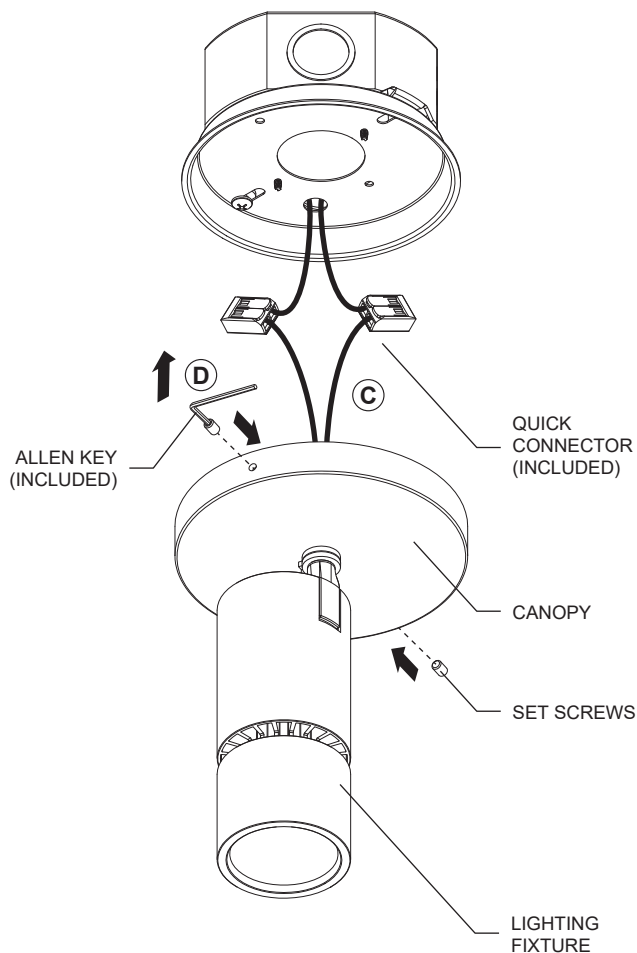

LED +	RED
LED -	BLACK

**PAN ANGLE POSITION**

ADJUST THE FIXTURE TO DESIRED PAN POSITION (MAXIMUM OF 330° AXIAL ROTATION).

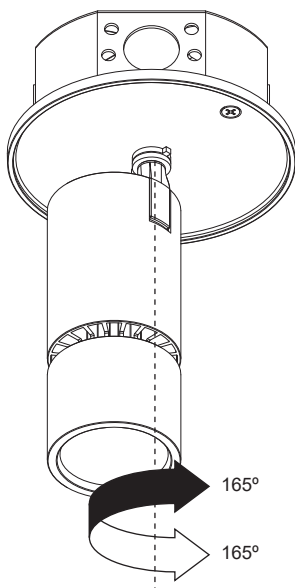

**TILT ANGLE POSITION**

ADJUST THE FIXTURE TO DESIRED TILT POSITION (MAXIMUM OF 90° AXIAL ROTATION).

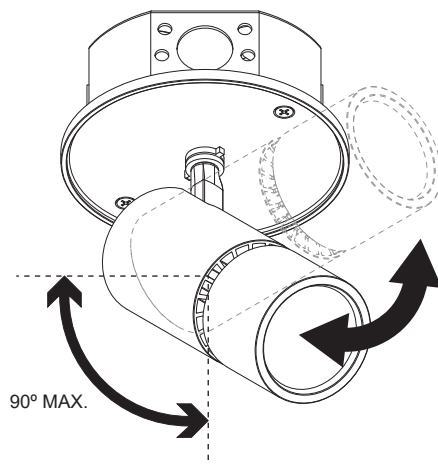

**REPLACING COMPONENTS FOR REFLECTOR MODELS**

A - UNSCREW THE OPTIC HOLDER TO ACCESS THE COMPONENTS.  
B - REPLACE THE REFLECTOR AND RE-INSTALL THE OPTIC HOLDER BACK IN PLACE.

A + B

