

**IMPORTANT** - READ CAREFULLY BEFORE INSTALLING FIXTURE. RETAIN THESE INSTRUCTIONS FOR FUTURE REFERENCE.

THIS PRODUCT MUST BE INSTALLED IN ACCORDANCE WITH THE NATIONAL ELECTRICAL CODE AND ALL APPLICABLE LOCAL CODES, BY A PERSON FAMILIAR WITH THE CONSTRUCTION AND OPERATION OF THE PRODUCT, AND THE HAZARDS INVOLVED. PROPER GROUNDING IS REQUIRED FOR SAFETY.

## INSTALLING PROJECTOR ON TWO CIRCUIT TRACK (120V OR 277V)

FOR USE WITH **TEK SERIES** (120V) TRACK SYSTEM - OR **HTEK SERIES** (277V) TRACK SYSTEM ONLY.

A- INSERT THE PROJECTOR TRACK ADAPTOR WITH THE POLARITY GROOVE TOWARDS THE POLARITY RIDGE ON THE TRACK AND PUSH INTO THE TRACK UNTIL IT SNAPS INTO PLACE.

B- TURN THE MECHANICAL FIXING LEVER TO **LOCK** THE PROJECTOR INTO THE TRACK.

C- SELECT THE DESIRED CIRCUIT WITH THE CIRCUIT SELECTOR SWITCH.

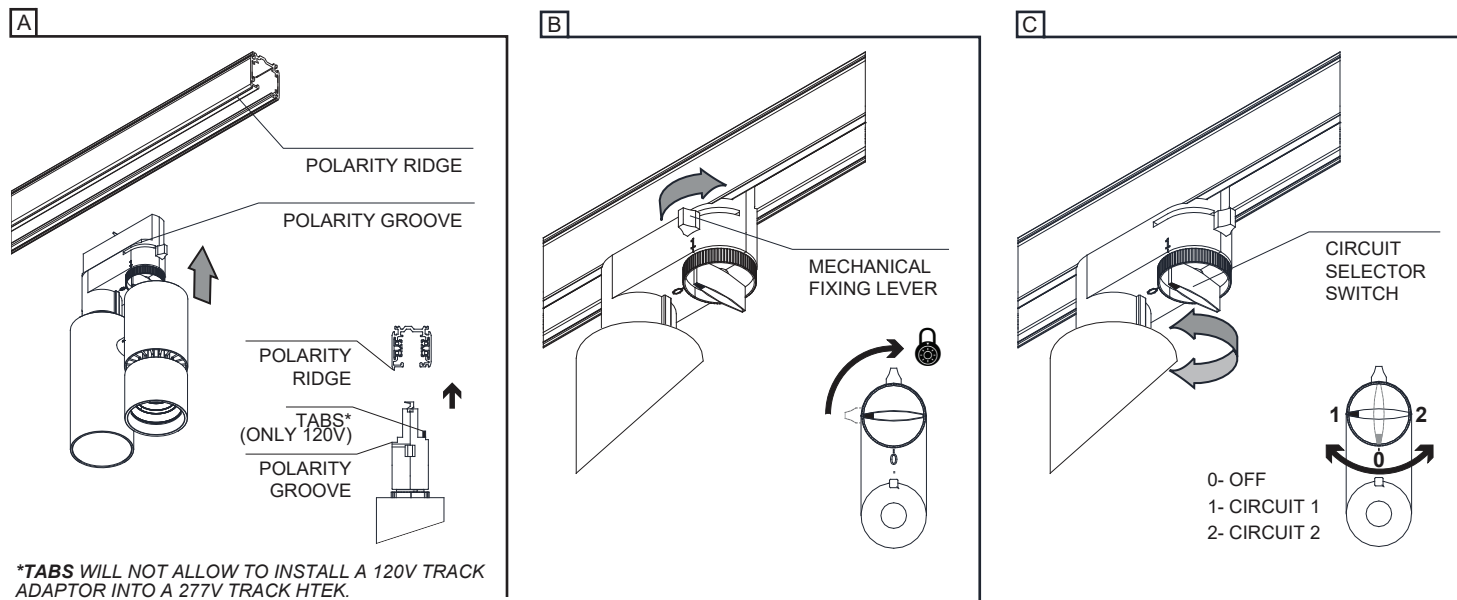

## REMOVING PROJECTOR FROM TRACK

A- TO REMOVE THE PROJECTOR FROM TRACK, SELECT 0-POSITION (**OFF**) ON THE CIRCUIT SELECTOR SWITCH.

B- TURN THE MECHANICAL FIXING LEVER AS SHOWN TO **UNLOCK** THE PROJECTOR FROM THE TRACK.

C- PULL FIRST FROM THE FIXING LEVER END TO REMOVE THE PROJECTOR FROM THE TRACK.

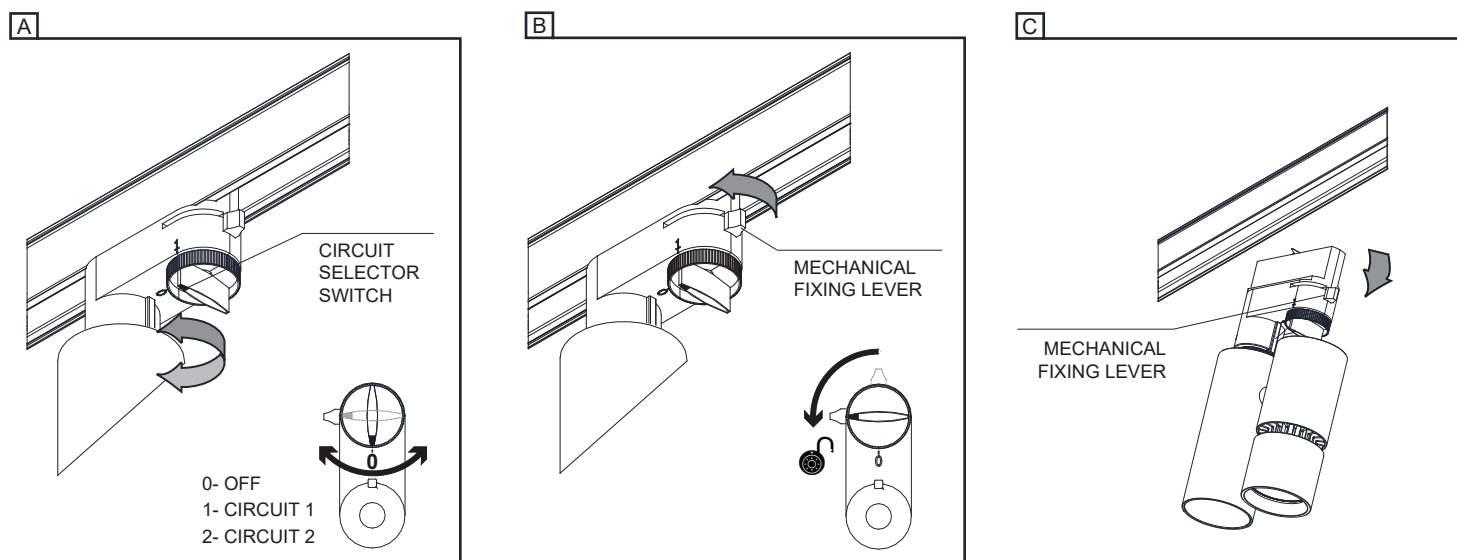

## PAN ANGLE POSITION

- A- ADJUST THE DESIRED POSITION USING THE PAN ANGLE INDICATOR. (MAXIMUM OF 330° AXIAL ROTATION)  
B- LOCK THE POSITION WITH THE PAN ADJUSTMENT LOCKING SCREW

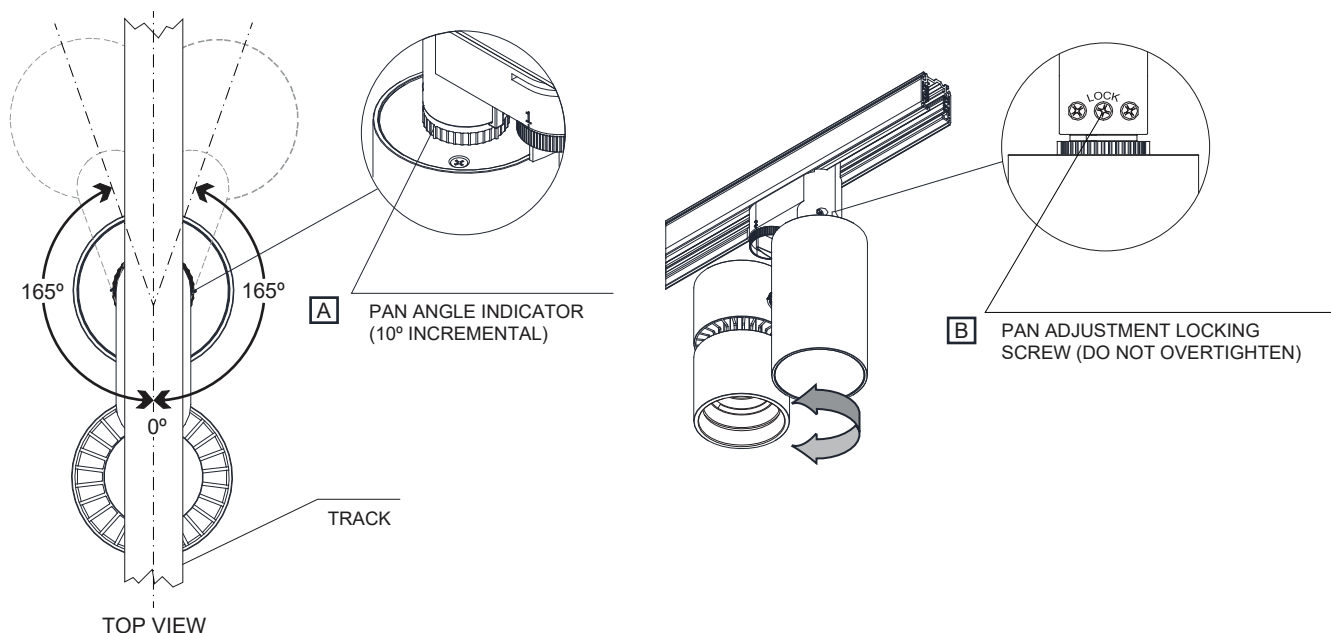

## TILT ANGLE POSITION

- A- ADJUST THE DESIRED POSITION USING THE TILT ANGLE INDICATOR.  
B- LOCK THE POSITION WITH THE TILT ADJUSTMENT LOCKING SCREW. USE THE 5/64 ALLEN KEY PROVIDED.

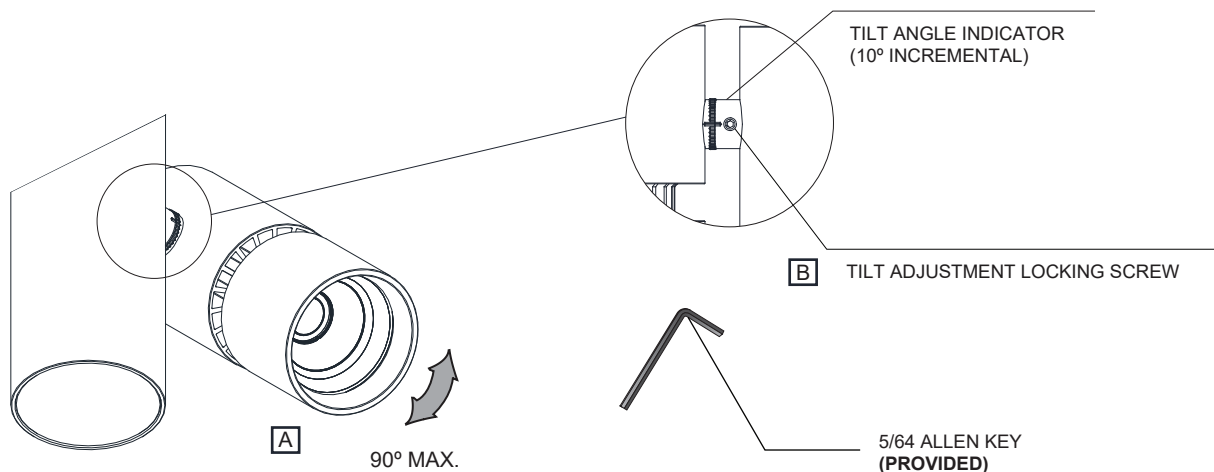

**NOT UNLOCKING THE LOCKING SET SCREW TO CHANGE THE TILT ANGLE WILL CAUSE INTERNAL DAMAGE TO THE PROJECTOR.**

## REPLACING OPTIC FOR REFLECTOR MODELS

- A- REMOVE OPTICAL HOUSING BY ROTATING COUNTERCLOCKWISE.  
B- LEAVE THE PROTECTIVE LENS IN THE OPTICAL HOUSING.  
C- REMOVE OLD REFLECTOR AND INSERT THE NEW ONE INTO THE OPTICAL HOUSING.  
D- RE-INSTALL THE PROTECTIVE LENS, OPTICAL HOUSING AND REFLECTOR TOGETHER BY ROTATING CLOCKWISE.

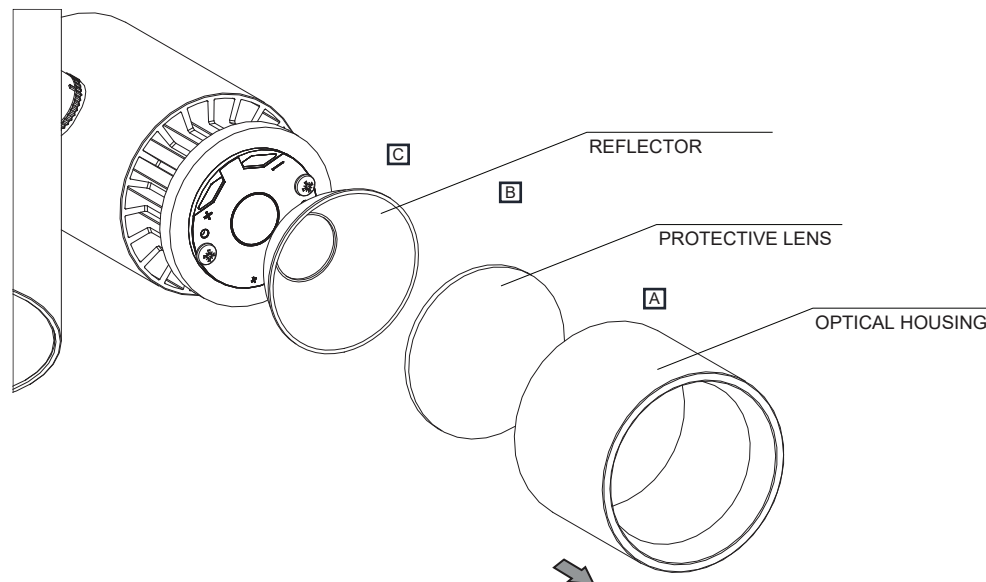

## ACCESSORIES

- A- TO REPLACE OR ADD AN ACCESSORY, REMOVE OPTICAL HOUSING BY ROTATING IT COUNTERCLOCKWISE.  
B- INSERT ONE OR MORE ACCESSORIES INTO THE OPTIC HOUSING.  
C- RE-INSTALL THE ACCESSORIES AND OPTICAL HOUSING TOGETHER BY ROTATING CLOCKWISE.  
(A MAXIMUM OF 3 ACCESSORIES IN COMBINATION)

