

IMPORTANT - READ CAREFULLY BEFORE INSTALLING FIXTURE. RETAIN THESE INSTRUCTIONS FOR FUTURE REFERENCE.
THIS PRODUCT MUST BE INSTALLED IN ACCORDANCE WITH THE NATIONAL ELECTRICAL CODE AND ALL APPLICABLE LOCAL CODES, BY A PERSON FAMILIAR WITH THE CONSTRUCTION AND OPERATION OF THE PRODUCT, AND THE HAZARDS INVOLVED. PROPER GROUNDING IS REQUIRED FOR SAFETY.

INSTALLING PROJECTOR ON ONE CIRCUIT TRACK (120V)

FOR USE WITH **SISTEMALUX 8000 SERIES, OR SISTEMALUX 8000-S1 SERIES** TRACK SYSTEM ONLY (120V).

- A- PULL THE ADAPTOR HOUSING DOWN TO INSERT IN THE TRACK FOLLOWING INITIAL POSITION SHOWN BELOW.
B- PUSH THE PROJECTOR INTO TRACK AND ROTATE THE TRACK ADAPTOR A QUARTER TURN IN THE PROPER DIRECTION IN ORDER TO ALLOW ELECTRICAL BOUNDING. MAKE SURE THE ADAPTOR IS LOCKED IN PLACE, FOLLOWING FINAL POSITION SHOWN BELOW.

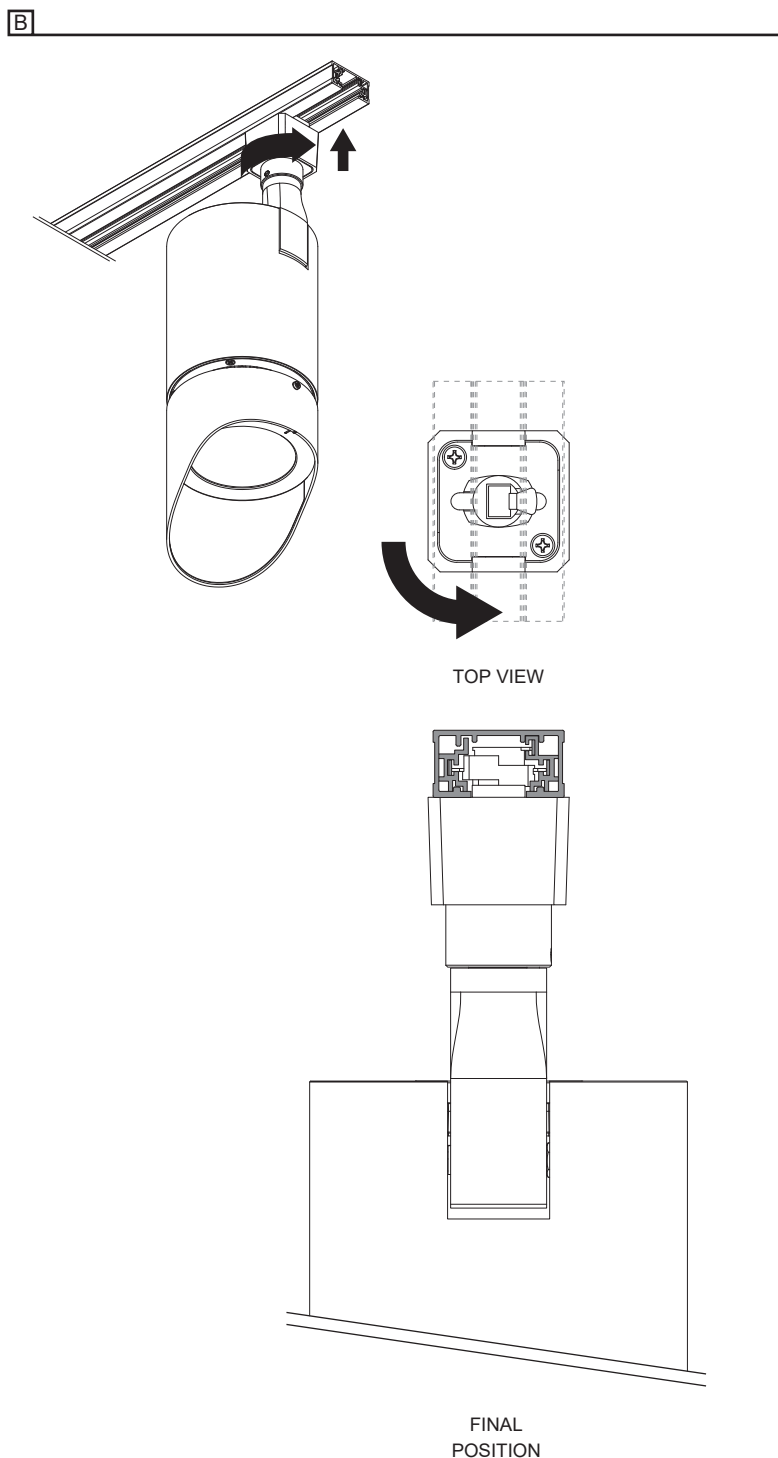
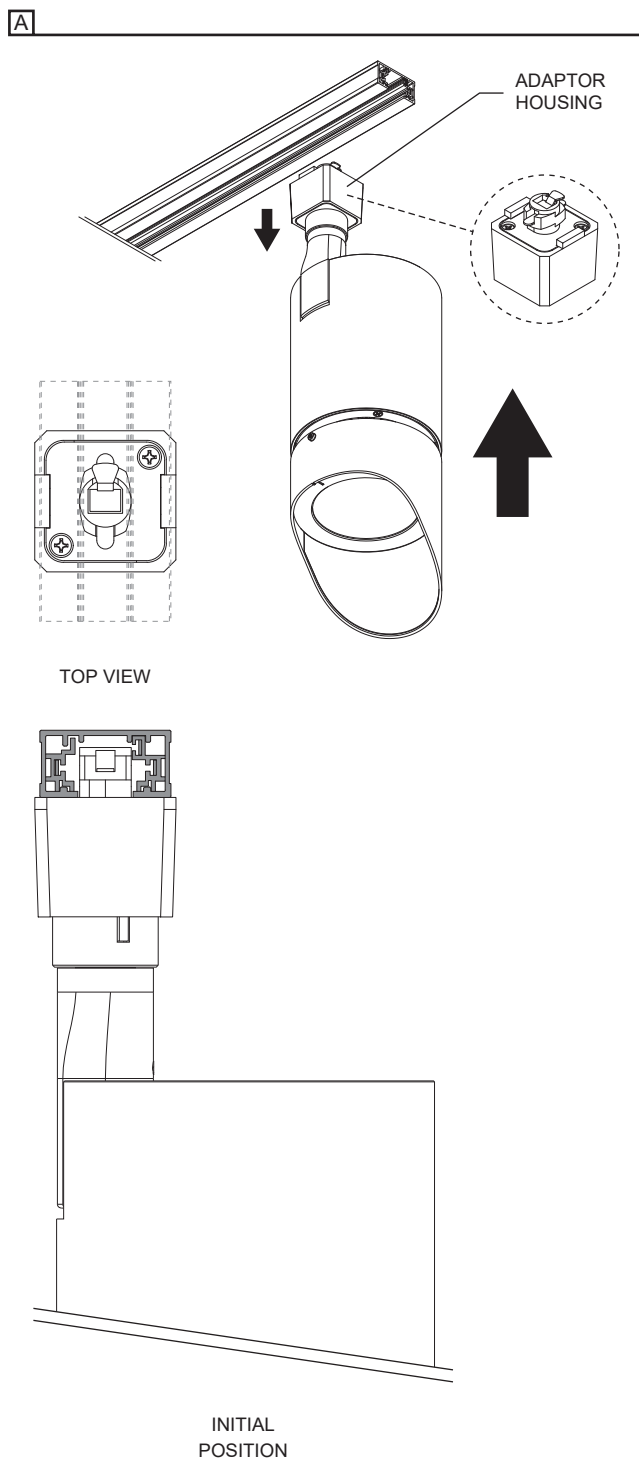

REMOVING PROJECTOR FROM TRACK (1780S1)

PULL DOWN THE TRACK ADAPTOR HOUSING TO UNLOCK IT FROM THE TRACK SLOT (1). WHILE HOLDING THE TRACK ADAPTOR HOUSING DOWN, ROTATE A QUARTER TURN IN ANY DIRECTION (2) AND PULL DOWN THE PROJECTOR TO REMOVE IT FROM THE TRACK (3).

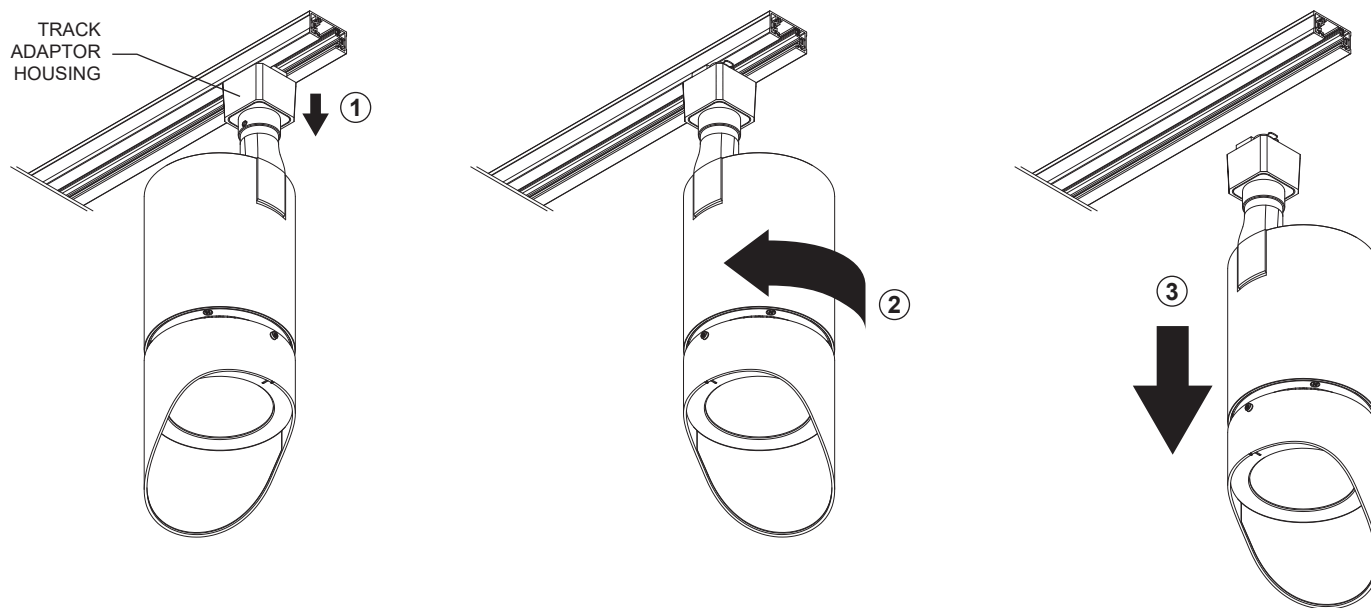
**PAN ANGLE POSITION (1780S1)**

A- LOOSEN THE PAN ADJUSTMENT LOCKING SCREW USING A SLOTTED SCREWDRIVER.

B- SET TO THE DESIRED PAN POSITION (**MAXIMUM OF 330° AXIAL ROTATION**) AND FASTEN THE SCREW (**DO NOT OVERTIGHTEN**).

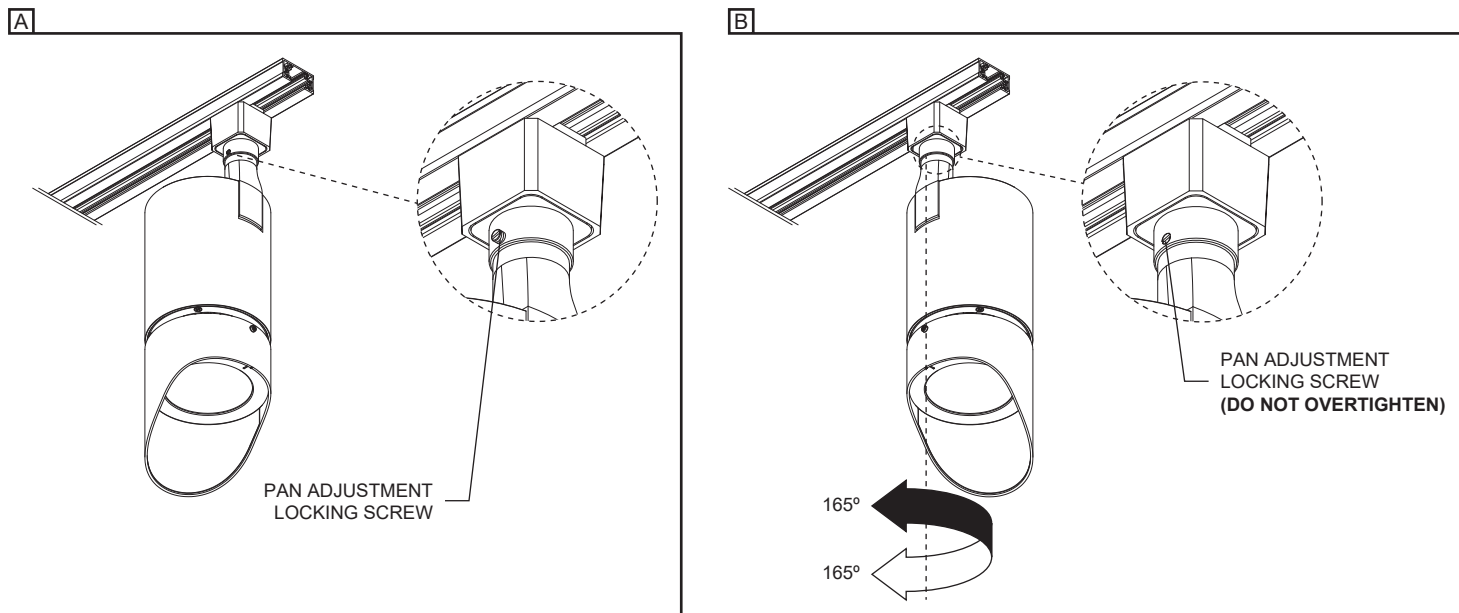

TILT ANGLE POSITION (1780S1)

A- LOOSEN THE TILT ADJUSTMENT LOCKING SCREW USING A SLOTTED SCREWDRIVER.

B- SET TO THE DESIRED TILT POSITION (**MAXIMUM OF 90° AXIAL ROTATION**) AND FASTEN THE SCREW (**DO NOT OVERTIGHTEN**).

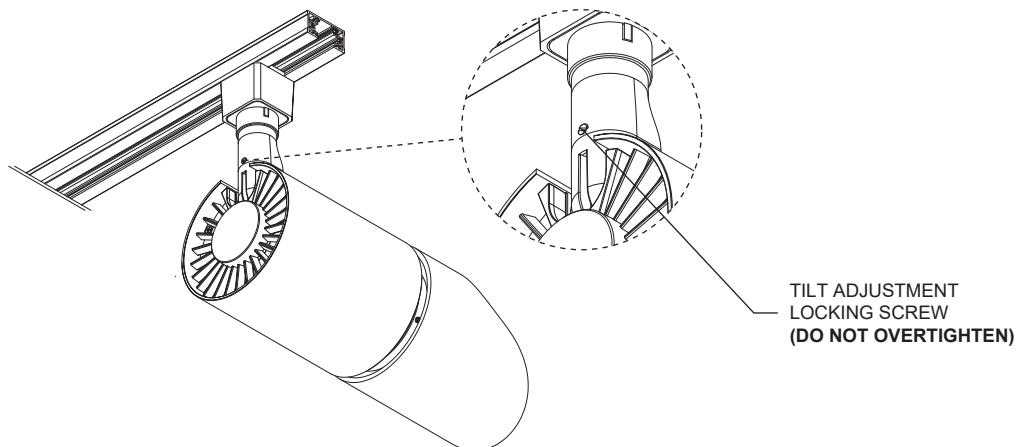
A

NOT UNLOCKING THE LOCKING SET SCREW TO CHANGE THE TILT ANGLE WILL CAUSE INTERNAL DAMAGE TO THE PROJECTOR.

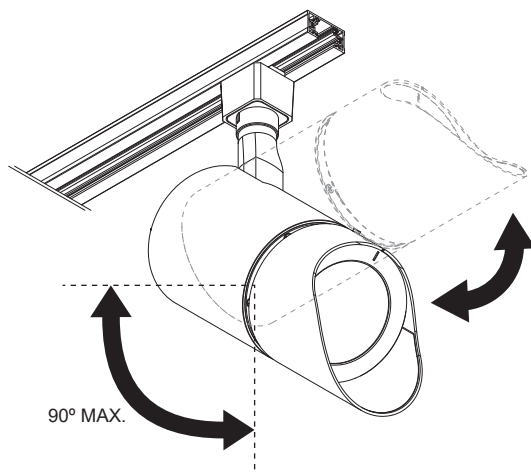
B

REPLACING OPTIC

A- UNFASTEN THE VISOR SET SCREW USING AN ALLEN KEY (**INCLUDED**) AND REMOVE THE VISOR. **DO NOT REMOVE THE SET SCREW.**

B- UNSCREW THE OPTIC HOLDER FROM THE FIXTURE.

C- REPLACE THE LENS AND SET THE LENS INTO THE OPTIC HOLDER PINS. ***THE LENS GLOSSY SIDE MUST BE FACING OUTWARD.**

D- SCREW THE OPTIC HOLDER BACK ON THE FIXTURE.

E- UNFASTEN THE OPTIC HOLDER (2) SET SCREWS. **DO NOT COMPLETELY REMOVE THE SET SCREW.**

F- ROTATE THE OPTIC HOLDER'S FRONT RING UNTIL THE NOTCH IS ALIGNED AND CENTERED WITH THE FIXTURE ARM.

DO NOT ROTATE THE OPTIC HOLDER.

G- FASTEN THE OPTIC HOLDER (2) SET SCREWS.

H- SLIDE THE VISOR BACK ON THE FIXTURE HOLDER AND FASTEN THE SET SCREW.

***MAKE SURE THE VISOR ALIGNMENT DETAIL IS ALIGNED WITH THE OPTIC HOLDER NOTCH BEFORE TIGHTENING.**

