

TRIM : LOG4/5/6 - R/S - T - NC/RF - X - XXX - XXX - 120/277 - XX - D01/D2B/D3

IMPORTANT - READ CAREFULLY BEFORE INSTALLING FIXTURE. RETAIN THESE INSTRUCTIONS FOR FUTURE REFERENCE.
THIS PRODUCT MUST BE INSTALLED IN ACCORDANCE WITH THE NATIONAL ELECTRICAL CODE AND ALL APPLICABLE LOCAL CODES, BY A PERSON FAMILIAR WITH THE CONSTRUCTION AND OPERATION OF THE PRODUCT, AND THE HAZARDS INVOLVED. PROPER GROUNDING IS REQUIRED FOR SAFETY.

⚠ DISCONNECT THE MAIN LINE BEFORE WIRING SECONDARY CONNECTORS.

NEW CONSTRUCTION WITH PLASTER FRAME / REMODELING INSTALLATION (NC/RF) INTEGRAL DRIVER (120/277V) LUTRON BUS SUPPLY (D2B) / 0-10V (D01)/ LUTRON TRIAC (120V)(D3)

- A- LOOSEN THE COVER SCREW TO OPEN THE CONNECTION BOX COVER.
B- INSTALL BX CABLE (NOT INCLUDED) WITH 6" OF WIRE IN THE CONNECTION BOX AND MAKE ALL NECESSARY CONNECTIONS (SEE WIRING DIAGRAM BELOW).
C- CLOSE THE CONNECTION BOX COVER AND FASTEN WITH THE COVER SCREW.
D- PASS THE CABLE LOOP THROUGH THE ATTACHEMENT CLIP OF THE CONNECTION BOX.
E- INSERT THE CONNECTION BOX THROUGH THE CUT-OUT. THE CONNECTION BOX MUST SETTLE ON THE PLASTER FRAME/CEILING ONCE INSTALLED.

A + B

LUTRON BUS SUPPLY (D2B), 0-10V (D01)
AND LUTRON TRIAC (D3) OPTIONS

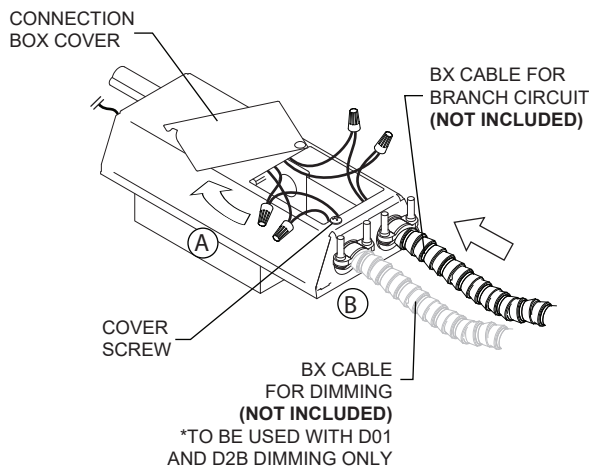

DIMMING (D3)
LUTRON TRIAC
(120V ONLY)

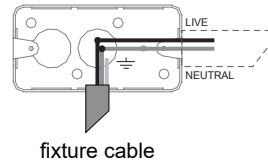

LIVE	BLACK
NEUTRAL	WHITE
⏏	GREEN
DIM +	PURPLE
DIM -	GRAY OR PINK

DIMMING (D2B)
LUTRON BUS SUPPLY

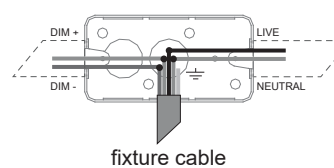

DIMMING (D01)
0-10V

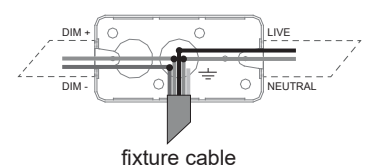

*junction box for reference only

C

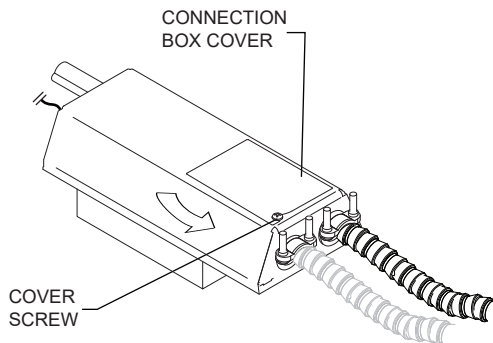

D+E

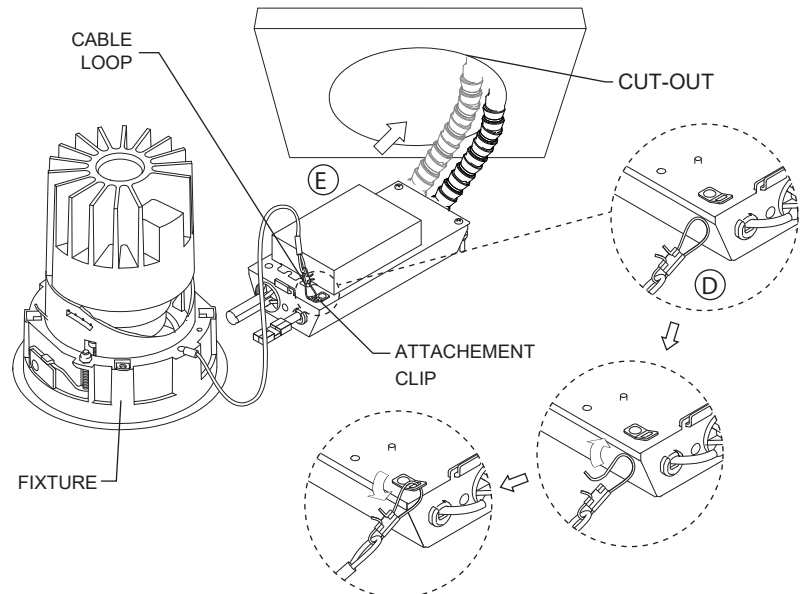

F- REMOVE THE BAFFLE FROM THE FIXTURE.

G- CONNECT FIXTURE.

H- PLACE FIXATION BRACKET TABS TO THE DESIRED POSITION DEPENDING ON CEILING THICKNESS.

I- INSERT FIXTURE THROUGH CUT-OUT.

J- TIGHTEN THE FIXTURE IN THE CUT-OUT. MAKE SURE THE FIXATION BRACKETS ARE OPEN FOR PROPER INSTALLATION.

FOR ADJUSTABLE MODELS ONLY: TO ADJUST THE TILT ANGLE, USE THE TILT ADJUSTMENT SCREW IN THE FIXTURE.

K- REPLACE THE BAFFLE

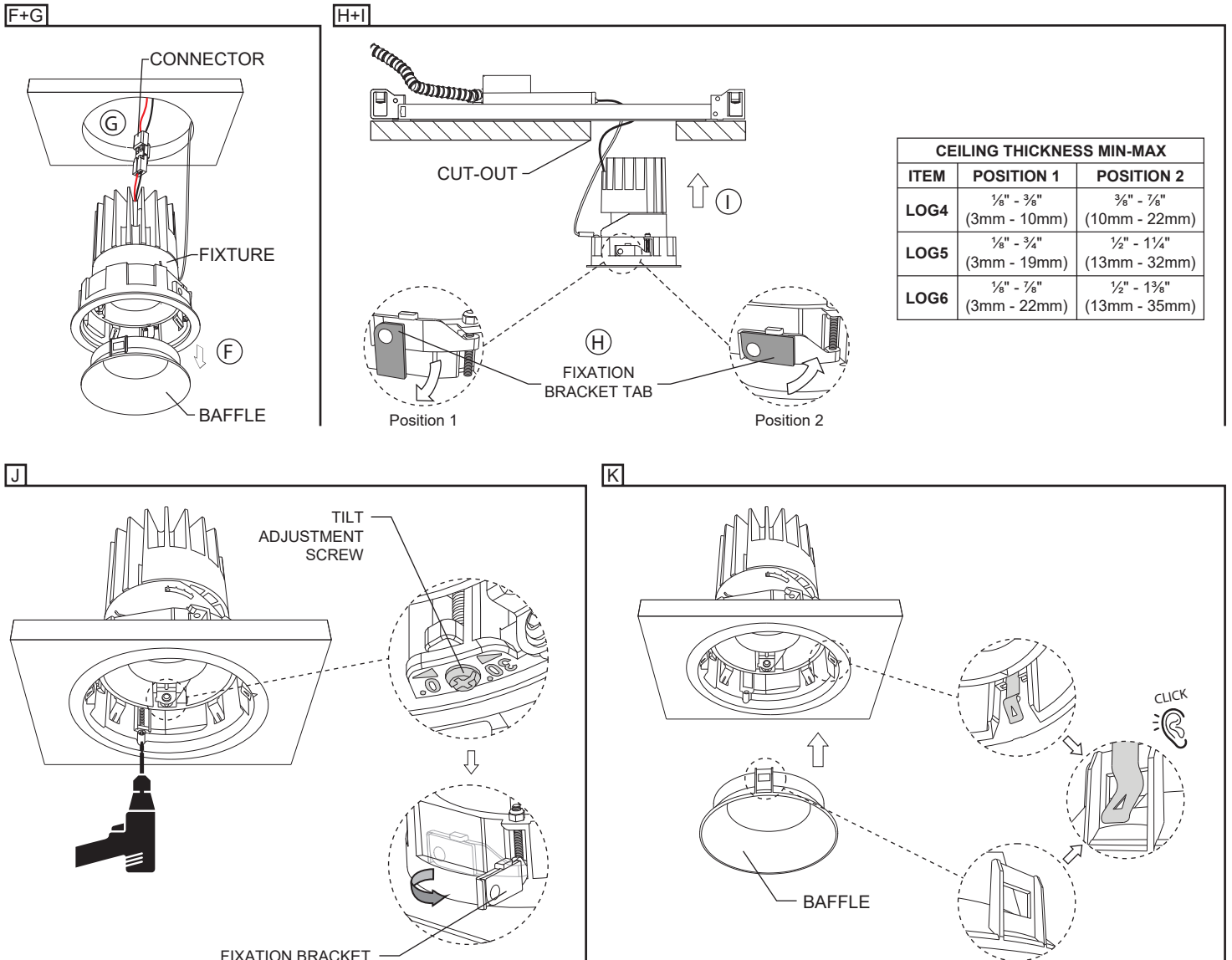

RECOMMENDED LINE DIMMERS LIST

DIMMERS LIST RECOMMANDATION	
Manufacturer	Model
LUTRON DIVA	DVSTV-WH
LUTRON POWERPAK	RMJ-ECO32-DV-B