

IMPORTANT - READ CAREFULLY BEFORE INSTALLING FIXTURE. RETAIN THESE INSTRUCTIONS FOR FUTURE REFERENCE.

THIS PRODUCT MUST BE INSTALLED IN ACCORDANCE WITH THE NATIONAL ELECTRICAL CODE AND ALL APPLICABLE LOCAL CODES, BY A PERSON FAMILIAR WITH THE CONSTRUCTION AND OPERATION OF THE PRODUCT, AND THE HAZARDS INVOLVED. PROPER GROUNDING IS REQUIRED FOR SAFETY.

INSTALLING PROJECTOR ON A THREE CIRCUIT PULSE TRACK (120V)

FOR USE WITH **GLOBAL PULSE®** (120V) THREE CIRCUIT TRACK SYSTEM ONLY (0266, 0267, 0268).

A- INSERT THE PROJECTOR TRACK ADAPTOR WITH THE POLARITY GROOVE TOWARDS THE POLARITY RIDGE ON THE TRACK AND PUSH INTO THE TRACK UNTIL IT SNAPS INTO PLACE.

B- PUSH THE MECHANICAL FIXING LEVER TO THE RIGHT TO LOCK THE PROJECTOR INTO THE TRACK.

C- SELECT THE DESIRED CIRCUIT WITH THE CIRCUIT SELECTOR SWITCH AND PUSH LEFT THE 0-10V SWITCH.

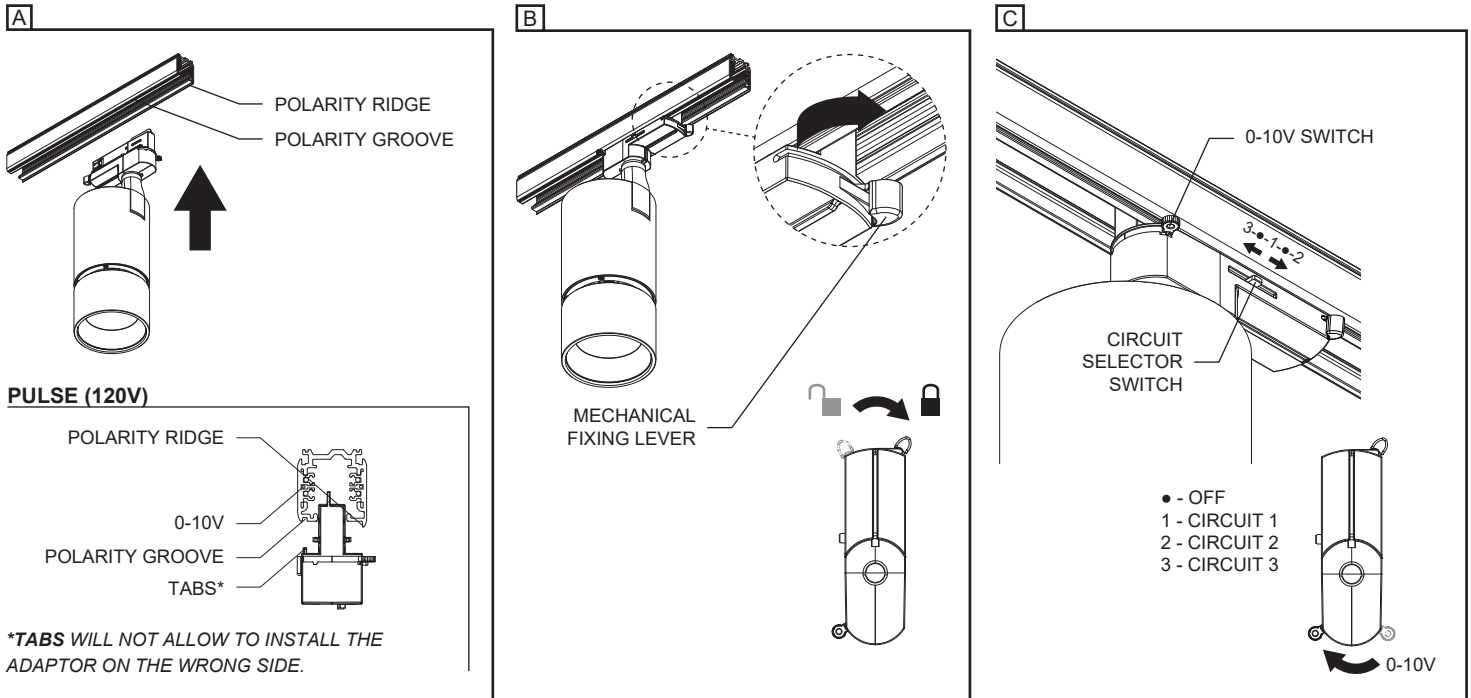

REMOVING PROJECTOR FROM A THREE CIRCUIT PULSE TRACK

A- SELECT THE • POSITION (**OFF**) ON THE CIRCUIT SELECTOR SWITCH AND PUSH THE 0-10V SWITCH TO THE RIGHT.

B- TURN THE MECHANICAL FIXING LEVER AS SHOWN TO **UNLOCK** THE PROJECTOR FROM THE TRACK.

C- PULL FIRST FROM THE FIXING LEVER END TO REMOVE THE PROJECTOR FROM THE TRACK.

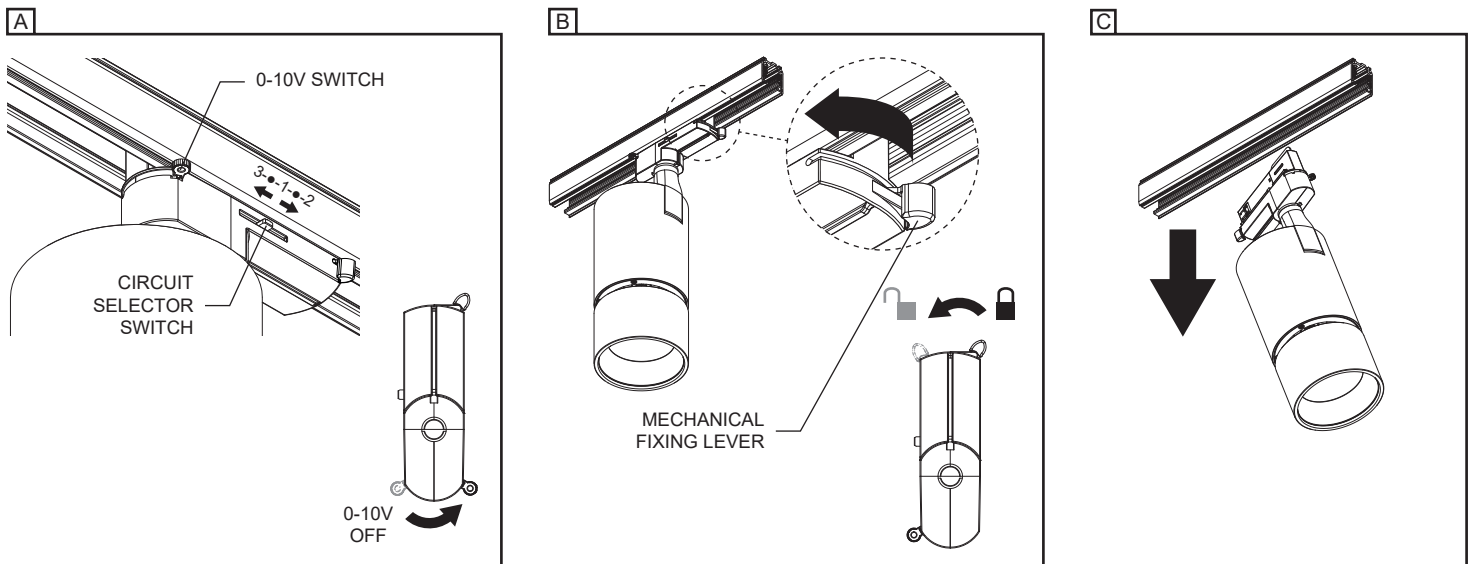

PAN ANGLE POSITION

A- SET TO THE DESIRED PAN POSITION (**MAXIMUM OF 330° AXIAL ROTATION**).

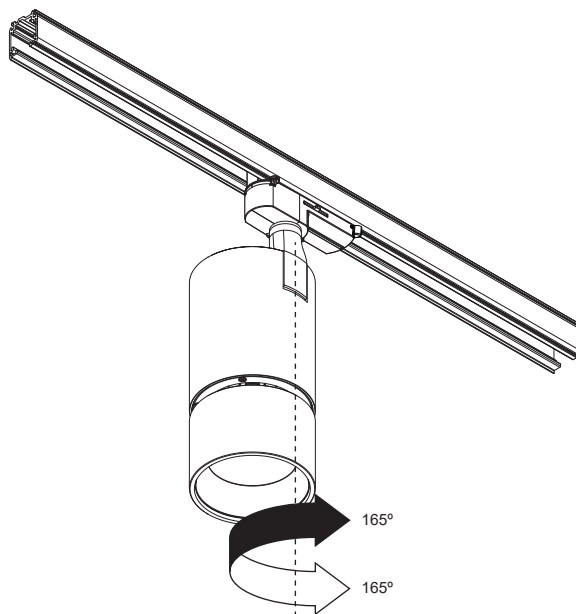
A**TILT ANGLE POSITION**

A- LOOSEN THE TILT ADJUSTMENT LOCKING SCREW USING A SLOTTED SCREWDRIVER.

B- SET TO THE DESIRED TILT POSITION (**MAXIMUM OF 90° AXIAL ROTATION**) AND FASTEN THE SCREW (**DO NOT OVERTIGHTEN**).

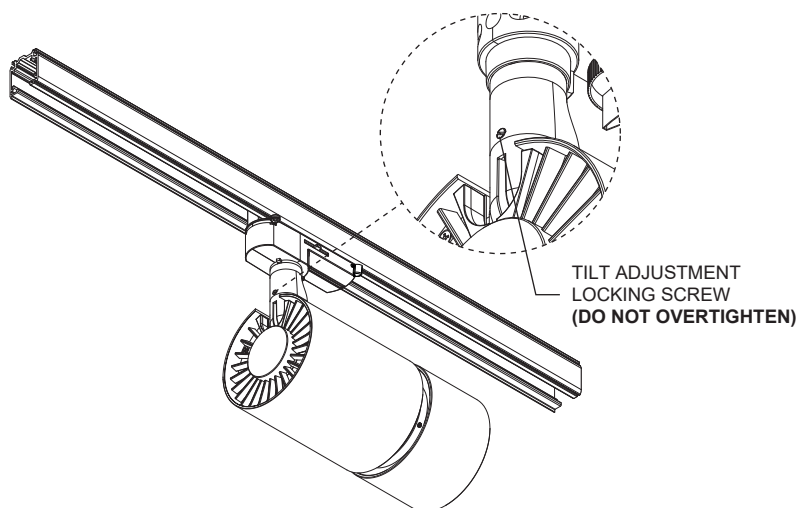
A

 FOR 1780 AND 1790 MODELS, NOT UNLOCKING THE LOCKING SET SCREW TO CHANGE THE TILT ANGLE WILL CAUSE INTERNAL DAMAGE TO THE PROJECTOR.

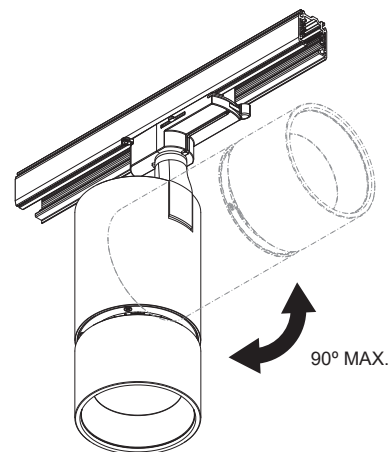
B

REPLACING OPTIC

A- UNSCREW THE OPTIC HOLDER TO ACCESS THE REFLECTOR.

B- REPLACE THE REFLECTOR AND RE-INSTALL THE OPTIC HOLDER BACK IN PLACE.

A + B

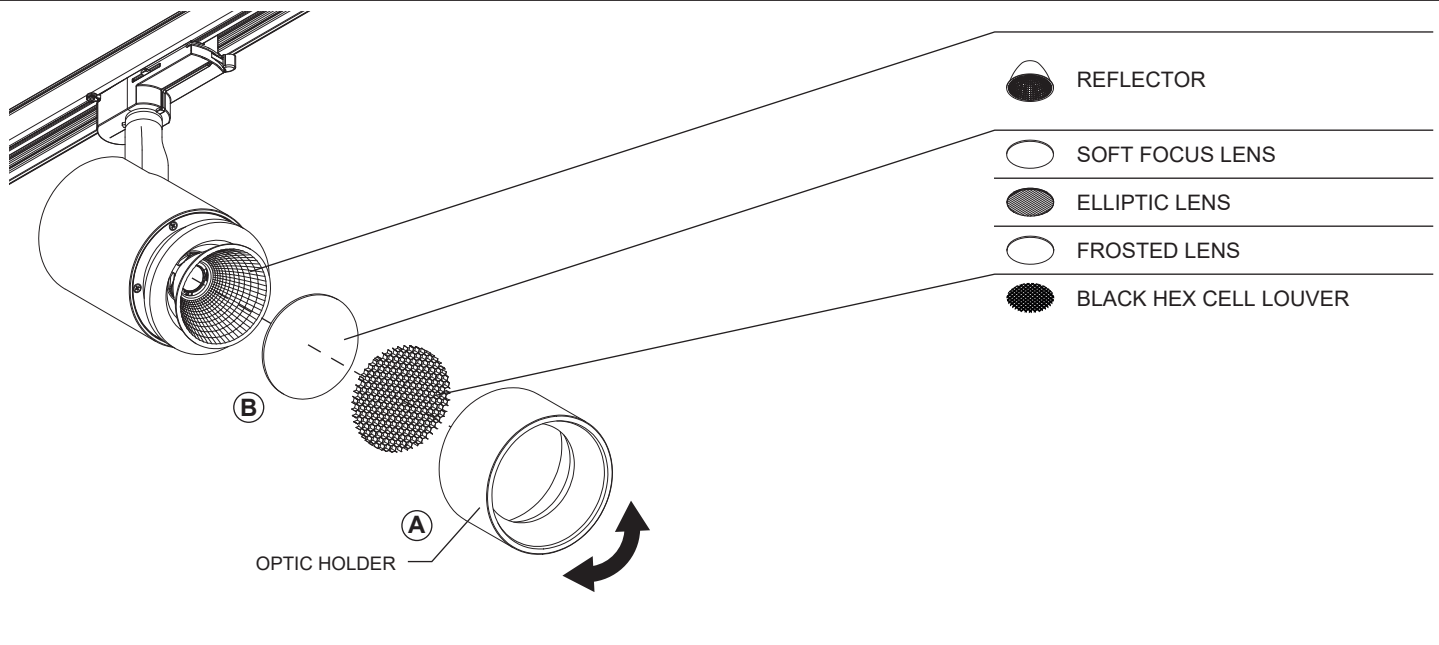

REPLACING OPTIC

A- UNSCREW THE OPTIC HOLDER

B- PLACE ACCESSORY BETWEEN THE OPTIC HOLDER AND THE ACCESSORY HOLDER

C- RE-INSTALL THE OPTIC HOLDER BACK IN PLACE.

A + B + C

