

TRIM : LOG4/5/6 - R/S - T - NC/RF - X - XXX - XXX - 120/277 - XX - D10/LTE

IMPORTANT - READ CAREFULLY BEFORE INSTALLING FIXTURE. RETAIN THESE INSTRUCTIONS FOR FUTURE REFERENCE.

THIS PRODUCT MUST BE INSTALLED IN ACCORDANCE WITH THE NATIONAL ELECTRICAL CODE AND ALL APPLICABLE LOCAL CODES, BY A PERSON FAMILIAR WITH THE CONSTRUCTION AND OPERATION OF THE PRODUCT, AND THE HAZARDS INVOLVED. PROPER GROUNDING IS REQUIRED FOR SAFETY.

⚠ DISCONNECT THE MAIN LINE BEFORE WIRING SECONDARY CONNECTORS.

NEW CONSTRUCTION WITH PLASTER FRAME / REMODELING INSTALLATION (NC/RF) INTEGRAL DRIVER (120 / 277V) DIMMING 0-10V / TRIAC / ELV (D10 / LTE)

A- BRANCH CIRCUIT CONNECTIONS: LOOSEN THE COVER SCREW TO OPEN THE CONNECTION BOX COVER.

DIMMING CONNECTIONS: LOOSEN THE COVER SCREW TO OPEN THE DIMMING BOX COVER.

B- INSTALL BX CABLE (NOT INCLUDED) WITH 6" OF WIRE IN THE CONNECTION BOX AND MAKE ALL NECESSARY CONNECTIONS (SEE WIRING DIAGRAM BELOW).

A+B

BRANCH CIRCUIT CONNECTIONS TRIAC/ELV (LTE) AND 0-10V (D10)

DIMMING CONNECTIONS 0-10V (D10)

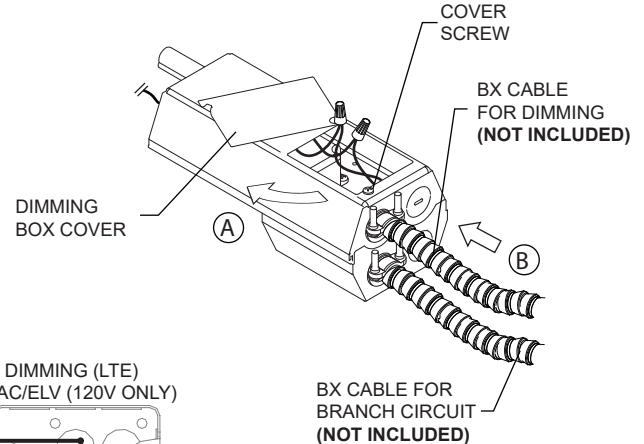
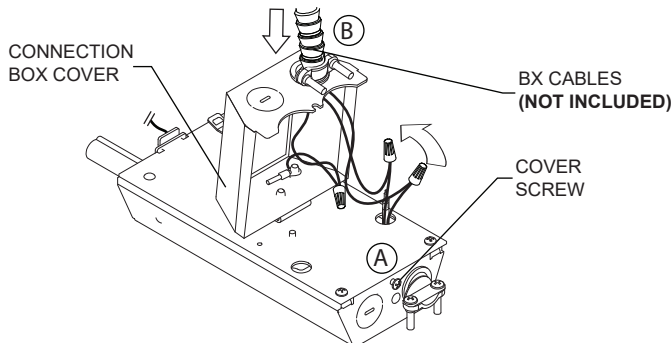

WIRING DIAGRAM

LIVE	BLACK
NEUTRAL	WHITE
⏏	GREEN
DIM +	PURPLE
DIM -	GRAY OR PINK

*junction box for reference only

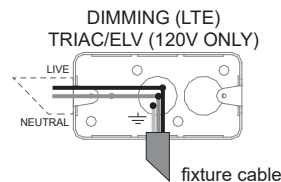
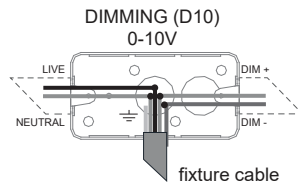

C- CLOSE THE CONNECTION BOX COVER OR DIMMING BOX COVER AND FASTEN WITH THE COVER SCREW.

D- PASS THE CABLE LOOP THROUGH THE ATTACHEMENT CLIP OF THE CONNECTION BOX.

E- INSERT THE CONNECTION BOX THROUGH THE CUT-OUT. THE CONNECTION BOX MUST SETTLE ON THE PLASTER FRAME/CEILING ONCE INSTALLED.

C

BRANCH CONNECTIONS TRIAC/ELV (LTE) AND 0-10V (D10)

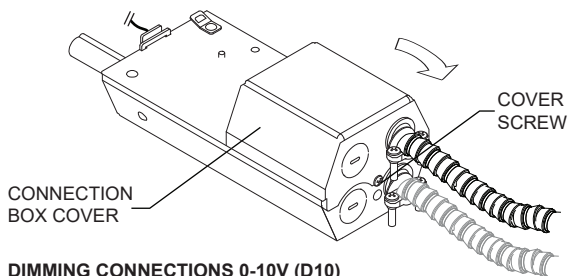

DIMMING CONNECTIONS 0-10V (D10)

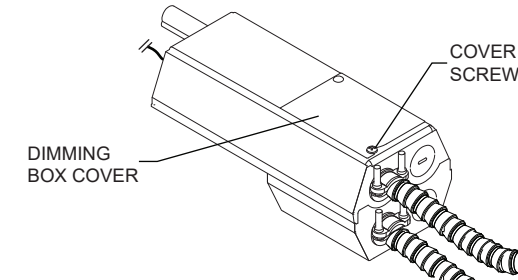

D+E

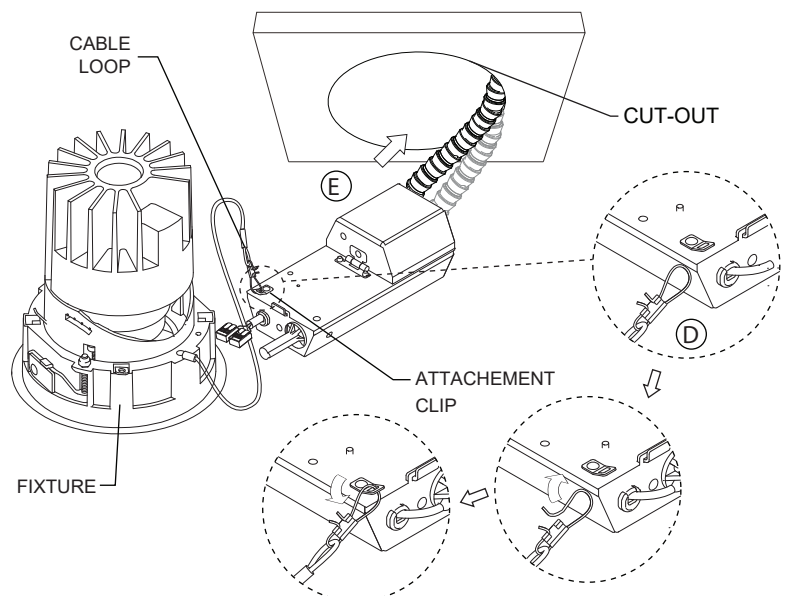

F- REMOVE THE BAFFLE FROM THE FIXTURE.

G- CONNECT FIXTURE.

H- PLACE FIXATION BRACKET TABS TO THE DESIRED POSITION DEPENDING ON CEILING THICKNESS.

I- INSERT FIXTURE THROUGH CUT-OUT.

F+G

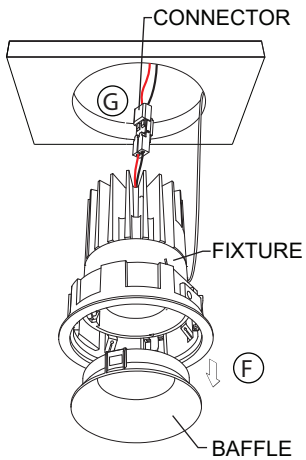

H+I

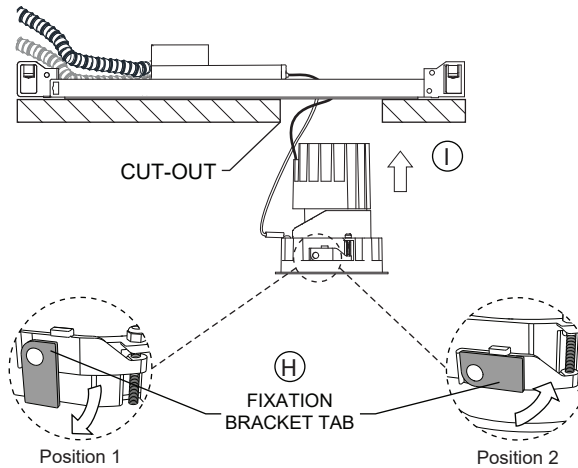

CEILING THICKNESS MIN-MAX		
ITEM	POSITION 1	POSITION 2
LOG4	1/8" - 3/8" (3mm - 10mm)	3/8" - 7/8" (10mm - 22mm)
LOG5	1/8" - 3/4" (3mm - 19mm)	1/2" - 1 1/4" (13mm - 32mm)
LOG6	1/8" - 7/8" (3mm - 22mm)	1/2" - 1 3/4" (13mm - 35mm)

J- TIGHTEN THE FIXTURE IN THE CUT-OUT. MAKE SURE THE FIXATION BRACKETS ARE OPEN FOR PROPER INSTALLATION.

FOR ADJUSTABLE MODELS ONLY: TO ADJUST THE TILT ANGLE, USE THE TILT ADJUSTMENT SCREW IN THE FIXTURE.

K- REPLACE THE BAFFLE.

J

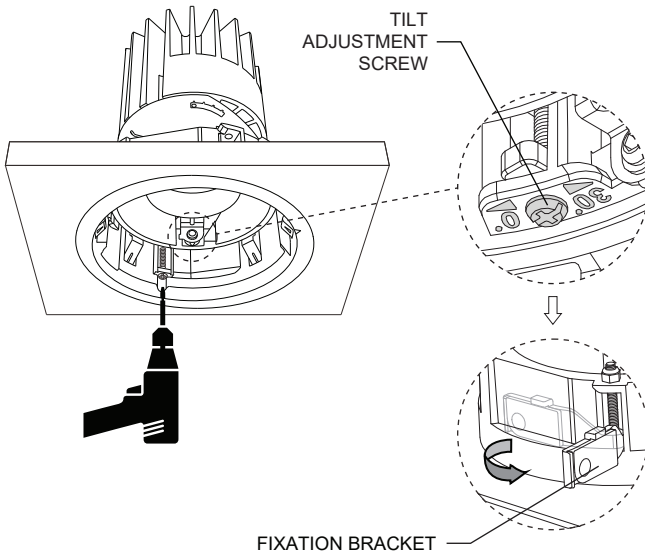

K

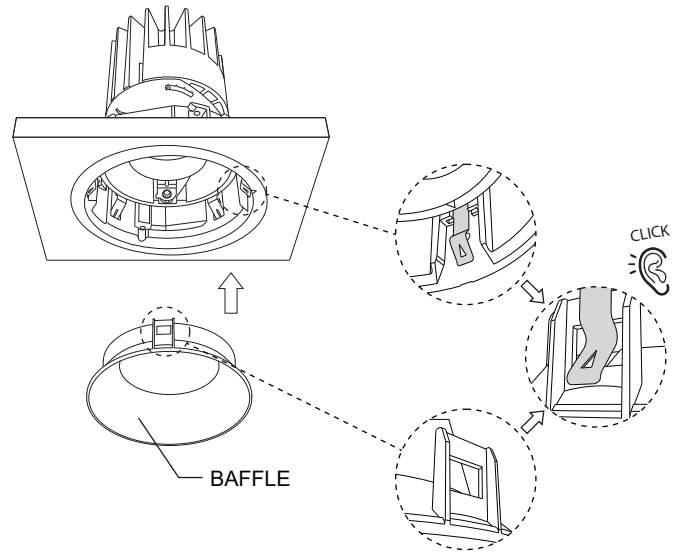

RECOMMENDED LINE DIMMERS LIST

DIMMERS LIST RECOMMANDATION	
Manufacturer	Model
LUTRON DIVA	DVSTV-WH
LUTRON POWERPAK	RMJ-ECO32-DV-B