

**IMPORTANT** - READ CAREFULLY BEFORE INSTALLING UNIT. RETAIN THESE INSTRUCTIONS FOR FUTURE REFERENCE.

THIS PRODUCT MUST BE INSTALLED IN ACCORDANCE WITH THE NATIONAL ELECTRICAL CODE AND ALL APPLICABLE LOCAL CODES, BY A PERSON FAMILIAR WITH THE CONSTRUCTION AND OPERATION OF THE PRODUCT, AND THE HAZARDS INVOLVED. PROPER GROUNDING IS REQUIRED FOR SAFETY.

### START UNIT INSTALLATION

**INTEGRAL DRIVER (120 / 277V)**

**DIMMING TRIAC/ELV OR 0-10V (15%), LUTRON HI-LUME® (1% EcoSystem™ / 1% 2-WIRE)**

A- PREPARE THE CEILING WITH ANCHOR SCREWS (**SEE ANCHOR DISTANCE ON P.4**). **DETAIL 1:**

- 1- PASS THE SCREW THROUGH THE THREADED RING AND SECURE IT INTO THE PLASTIC ANCHOR SCREW.
- 2- PASS THE SUSPENSION CABLE THROUGH THE MOUNTING COUPLING.
- 3- FASTEN THE MOUNTING COUPLING TO THE THREADED RING.

B- FIX THE SUSPENSION CABLE TO THE UNIT (**SEE DETAIL 2 ON P.2**).

C- INSTALL THE CANOPY AND MAKE THE NECESSARY WIRE CONNECTIONS IN A JUNCTION BOX (**SEE DETAIL 3 ON P.3**).

A + B + C

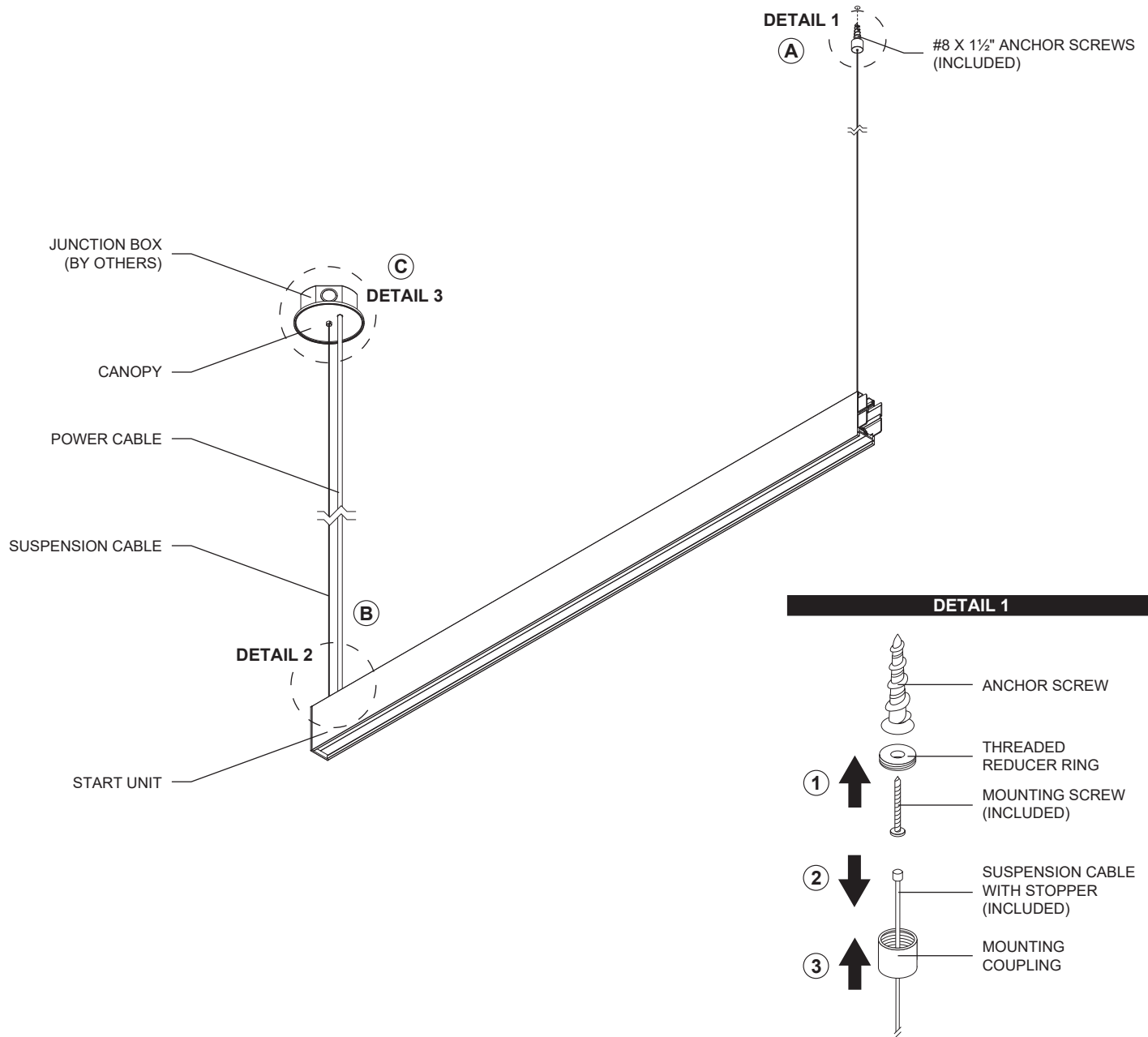

## DETAIL 2 - MECHANICAL ASSEMBLY

**NOTICE: IDENTIFY UNITS WITH 2 MOUNTING CLIPS. THESE SUSPENDED UNITS HAVE TO BE THE FIRST INSTALLED.**

- A- REMOVE THE ALUMINUM U-SHAPE COVER AND THE DIFFUSER / COVER PLATE (IF NECESSARY).
- B- UNFASTEN THE CABLE GRIPPER SECURITY NUT TO RELEASE THE CABLE GRIPPING SYSTEM. DO NOT COMPLETELY REMOVE THE NUT.
- C- LIFT THE UNIT TO THE SUSPENSION CABLE AND INSERT THE SUSPENSION CABLE THROUGH THE CABLE GRIPPER.
- D- SET THE UNIT TO THE APPROPRIATE HEIGHT AND FASTEN THE CABLE GRIPPER.
- E- CUT THE EXCESS SUSPENSION CABLE END.
- F- SNAP THE COVER PLATE / DIFFUSER AND THE U-SHAPE COVER BACK ON. BOTH THE SUSPENSION CABLE AND POWER CABLE MUST GO THROUGH THE U-TYPE OPENING.

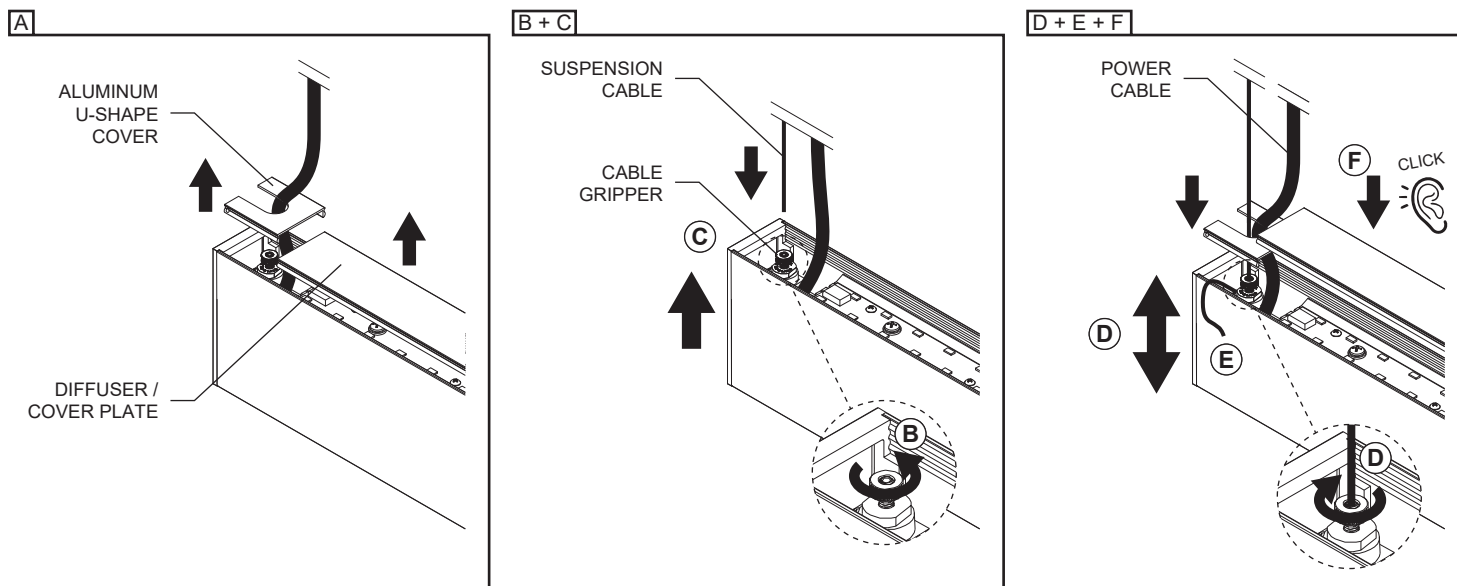

### DETAIL 3 - CANOPY INSTALLATION

- A- RUN THE POWER CABLE THROUGH THE CANOPY AND THROUGH THE MOUNTING CROSSBAR HOLE. ADJUST THE CABLE LENGTH AND SECURE IT USING THE CABLE GRIPPER TO LOCK IT'S POSITION AGAINST THE MOUNTING CROSSBAR.
- B- MAKE THE NECESSARY WIRE CONNECTIONS (**SEE WIRING DIAGRAM**) USING TWIST CONNECTORS (**NOT INCLUDED**).  
FOR DIMMING 0-10V: WIRES MUST BE RUN THROUGH A SEPARATE KNOCKOUT HOLE WHEN CONNECTING THE DIMMING CONTROLLER.
- C- INSTALL THE MOUNTING CROSSBAR USING (2) PHILLIPS SCREWS (**INCLUDED**).
- D- PASS THE THUMB SCREW INTO THE MOUNTING CROSSBAR KEY HOLE WITH IT'S LOCK WASHER ON TOP. HOLD THE SUSPENSION CABLE DOWN AT THE DESIRED POSITION AND SECURE IT WITH THE PROVIDED NUT.
- E- SECURE THE CANOPY BY SCREWING THE CANOPY'S DECORATIVE NUT ON THE MOUNTING CROSSBAR'S THUMB SCREW.

A + B + C + D + E

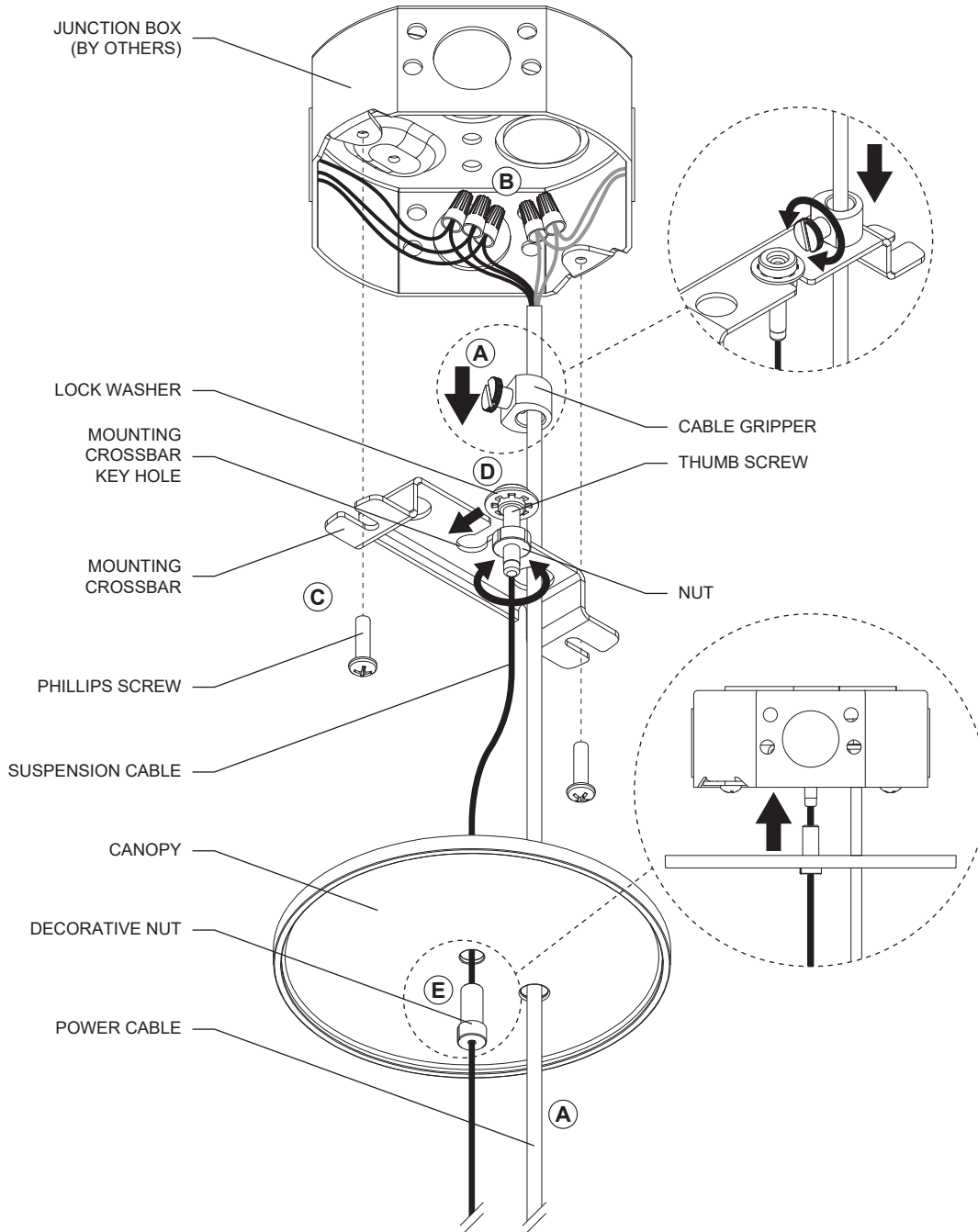

### WIRING DIAGRAM\*

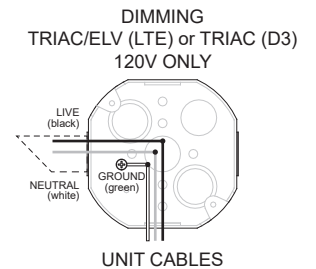
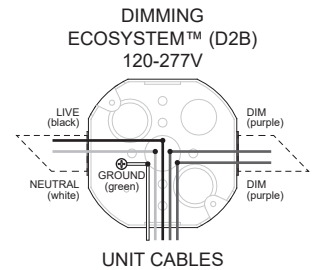
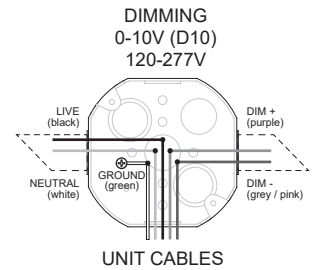

\*for reference only

## IN-LINE UNIT INSTALLATION (LENGTHS FROM 9' AND MORE)

- A- UNSNAP THE IN-LINE UNIT DIFFUSER, UNSCREW THE LED MODULE'S PHILLIPS SCREWS AND DISCONNECT THE QUICK CONNECTOR.  
 B- LIFT THE IN-LINE UNIT AND INSTALL THE SUSPENSION CABLE REPEATING PREVIOUS STEPS (SEE DETAIL 1 & 2 ON P.1-2).  
 C- ALIGN THE UNITS AND JOIN THEM TOGETHER BY TIGHTENING THE PRE-INSTALLED PHILLIPS SCREW ON THE JOINT ASSEMBLY A TO THE JOINT ASSEMBLY B. DO NOT OVERTIGHTEN AND MAKE SURE TO NOT SQUEEZE ANY CABLES.  
 D- MAKE THE NECESSARY CONNECTIONS USING THE QUICK CONNECTORS.  
 E- CONNECT THE LED MODULE'S QUICK CONNECTOR AND SNAP THE LED MODULE BACK INTO THE IN-LINE UNIT.  
 F- ADJUST THE IN-LINE UNIT'S HEIGHT TO MATCH THE PREVIOUS UNIT.

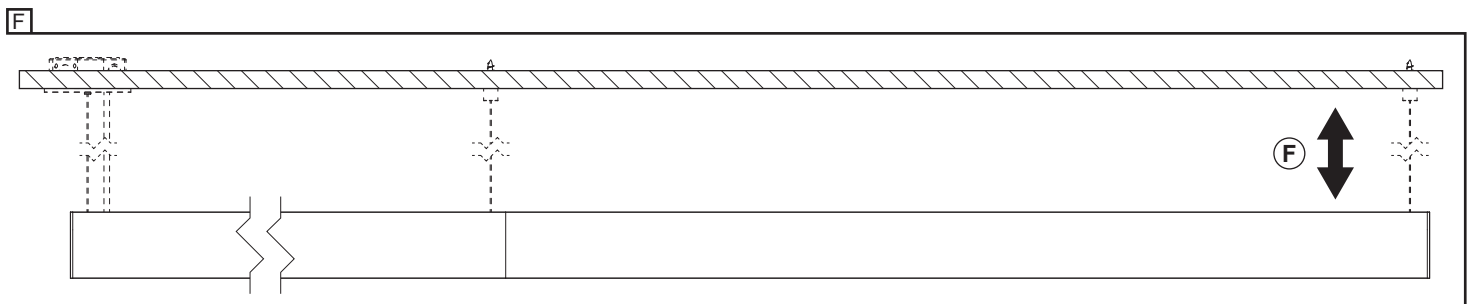
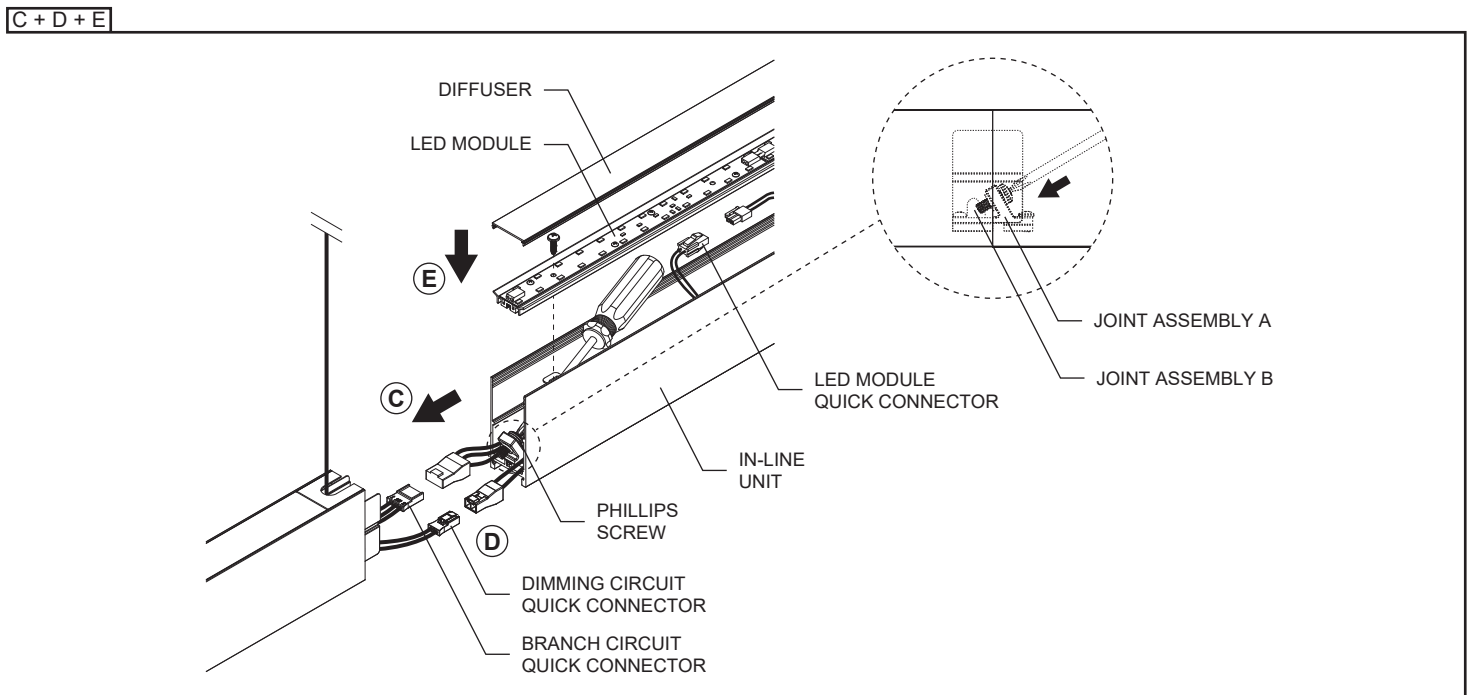
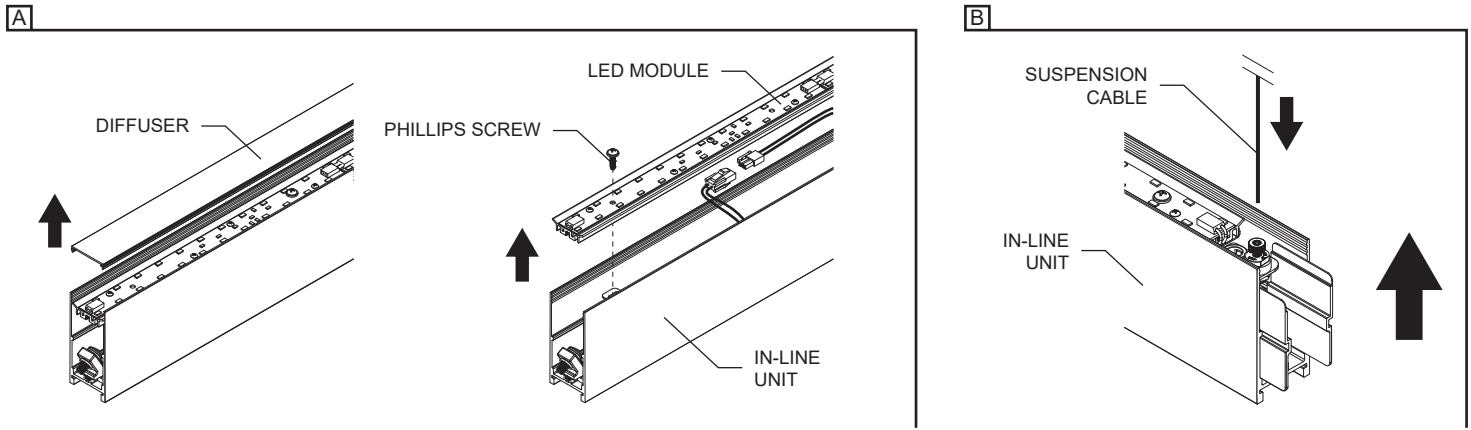

### PENDANT ANCHOR POINTS DISTANCE

#### IN-LINE SYSTEM

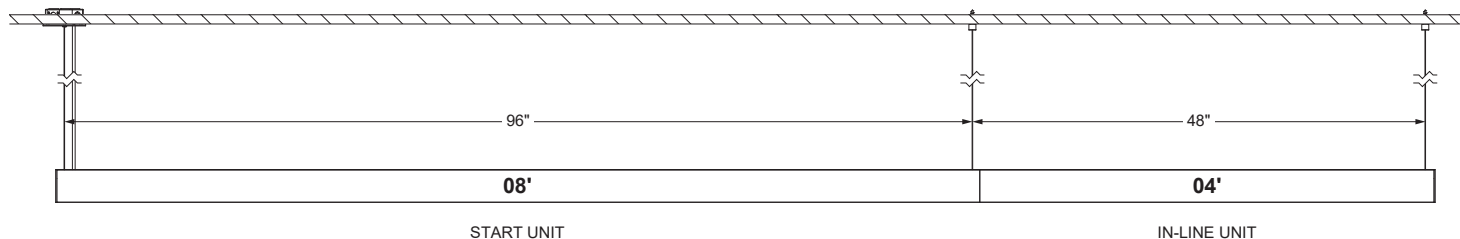

ANCHOR POINTS FOR LINEAR PENDANT MODEL 3720			
Nominal length	Actual length	Anchor distance	Feed quantity
<b>04'</b>	4'-1 $\frac{7}{8}$ " (1.265m)	48" (1.219m)	1
<b>08'</b>	8'-1 $\frac{7}{8}$ " (2.484m)	96" (2.438m)	
<b>12'</b>	12'-1 $\frac{7}{8}$ " (3.703m)	96" + 48" (2.438 + 1.219m)	
<b>16'</b>	16'-1 $\frac{7}{8}$ " (4.923m)	2 x 96" (2 x 2.438m)	
<b>24'</b>	24'-1 $\frac{7}{8}$ " (7.361m)	3 x 96" (3 x 2.438m)	
<b>32'</b>	32'-1 $\frac{7}{8}$ " (9.799m)	4 x 96" (4 x 2.438m)	
<b>48'</b>	48'-1 $\frac{7}{8}$ " (14.676m)	6 x 96" (6 x 2.438m)	
<b>64'</b>	64'-1 $\frac{7}{8}$ " (19.553m)	8 x 96" (8 x 2.438m)	2
<b>72'</b>	72'-1 $\frac{7}{8}$ " (21.991m)	9 x 96" (9 x 2.438m)	
<b>96'</b>	96'-1 $\frac{7}{8}$ " (29.307m)	12 x 96" (12 x 2.438m)	

Refer to the anchor guide document for full list of available lengths.

6A max per feed.