

IMPORTANT - READ CAREFULLY BEFORE INSTALLING FIXTURE. RETAIN THESE INSTRUCTIONS FOR FUTURE REFERENCE. THIS PRODUCT MUST BE INSTALLED IN ACCORDANCE WITH THE NATIONAL ELECTRICAL CODE AND ALL APPLICABLE LOCAL CODES, BY A PERSON FAMILIAR WITH THE CONSTRUCTION AND OPERATION OF THE PRODUCT, AND THE HAZARDS INVOLVED. PROPER GROUNDING IS REQUIRED FOR SAFETY.

INSTALLING PROJECTOR ON ONE CIRCUIT TRACK (120V)

FOR USE WITH **SISTEMALUX 8000 SERIES** TRACK SYSTEM ONLY (120V).

A - PUSH THE PROJECTOR INTO THE TRACK.

B- ROTATE THE TRACK ADAPTOR HOUSING A QUARTER TURN IN THE PROPER DIRECTION IN ORDER TO ALLOW ELECTRICAL BOUNDING. MAKE SURE THE ADAPTOR IS LOCKED IN PLACE WITH SPRING CLIP, FOLLOWING FINAL POSITION SHOWN BELOW.

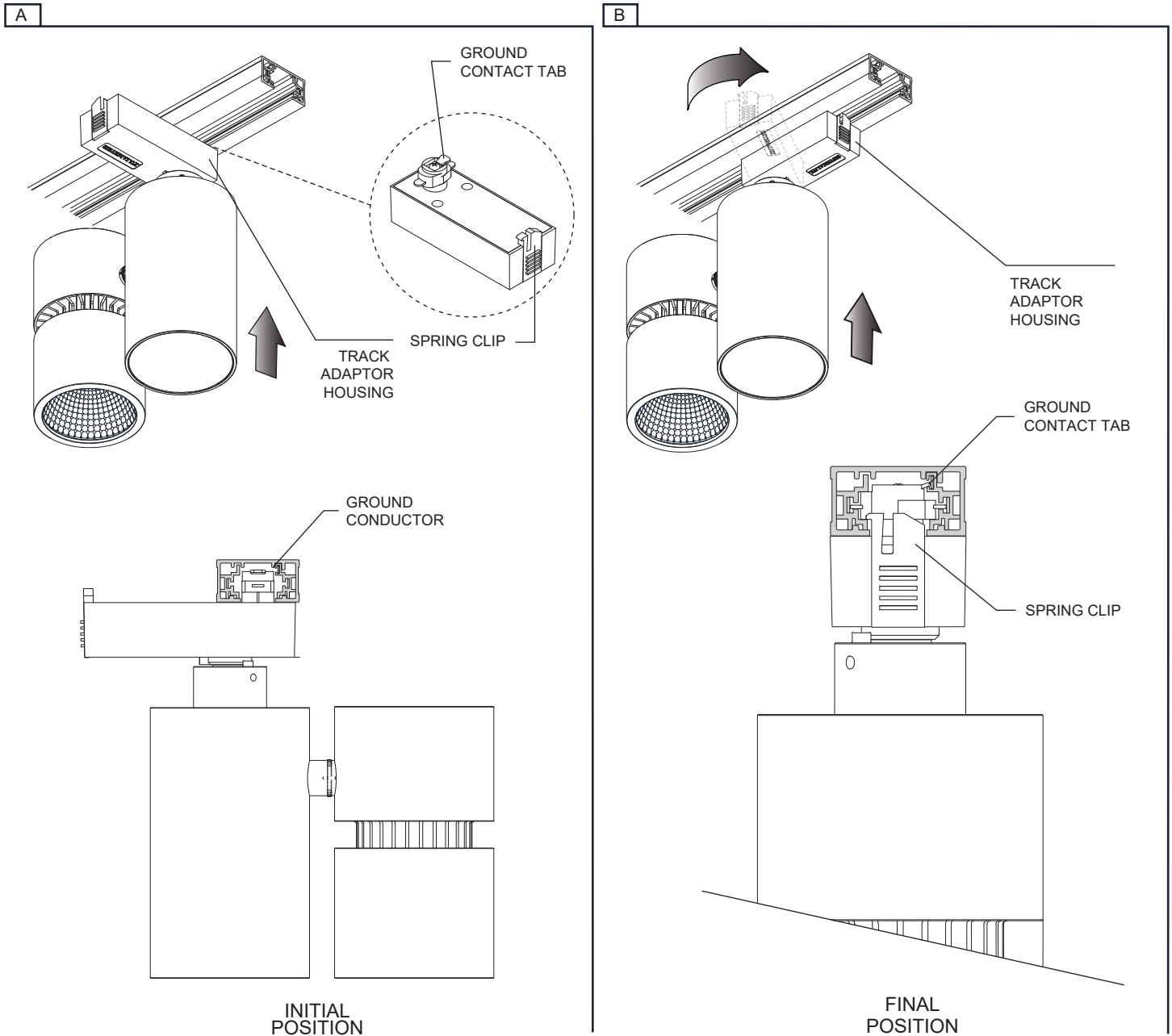

REMOVING PROJECTOR FROM TRACK

A- PULL DOWN THE SPRING CLIP TO UNLOCK IT FROM THE TRACK SLOT.

B- HOLDING THE TRACK ADAPTOR HOUSING AND SPRING CLIP DOWN, ROTATE A QUARTER TURN IN ANY DIRECTION AND PULL DOWN THE PROJECTOR TO REMOVE IT FROM THE TRACK.

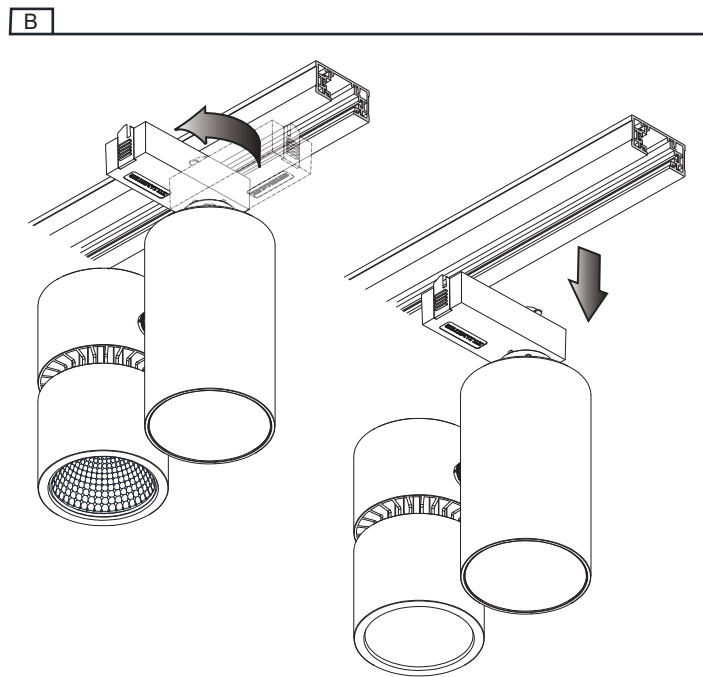
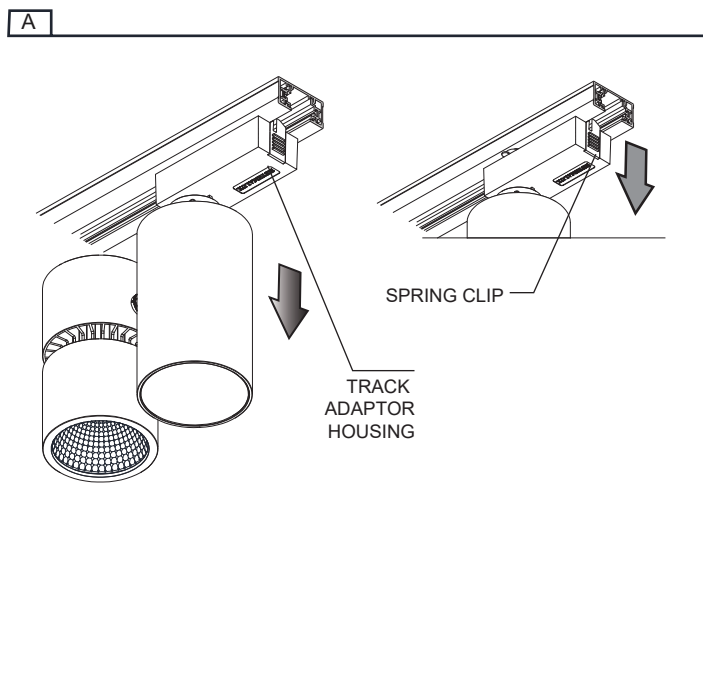

PAN ANGLE POSITION

A- LOOSEN THE PAN ADJUSTMENT LOCKING SCREW.

B- SET THE DESIRED PAN POSITION (MAXIMUM OF 330° AXIAL ROTATION) AND LOCK THE POSITION WITH THE PAN ADJUSTMENT LOCKING SCREW, USING A FLATHEAD SCREWDRIVER.

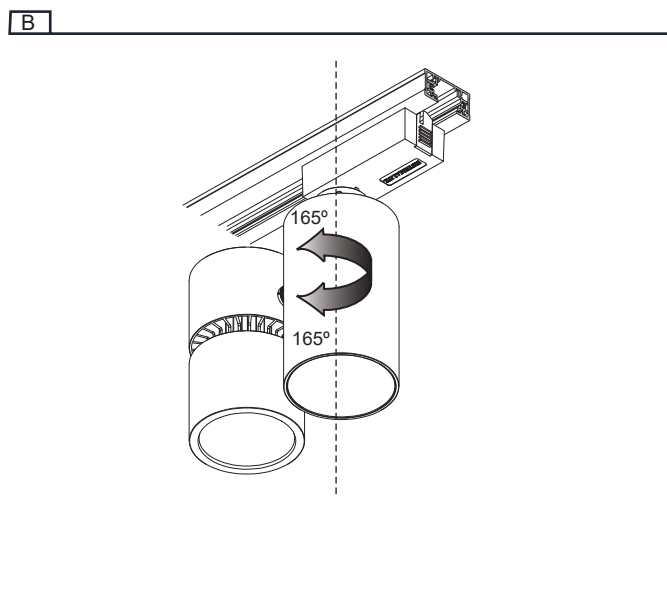
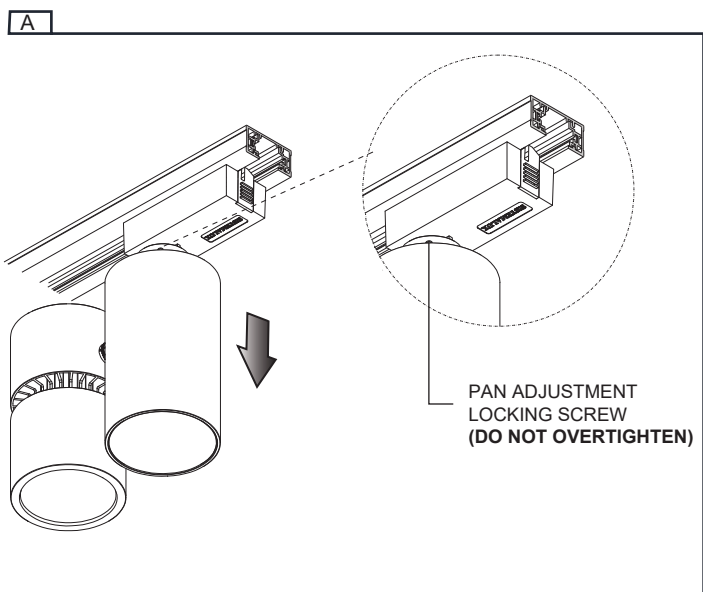

TILT ANGLE POSITION

- A- SET THE DESIRED TILT POSITION (MAXIMUM OF 90° AXIAL ROTATION) AND LOCK THE POSITION WITH THE
B- TILT ADJUSTMENT LOCKING SCREW, USING THE 5/64 ALLEN KEY PROVIDED.

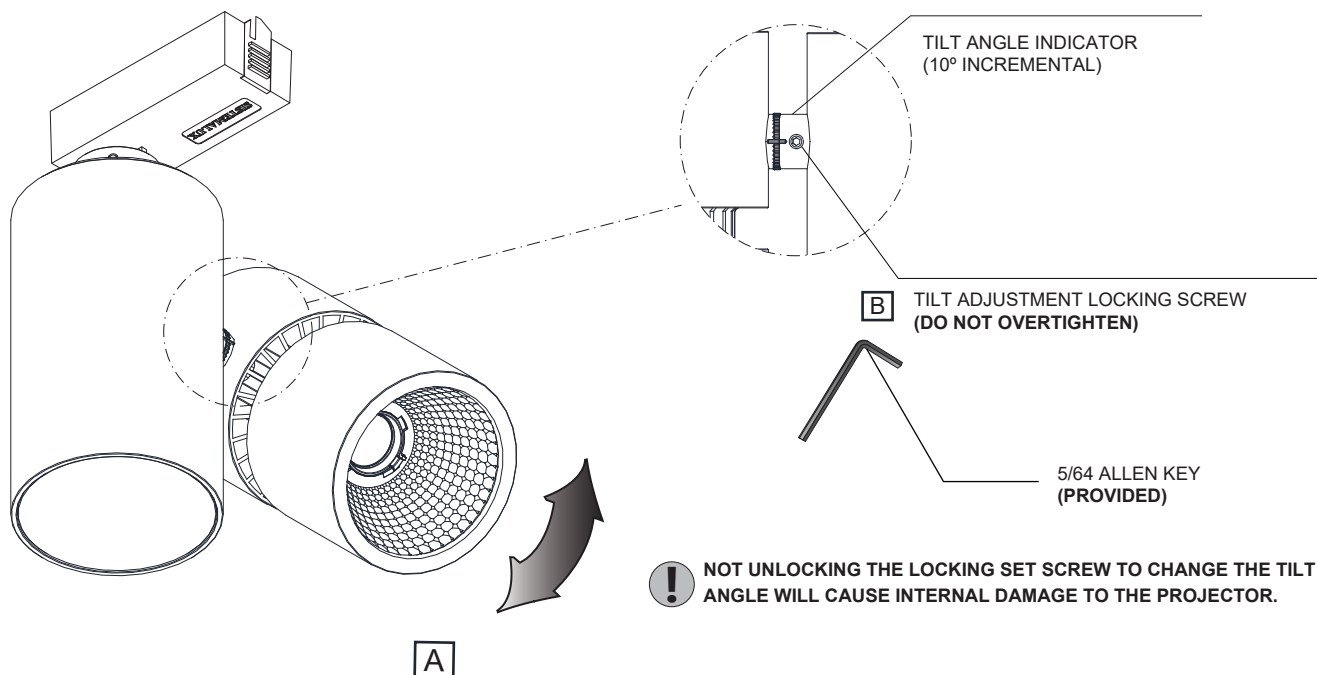

REPLACING OPTIC FOR REFLECTOR MODELS

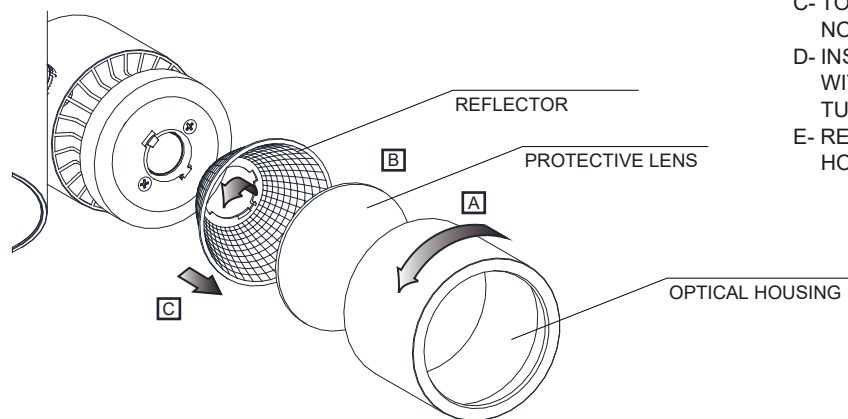

- A- REMOVE OPTICAL HOUSING BY ROTATING COUNTERCLOCKWISE.
B- LEAVE THE PROTECTIVE LENS IN THE OPTICAL HOUSING.
C- TO REMOVE THE REFLECTOR ROTATE TO ALIGN NOTCHES AND MOUNTING FINGERS AND PULL.
D- INSTALL NEW REFLECTOR BY ALIGNING NOTCHES WITH MOUNTING FINGERS AND ROTATE A QUARTER TURN CLOCKWISE.
E- RE-INSTALL THE PROTECTIVE LENS AND OPTICAL HOUSING TOGETHER BY ROTATING CLOCKWISE.

ACCESSORIES

A- TO REPLACE OR ADD AN ACCESSORY, REMOVE OPTICAL HOUSING BY ROTATING IT COUNTERCLOCKWISE.

B- INSERT ONE OR MORE ACCESSORIES INTO THE OPTIC HOUSING.

C- RE-INSTALL THE ACCESSORIES AND OPTICAL HOUSING TOGETHER BY ROTATING CLOCKWISE.

(A MAXIMUM OF 3 ACCESSORIES IN COMBINATION)

