

IMPORTANT - READ CAREFULLY BEFORE INSTALLING FIXTURE. RETAIN THESE INSTRUCTIONS FOR FUTURE REFERENCE. THIS PRODUCT MUST BE INSTALLED IN ACCORDANCE WITH THE NATIONAL ELECTRICAL CODE AND ALL APPLICABLE LOCAL CODES, BY A PERSON FAMILIAR WITH THE CONSTRUCTION AND OPERATION OF THE PRODUCT, AND THE HAZARDS INVOLVED. PROPER GROUNDING IS REQUIRED FOR SAFETY.

INSTALLING PROJECTOR ON ONE CIRCUIT TRACK (120V)

FOR USE WITH **SISTEMALUX 8000-S1 SERIES**, OR **SISTEMALUX 8000 SERIES** TRACK SYSTEM ONLY.

- A - PULL THE ADAPTOR HOUSING DOWN TO INSERT IN THE TRACK FOLLOWING INITIAL POSITION SHOWN BELOW.
B - PUSH THE PROJECTOR INTO TRACK AND ROTATE THE TRACK ADAPTOR A QUARTER TURN IN THE PROPER DIRECTION IN ORDER TO ALLOW ELECTRICAL BOUNDING. MAKE SURE THE ADAPTOR IS LOCKED IN PLACE, FOLLOWING FINAL POSITION SHOWN BELOW.

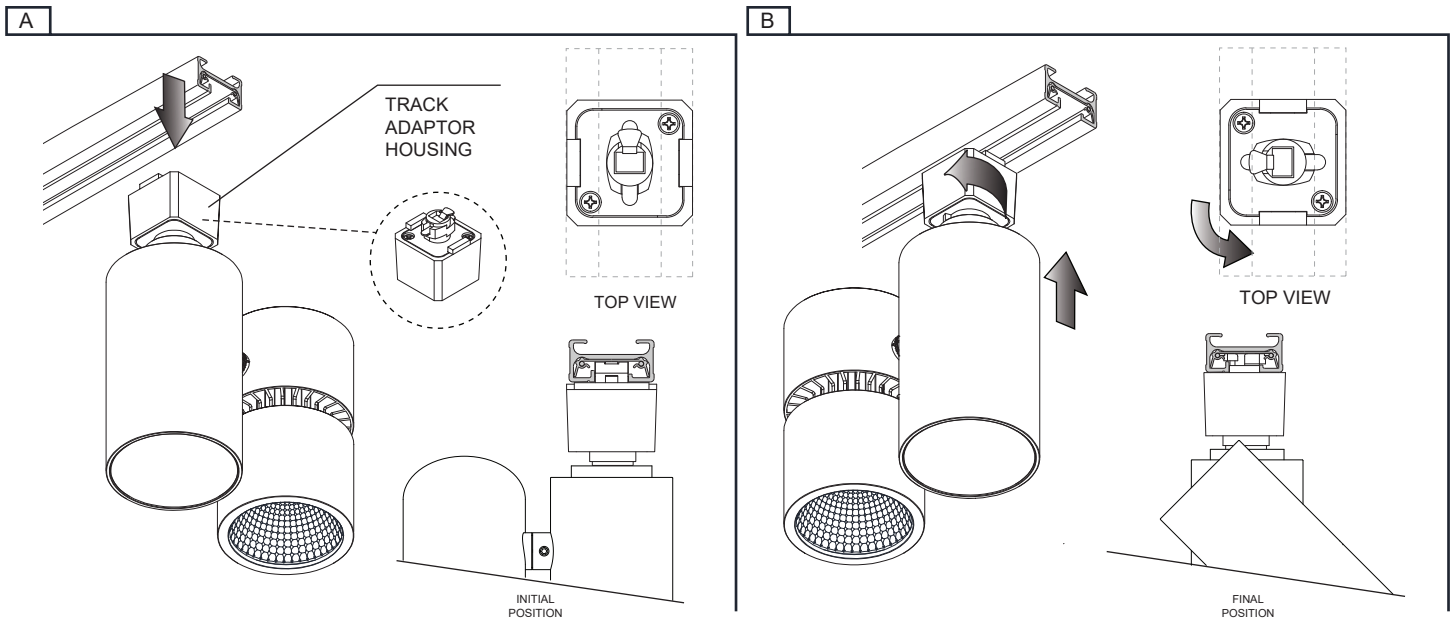

REMOVING PROJECTOR FROM TRACK

- A - PULL DOWN THE TRACK ADAPTOR HOUSING TO UNLOCK IT FROM THE TRACK SLOT.
B - HOLDING THE TRACK ADAPTOR HOUSING DOWN, ROTATE A QUARTER TURN IN ANY DIRECTION AND PULL DOWN THE PROJECTOR TO REMOVE IT FROM THE TRACK.

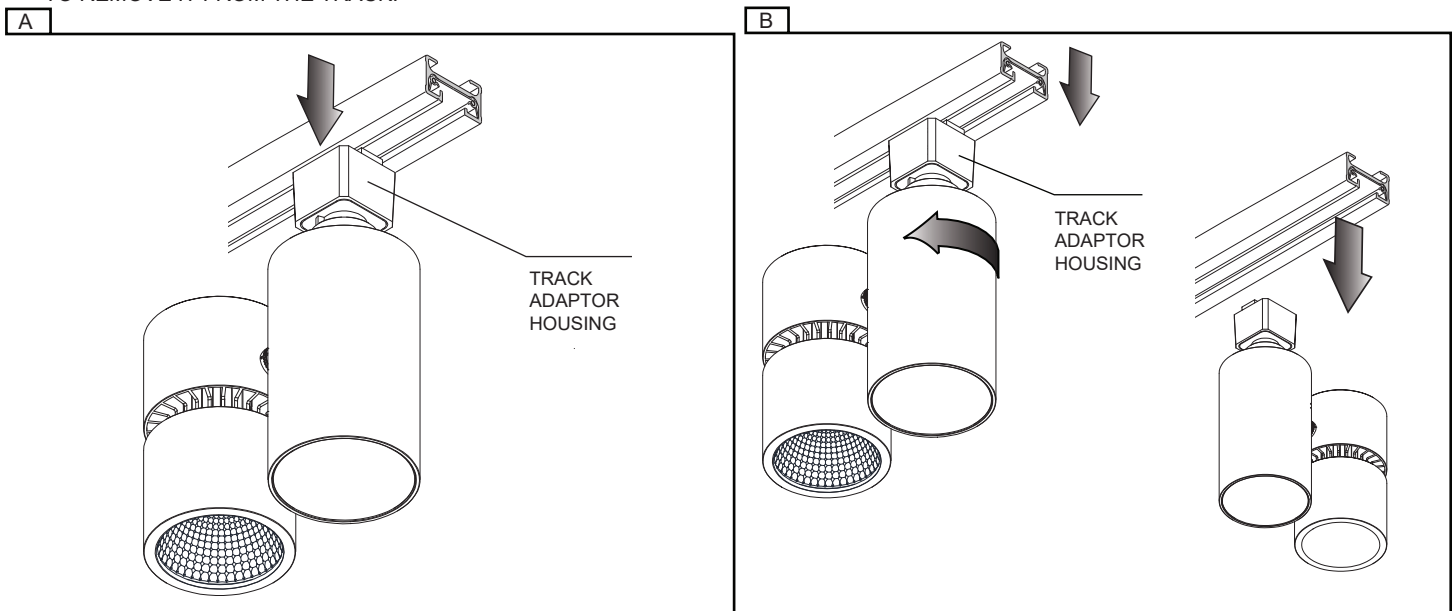

PAN ANGLE POSITION

SET THE DESIRED PAN POSITION (MAXIMUM OF 330° AXIAL ROTATION).

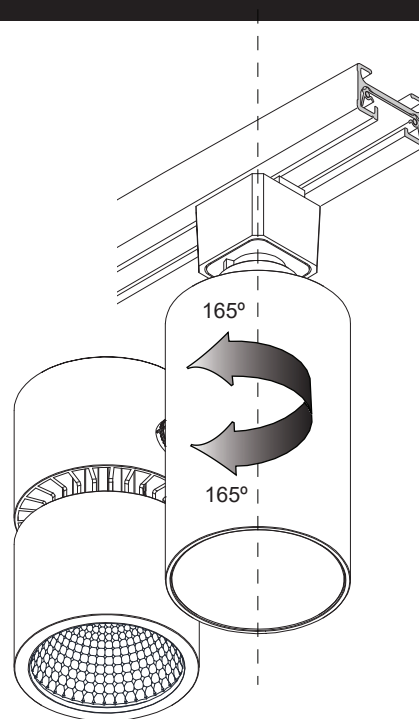
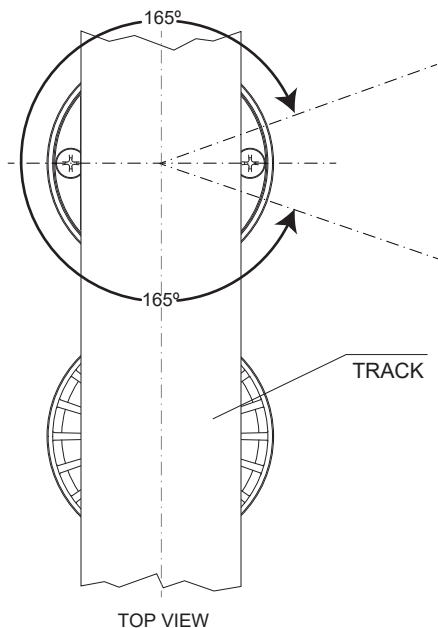

TILT ANGLE POSITION

A- SET THE DESIRED TILT POSITION (MAXIMUM OF 90° AXIAL ROTATION) AND LOCK THE POSITION WITH THE
B- TILT ADJUSTMENT LOCKING SCREW, USING THE 5/64 ALLEN KEY PROVIDED.

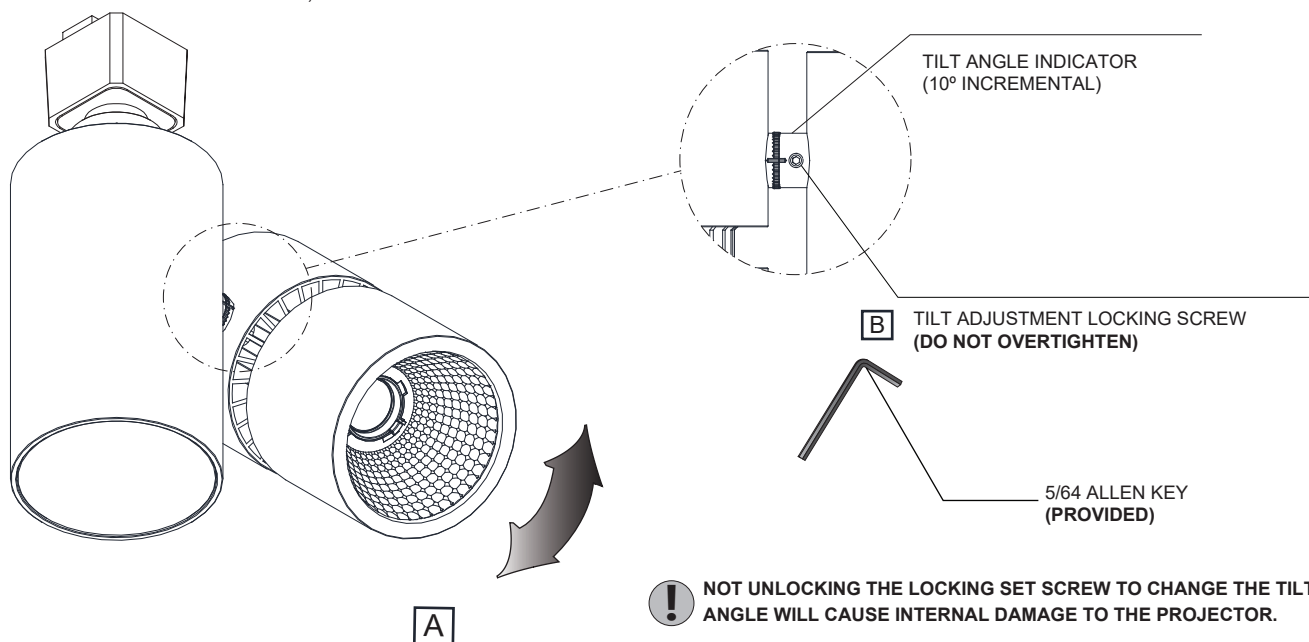

REPLACING OPTIC FOR REFLECTOR MODELS

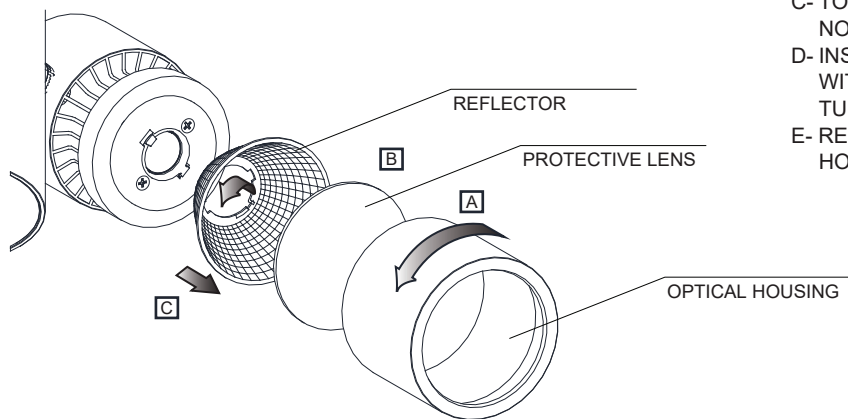

- A- REMOVE OPTICAL HOUSING BY ROTATING COUNTERCLOCKWISE.
- B- LEAVE THE PROTECTIVE LENS IN THE OPTICAL HOUSING.
- C- TO REMOVE THE REFLECTOR ROTATE TO ALIGN NOTCHES AND MOUNTING FINGERS AND PULL.
- D- INSTALL NEW REFLECTOR BY ALIGNING NOTCHES WITH MOUNTING FINGERS AND ROTATE A QUARTER TURN CLOCKWISE.
- E- RE-INSTALL THE PROTECTIVE LENS AND OPTICAL HOUSING TOGETHER BY ROTATING CLOCKWISE.

ACCESSORIES

- A- TO REPLACE OR ADD AN ACCESSORY, REMOVE OPTICAL HOUSING BY ROTATING IT COUNTERCLOCKWISE.
- B- INSERT ONE OR MORE ACCESSORIES INTO THE OPTIC HOUSING.
- C- RE-INSTALL THE ACCESSORIES AND OPTICAL HOUSING TOGETHER BY ROTATING CLOCKWISE.
(A MAXIMUM OF 3 ACCESSORIES IN COMBINATION)

