

IMPORTANT - READ CAREFULLY BEFORE INSTALLING FIXTURE. RETAIN THESE INSTRUCTIONS FOR FUTURE REFERENCE.
THIS PRODUCT MUST BE INSTALLED IN ACCORDANCE WITH THE NATIONAL ELECTRICAL CODE AND ALL APPLICABLE LOCAL CODES, BY A PERSON FAMILIAR WITH THE CONSTRUCTION AND OPERATION OF THE PRODUCT, AND THE HAZARDS INVOLVED. PROPER GROUNDING IS REQUIRED FOR SAFETY.

INSTALLING PROJECTOR WITH CANOPY ON CEILING OR WALL (120V-277V)

FOR USE WITH STANDARD 4" JUNCTION BOX (120V-277V)

- A- RAISE TO CEILING OR MOUNT ON WALL THE PROJECTOR AND MAKE ALL NECESSARY CONNECTIONS.
B- FASTEN CANOPY PROJECTOR ON JUNCTION BOX USING THE TWO PHILLIPS HEAD SCREWS PROVIDED.

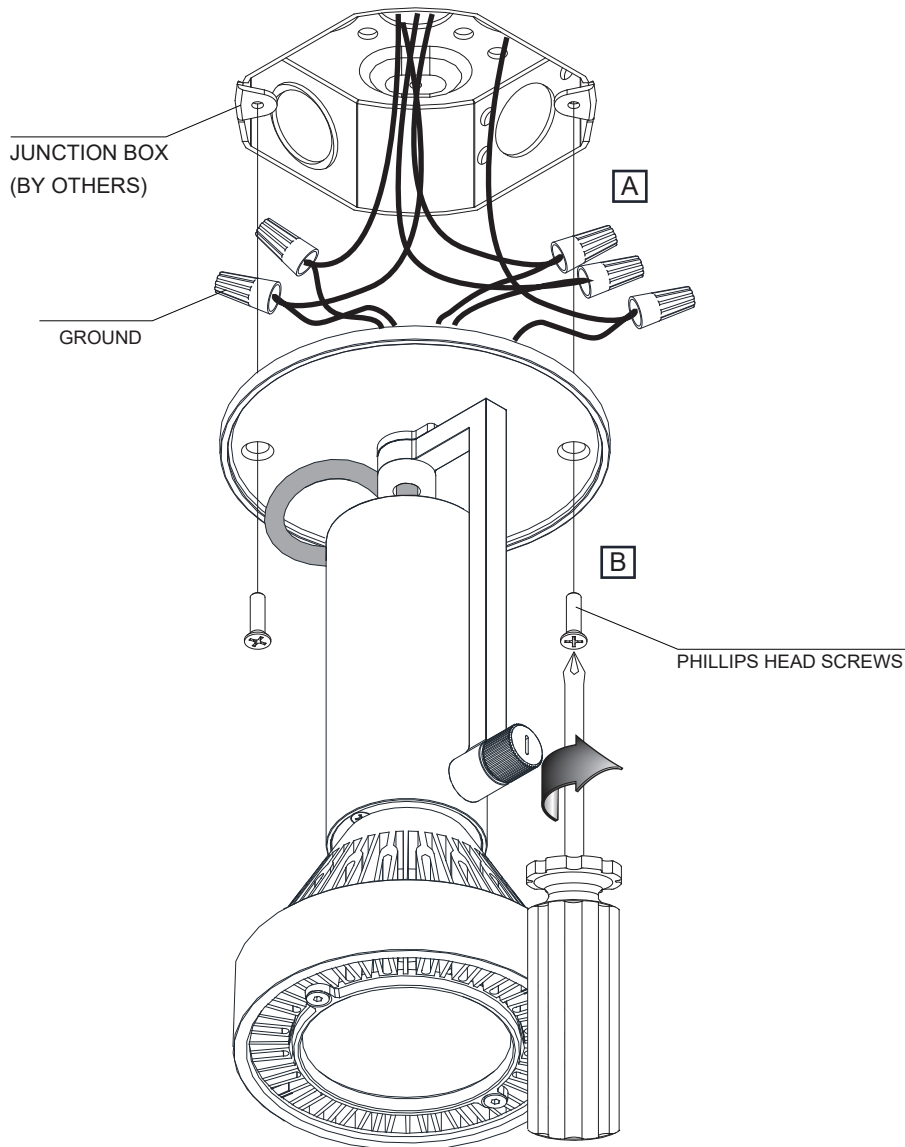

| | |
|----------|---------------|
| LIVE | BLACK |
| NEUTRAL | WHITE |
| \equiv | GREEN |
| DIM + | PURPLE or RED |
| DIM - | GRAY or BLUE |

NO DIMMING (120-277V)
OR
DIMMING TRIAC/ELV (120V ONLY)
(LTE)

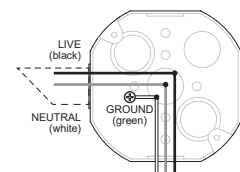

FIXTURE CABLES

DIMMING 0-10V
(120-277V)
(D10)

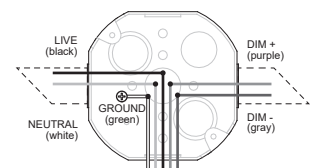

FIXTURE CABLES

PAN ANGLE POSITION

A- ADJUST THE DESIRED PAN POSITION. (MAXIMUM OF 330° AXIAL ROTATION)

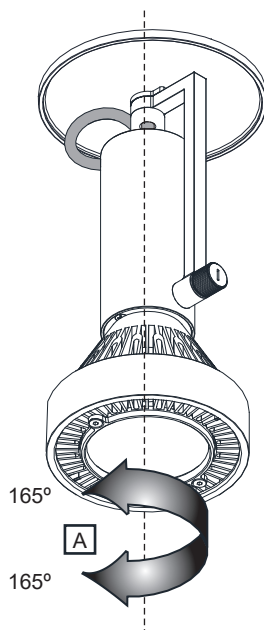

TILT ANGLE POSITION

A- ADJUST THE DESIRED POSITION AND LOCK WITH THE LOCKING THUMB SCREW. YOU CAN USE A SLOT SCREW DRIVER FOR AN EVEN BETTER TIGHT ADJUSTMENT. (MAXIMUM OF 270° AXIAL ROTATION)

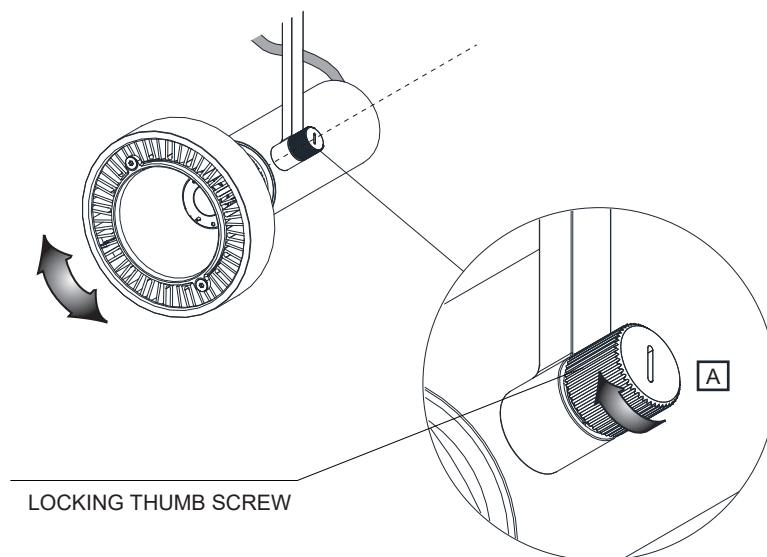

REPLACING OPTIC FOR REFLECTOR MODELS

- A- UNSCREW THE TWO ALLEN KEY SCREWS TO REMOVE THE OPTIC HOLDER.
B- INSERT THE LENS OR THE LOUVER IN THE O-RING.
C- INSERT AND RE-INSTALL THE OPTIC HOLDER BACK IN PLACE.

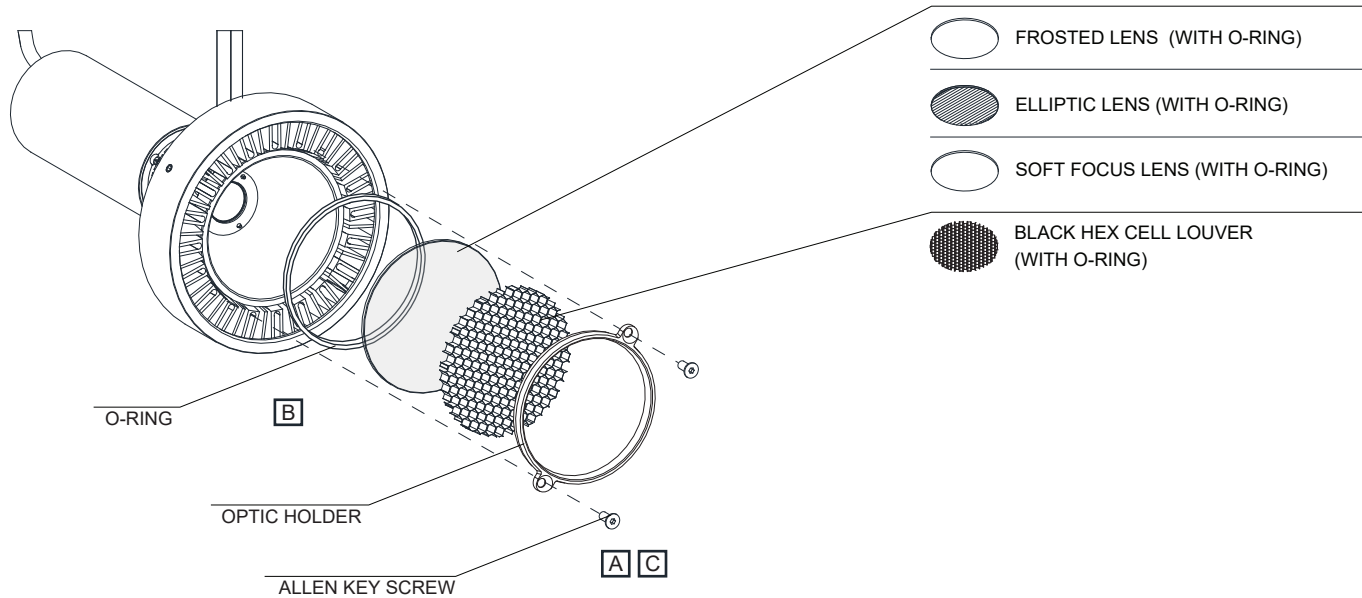

ACCESSORIES (MAXIMUM OF TWO ACCESSORIES IN COMBINATION, REFLECTORS DO NOT COUNT AS ACCESSORY)

- A- UNSCREW THE TWO ALLEN KEY SCREWS TO REMOVE THE OPTIC HOLDER.
B- REPLACE THE REFLECTOR OR INSERT ACCESSORY AND RE-INSTALL THE OPTICAL HOLDER BACK IN PLACE.

