

IMPORTANT - READ CAREFULLY BEFORE INSTALLING FIXTURE. RETAIN THESE INSTRUCTIONS FOR FUTURE REFERENCE.
THIS PRODUCT MUST BE INSTALLED IN ACCORDANCE WITH THE NATIONAL ELECTRICAL CODE AND ALL APPLICABLE LOCAL CODES, BY A PERSON FAMILIAR WITH THE CONSTRUCTION AND OPERATION OF THE PRODUCT, AND THE HAZARDS INVOLVED. PROPER GROUNDING IS REQUIRED FOR SAFETY.

INSTALLING PROJECTOR ON ONE CIRCUIT TRACK (120V)

FOR USE WITH **JUNO'S T SERIES** TRACK SYSTEM ONLY (120V)

- A - PULL THE ADAPTOR HOUSING DOWN TO INSERT IN THE TRACK FOLLOWING INITIAL POSITION SHOWN BELOW.
B - PUSH THE PROJECTOR INTO TRACK AND ROTATE THE TRACK ADAPTOR A QUARTER TURN IN THE PROPER DIRECTION IN ORDER TO ALLOW ELECTRICAL BOUNDING. MAKE SURE THE ADAPTOR IS LOCKED IN PLACE, FOLLOWING FINAL POSITION SHOWN BELOW.

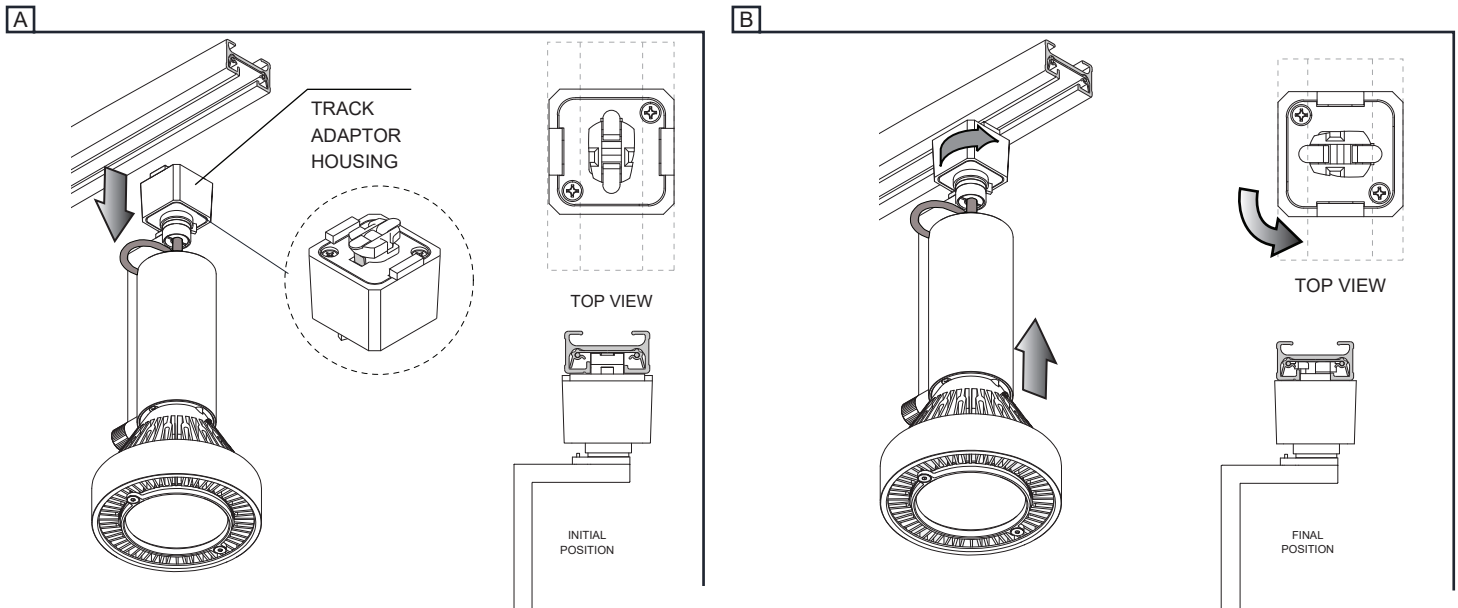

REMOVING PROJECTOR FROM TRACK

- A - PULL DOWN THE TRACK ADAPTOR HOUSING TO UNLOCK IT FROM THE TRACK SLOT.
B - HOLDING THE TRACK ADAPTOR HOUSING DOWN, ROTATE A QUARTER TURN IN ANY DIRECTION AND PULL DOWN THE PROJECTOR TO REMOVE IT FROM THE TRACK.

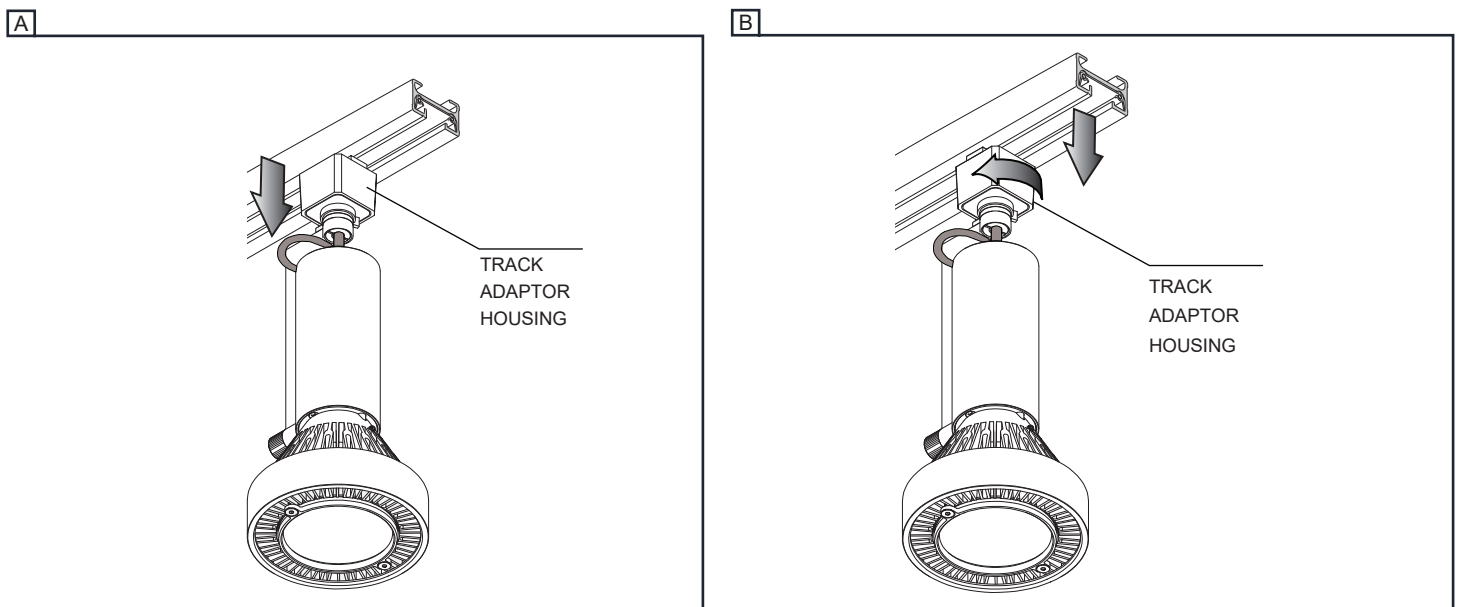

PAN ANGLE POSITION

A- ADJUST THE DESIRED PAN POSITION. (MAXIMUM OF 330° AXIAL ROTATION)

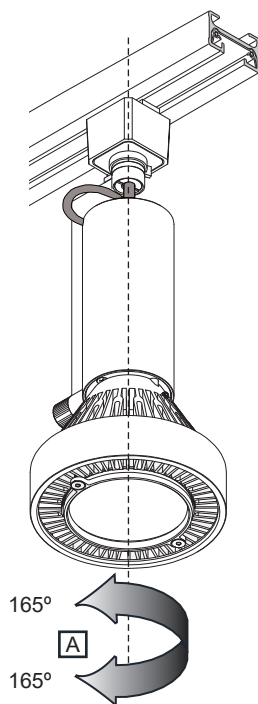

TILT ANGLE POSITION

A- ADJUST THE DESIRED POSITION AND LOCK WITH THE LOCKING THUMB SCREW. YOU CAN USE A SLOT SCREW DRIVER FOR AN EVEN BETTER TIGHT ADJUSTMENT. (MAXIMUM OF 270° AXIAL ROTATION)

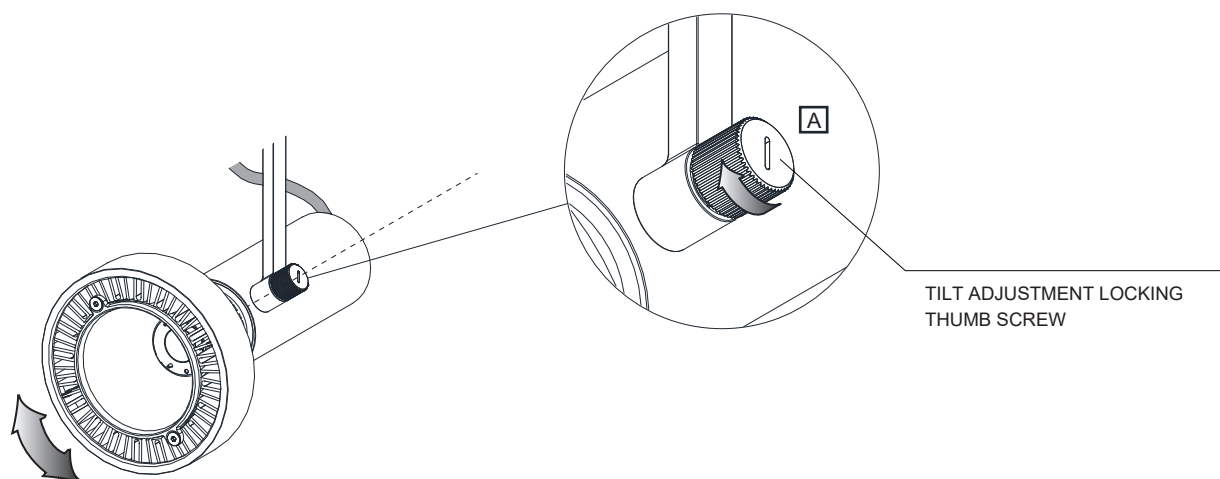

REPLACING OPTIC

- A- UNSCREW THE TWO ALLEN KEY SCREWS TO REMOVE THE OPTIC HOLDER.
B- INSERT THE LENS OR THE LOUVER IN THE O-RING.
C- INSERT AND RE-INSTALL THE OPTIC HOLDER BACK IN PLACE.

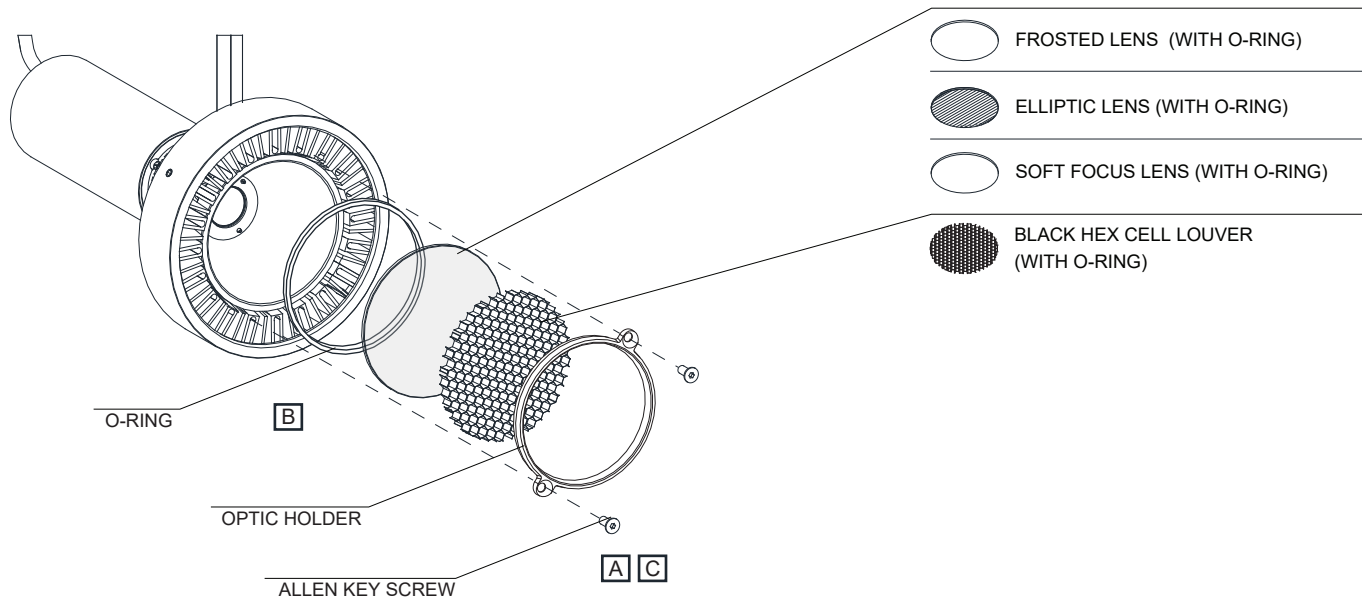

ACCESSORIES (MAXIMUM OF TWO ACCESSORIES IN COMBINATION, REFLECTORS DO NOT COUNT AS ACCESSORY)

- A- UNSCREW THE TWO ALLEN KEY SCREWS TO REMOVE THE OPTIC HOLDER.
B- REPLACE THE REFLECTOR OR INSERT ACCESSORY AND RE-INSTALL THE OPTICAL HOLDER BACK IN PLACE.

