

**IMPORTANT** - READ CAREFULLY BEFORE INSTALLING FIXTURE. RETAIN THESE INSTRUCTIONS FOR FUTURE REFERENCE.

THIS PRODUCT MUST BE INSTALLED IN ACCORDANCE WITH THE NATIONAL ELECTRICAL CODE AND ALL APPLICABLE LOCAL CODES, BY A PERSON FAMILIAR WITH THE CONSTRUCTION AND OPERATION OF THE PRODUCT, AND THE HAZARDS INVOLVED. PROPER GROUNDING IS REQUIRED FOR SAFETY.

**⚠ DISCONNECT THE MAIN LINE BEFORE WIRING SECONDARY CONNECTORS.**

## TRIM NEW CONSTRUCTION HOUSING INSTALLATION (IC / CP / AT) INTEGRAL DRIVER (120V / 120-277V) DIMMING TRIAC/ELV OR 0-10V (15%)

- A- CONNECT THE QUICK CONNECTORS COMING FROM THE CEILING HOUSING. (1 CONNECTOR FOR LTE DIMMING, 2 FOR 0-10V DIMMING.)
- B- INSERT THE LED DRIVER HOUSING THROUGH THE CUT-OUT INTO THE CEILING.
- C- CONNECT THE FIXTURE TO THE LED DRIVER HOUSING USING THE QUICK CONNECTORS.
- D- **ROUND MODEL:** BEND AND HOLD THE SPRINGS AGAINST THE FIXTURE BODY AND ROTATE IN THE SPECIFIED DIRECTION (SEE BELOW) WHILE PUSHING UPWARD TO INSERT THE FIXTURE INTO THE CEILING.
- D- **SQUARE MODEL:** INSERT THE FIXTURE INTO THE CEILING. TO SECURE THE FIXTURE INSIDE THE HOUSING, SCREW THE (2) FIXATION BRACKET ADJUSTMENT SCREWS WITH A DRILL (RECOMMENDED). THE BRACKETS WILL OPEN AUTOMATICALLY WHILE SCREWING.

A + B + C

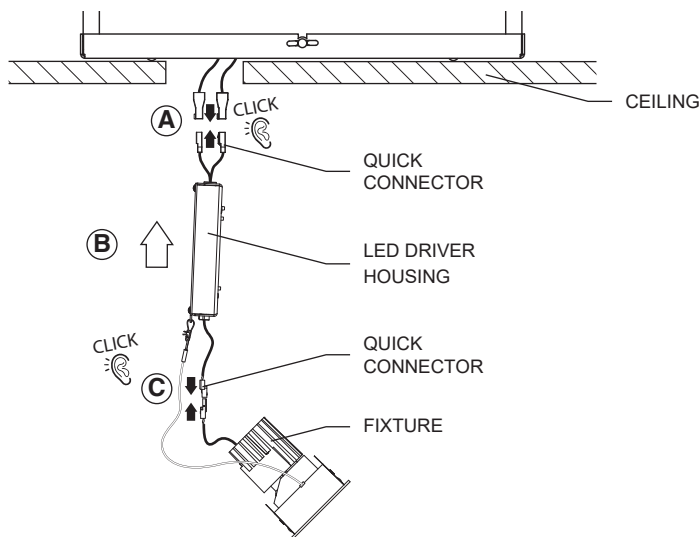

### D ROUND MODEL

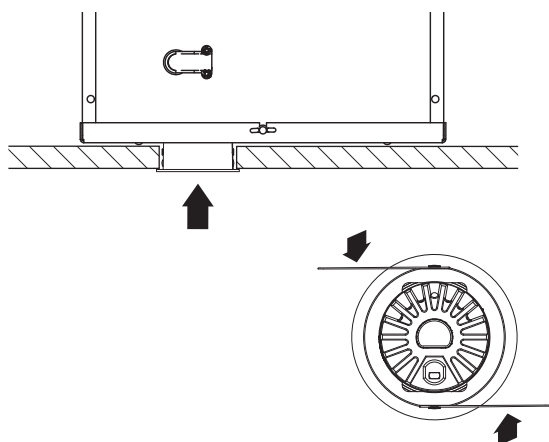

### D SQUARE MODEL

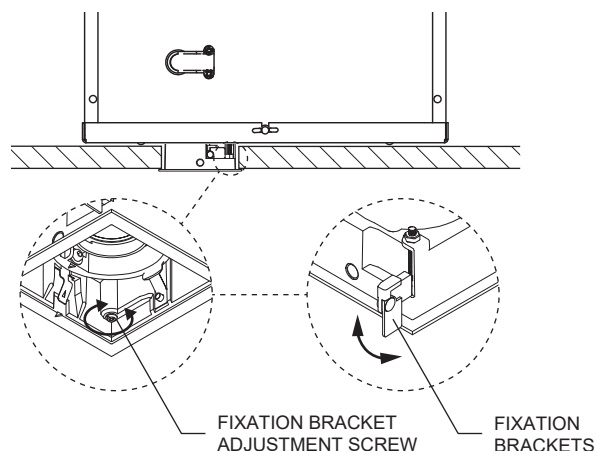

## TRIMLESS - NEW CONSTRUCTION WITH HOUSING (IC / CP / AT)

- A- HOOK THE RETAINING CABLE'S LOOP ON THE LED DRIVER HOUSING.
- B- CONNECT QUICK CONNECTOR COMING FROM CEILING HOUSING. (1 CONNECTOR FOR LTE, 2 FOR D10 DIMMING.)
- C- INSERT LED DRIVER HOUSING THROUGH CUT-OUT.
- D- CONNECT THE FIXTURE TO THE DRIVER USING THE QUICK CONNECTOR.
- E- INSERT LIGHTING MODULE INTO THE FRAME KIT UNTIL IT CLICKS INTO PLACE.

A + B + C + D

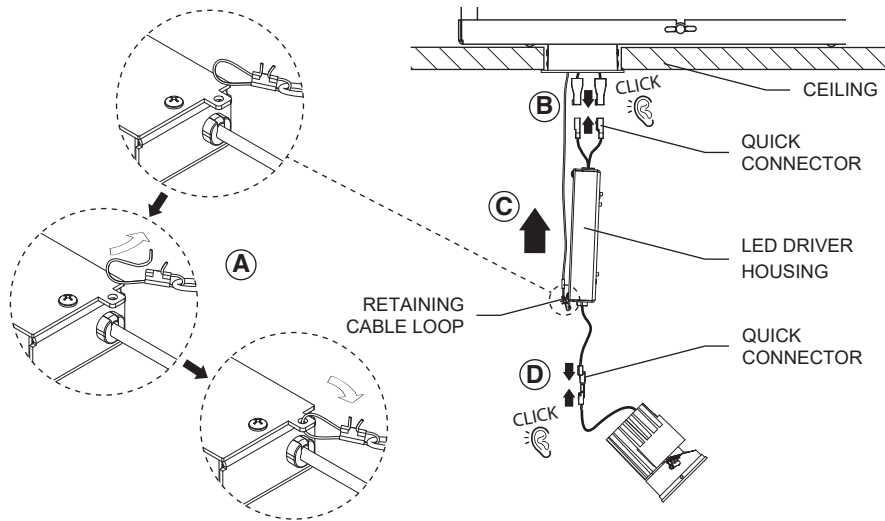

E

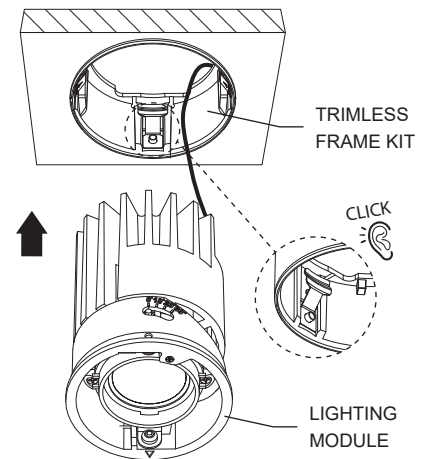

## OPTICAL ADJUSTMENT AND BAFFLE ASSEMBLY

- A- THE OPTICAL ORIENTATION CAN BE MANUALLY ADJUSTED FOR 30°.
- B- INSERT THE BAFFLE INTO THE TRIM UNTIL IT CLICKS INTO PLACE.

A

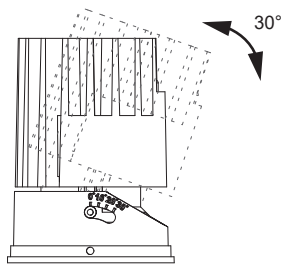

B

