

IMPORTANT - READ CAREFULLY BEFORE INSTALLING FIXTURE. RETAIN THESE INSTRUCTIONS FOR FUTURE REFERENCE.

THIS PRODUCT MUST BE INSTALLED IN ACCORDANCE WITH THE NATIONAL ELECTRICAL CODE AND ALL APPLICABLE LOCAL CODES, BY A PERSON FAMILIAR WITH THE CONSTRUCTION AND OPERATION OF THE PRODUCT, AND THE HAZARDS INVOLVED. PROPER GROUNDING IS REQUIRED FOR SAFETY.

INSTALLING PROJECTOR ON SISTEMALUX TWO CIRCUIT TRACK WITH DATA (120V OR 277V)

FOR USE WITH **SISTEMALUX** TWO CIRCUIT TRACK WITH DATA SYSTEM (120V OR 277V) OR WITH STUCCHI TWO CIRCUIT TRACK WITH DATA 9000-UL SYSTEM (120V OR 277V) ONLY.

A - INSERT THE PROJECTOR TRACK ADAPTOR WITH THE POLARITY GROOVE TOWARDS THE POLARITY RIDGE ON THE TRACK AND PUSH INTO THE TRACK UNTIL IT SNAPS INTO PLACE.

B - PUSH THE MECHANICAL FIXING LEVER TO THE RIGHT TO LOCK THE PROJECTOR INTO THE TRACK.

C - SELECT THE DESIRED CIRCUIT WITH THE CIRCUIT SELECTOR SWITCH.

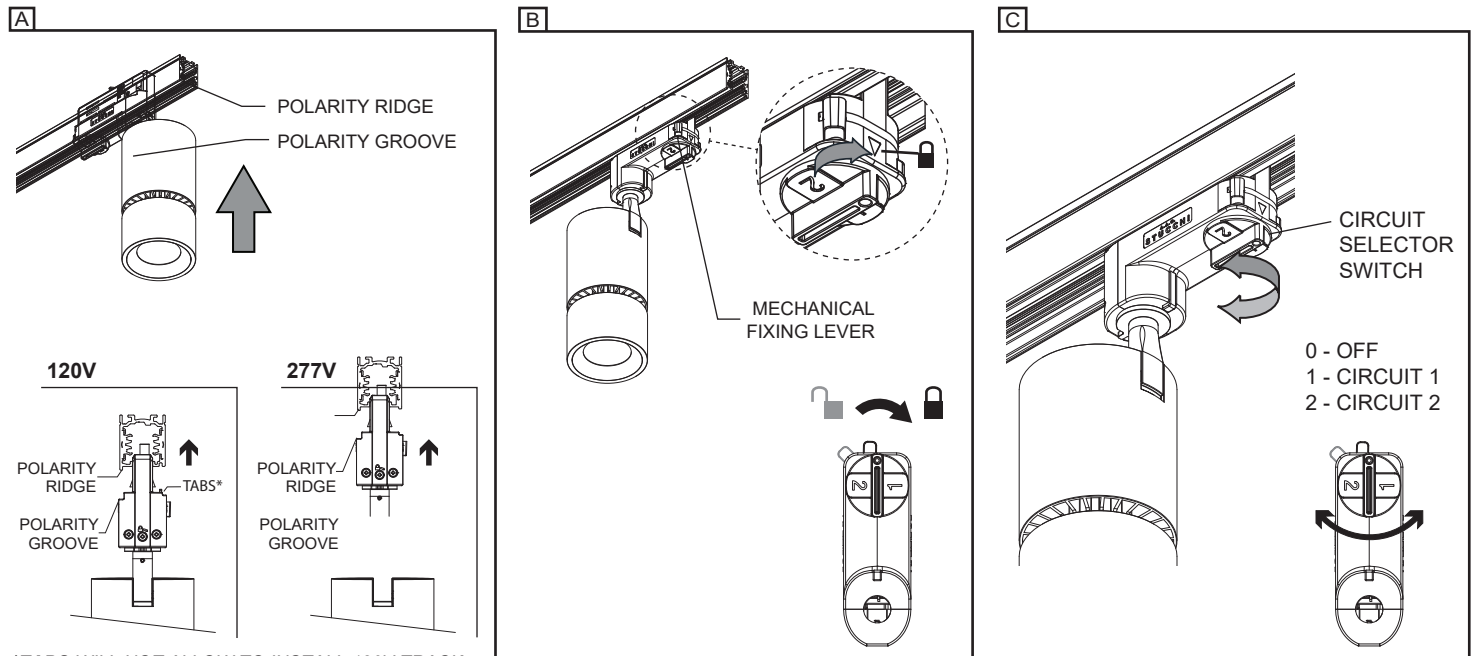

*TABS WILL NOT ALLOW TO INSTALL 120V TRACK ADAPTOR INTO A 277V TRACK.

REMOVING PROJECTOR FROM TRACK

A - TO REMOVE THE PROJECTOR FROM TRACK, SELECT 0-POSITION (**OFF**) ON THE CIRCUIT SELECTOR SWITCH.

B - TURN THE MECHANICAL FIXING LEVER AS SHOWN TO **UNLOCK** THE PROJECTOR FROM THE TRACK.

C - PULL FIRST FROM THE FIXING LEVER END TO REMOVE THE PROJECTOR FROM THE TRACK.

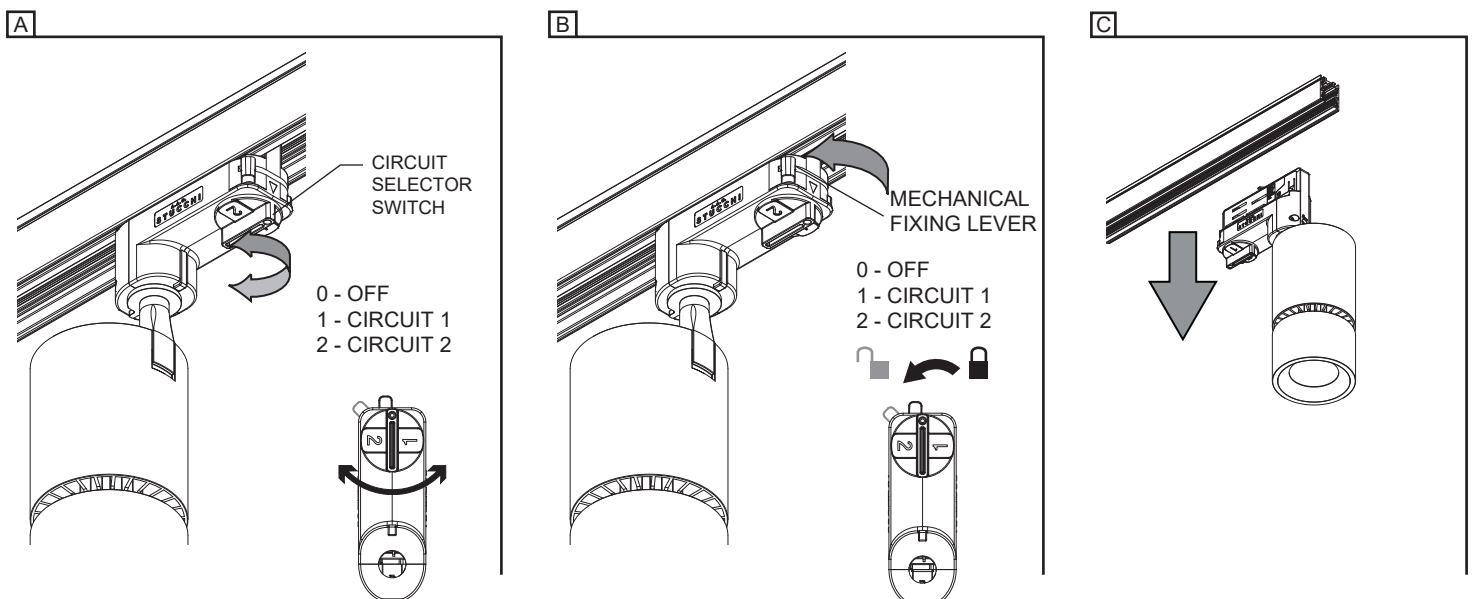

PAN ANGLE POSITION

A - ADJUST THE DESIRED PAN POSITION. (MAXIMUM OF 330° AXIAL ROTATION).

B - LOCK THE POSITION WITH THE PAN ADJUSTMENT LOCKING SCREW.

A

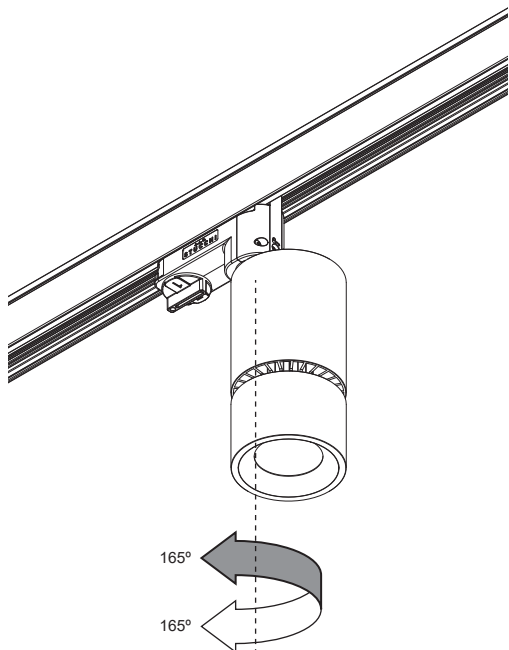

B

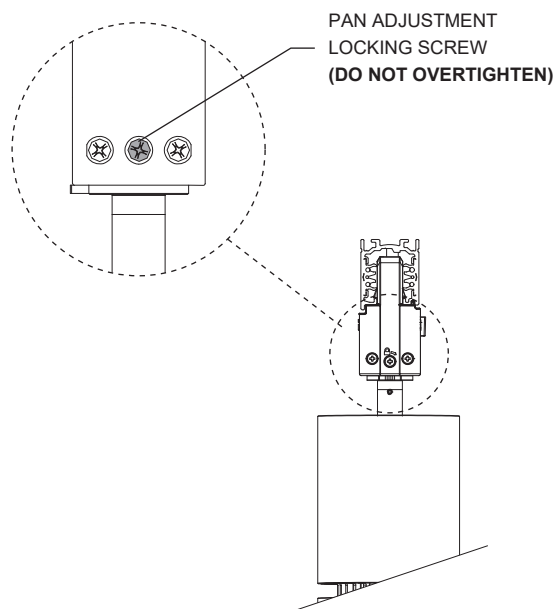

TILT ANGLE POSITION

A- OPTINAL - IF APPLICABLE LOOSEN THE TILT ADJUSTMENT LOCKING SCREW USING A SLOTTED SCREWDRIVER.

B- SET TO THE DESIRED TILT POSITION (MAXIMUM OF 90° AXIAL ROTATION) AND IF APPLICABLE FASTEN THE SCREW (DO NOT OVERTIGHTEN).

A

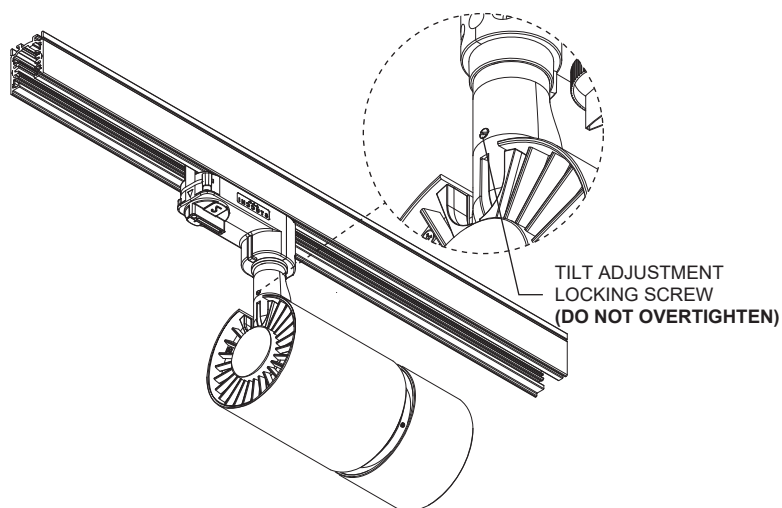

B

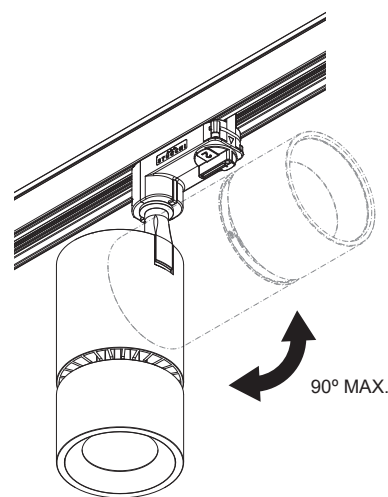

FOR 1780 AND 1790 MODELS, NOT UNLOCKING THE LOCKING SET SCREW TO CHANGE THE TILT ANGLE WILL CAUSE INTERNAL DAMAGE TO THE PROJECTOR.

REPLACING OPTIC

A- UNSCREW THE OPTIC HOLDER TO ACCESS THE REFLECTOR.

B- REPLACE THE REFLECTOR AND RE-INSTALL THE OPTIC HOLDER BACK IN PLACE.

A + B

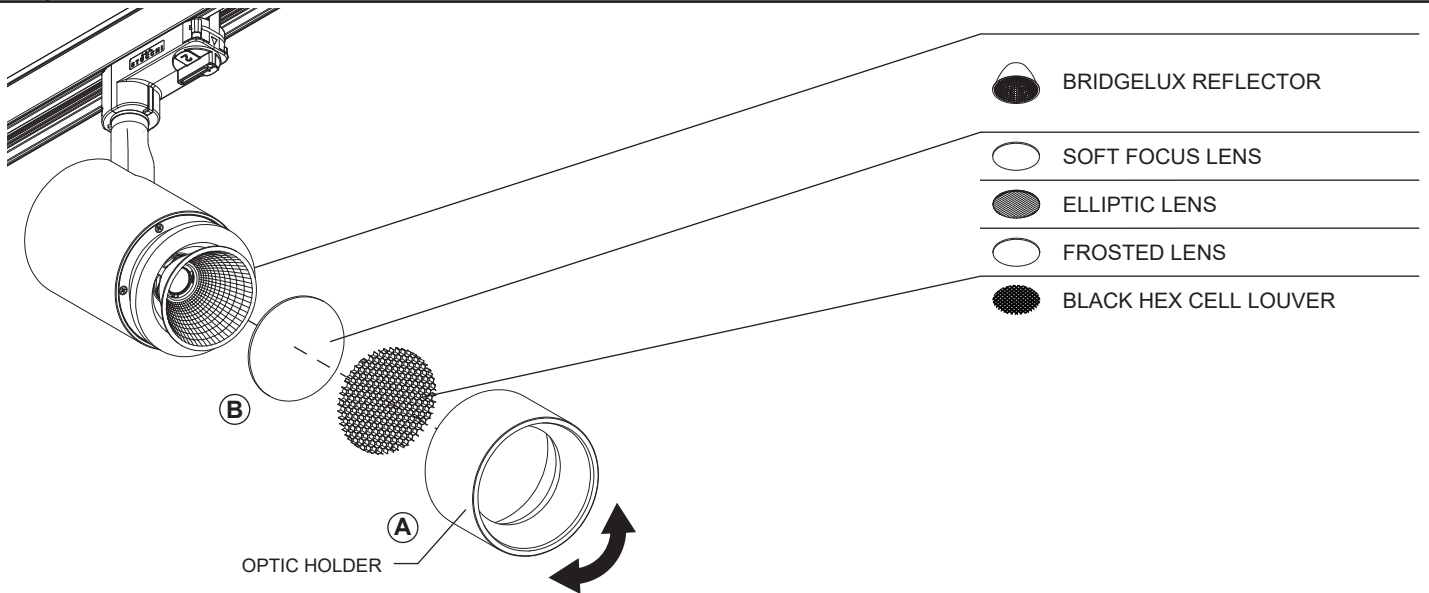

REPLACING OPTIC

A- UNSCREW THE OPTIC HOLDER

B- PLACE ACCESSORY BETWEEN THE OPTIC HOLDER AND THE ACCESSORY HOLDER

C- RE-INSTALL THE OPTIC HOLDER BACK IN PLACE..

A + B + C

