

IMPORTANT - READ CAREFULLY BEFORE INSTALLING FIXTURE. RETAIN THESE INSTRUCTIONS FOR FUTURE REFERENCE.
THIS PRODUCT MUST BE INSTALLED IN ACCORDANCE WITH THE NATIONAL ELECTRICAL CODE AND ALL APPLICABLE LOCAL CODES, BY A PERSON FAMILIAR WITH THE CONSTRUCTION AND OPERATION OF THE PRODUCT, AND THE HAZARDS INVOLVED. PROPER GROUNDING IS REQUIRED FOR SAFETY.

INSTALLING PROJECTOR ON ONE CIRCUIT TRACK (1620S)

FOR USE WITH **SISTEMALUX 8000 SERIES, OR SISTEMALUX 8000-S1 SERIES** TRACK SYSTEM ONLY (120V).

- A- INSERT THE TRACK ADAPTOR ON THE TRACK RESPECTING THE SAME EMBOSSEMENTS DIRECTION AS SHOWN IN "A".
B- LOCATE THE **GROUND CIRCUIT** OF THE TRACK. PUSH THE PROJECTOR INTO TRACK AND ROTATE THE TRACK ADAPTOR A QUARTER TURN IN THE PROPER DIRECTION IN ORDER TO MAKE CONTACT WITH THE **GROUND CONTACT** OF THE TRACK ADAPTOR. EMBOSSEMENTS HAVE TO BE IN THE TRACK SLOT FOR FINAL POSITION.

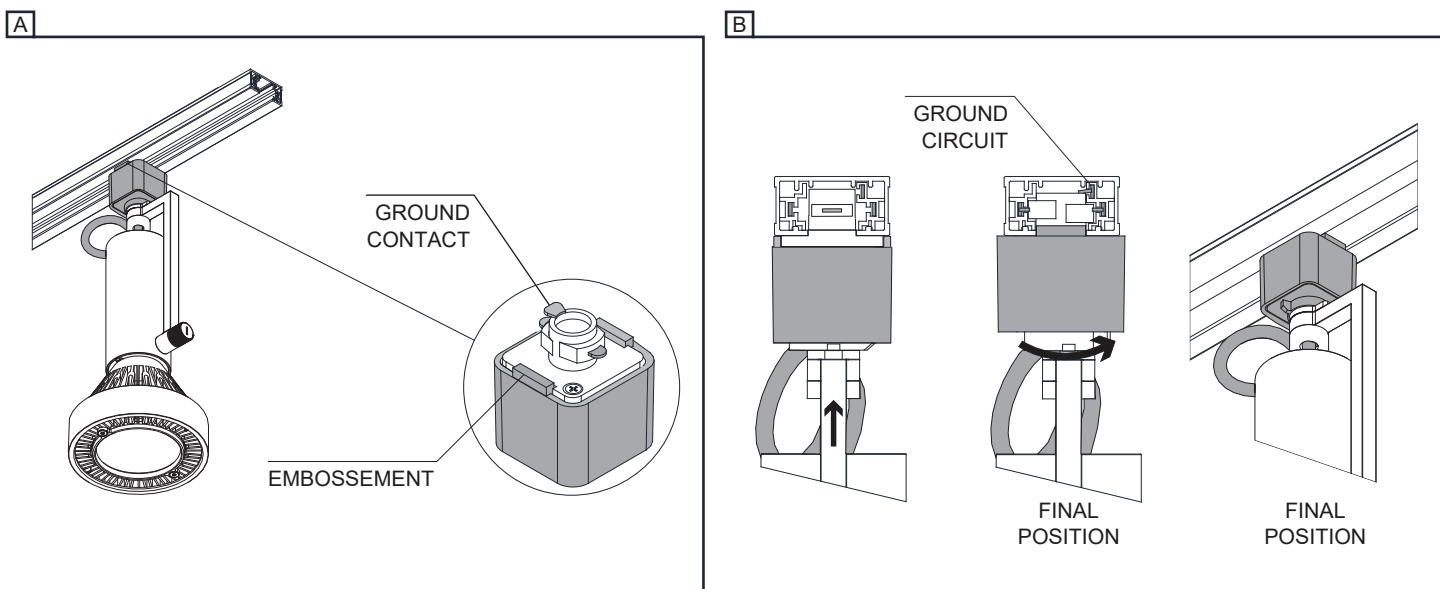

REMOVING PROJECTOR FROM TRACK (1620S)

- A- TO REMOVE THE PROJECTOR FROM THE TRACK, PULL THE TRACK ADAPTOR UNTIL EMBOSSEMENTS ARE OUTSIDE THE TRACK SLOT
B- WHILE PULLING THE TRACK ADAPTOR, ROTATE A QUARTER TURN IN ANY DIRECTION AND PULL THE PROJECTOR TO REMOVE IT FROM THE TRACK.

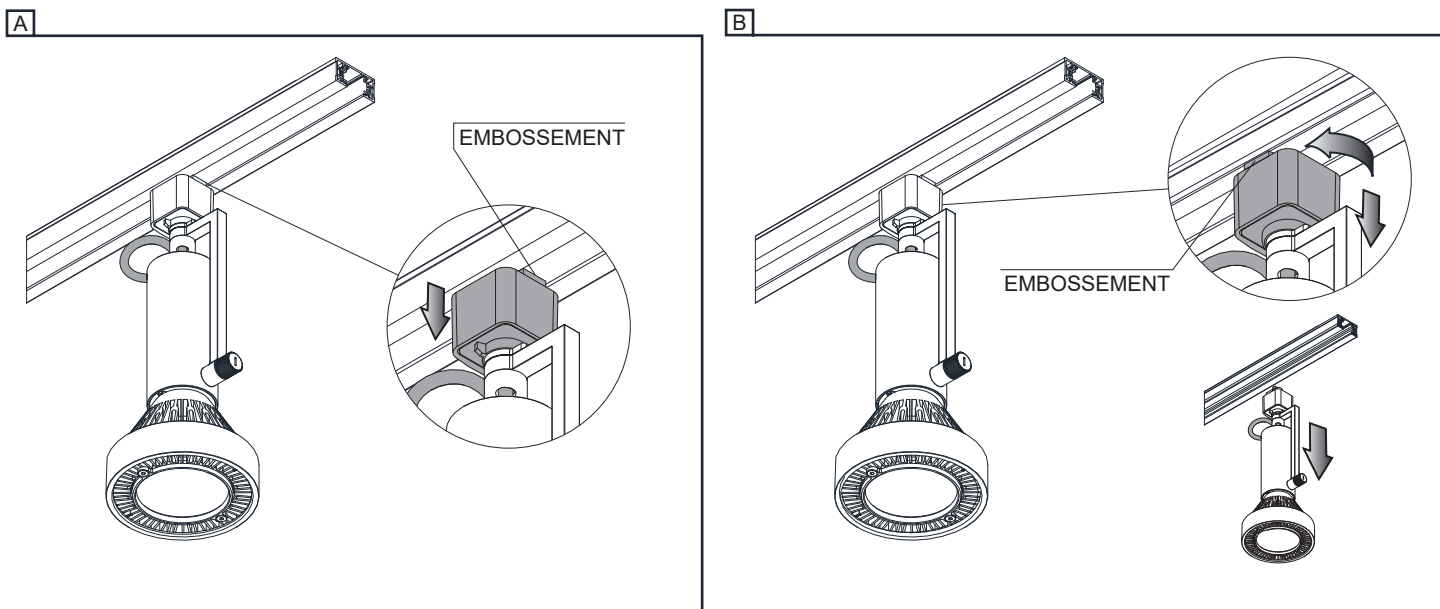

INSTALLING PROJECTOR ON ONE CIRCUIT TRACK (CEILING OR WALL 1620W)

FOR USE WITH **SISTEMALUX 8000 SERIES** TRACK SYSTEM ONLY (120V).

A- INSERT THE TRACK ADAPTOR ON THE TRACK RESPECTING THE SAME DIRECTION AS SHOWN IN "A".

FOR WALL INSTALLATION, MAKE SURE THE TRACK IS INSTALLED 5 FEET FROM GROUND.

B- LOCATE THE **GROUND CIRCUIT** OF THE TRACK. PUSH THE PROJECTOR INTO TRACK AND ROTATE THE TRACK ADAPTOR A QUARTER CLOCKWISE THE PROPER DIRECTION IN ORDER TO MAKE CONTACT WITH THE **GROUND CONTACT** OF THE TRACK ADAPTOR. SPRING CLIP HAVE TO BE IN THE TRACK SLOT FOR FINAL POSITION.

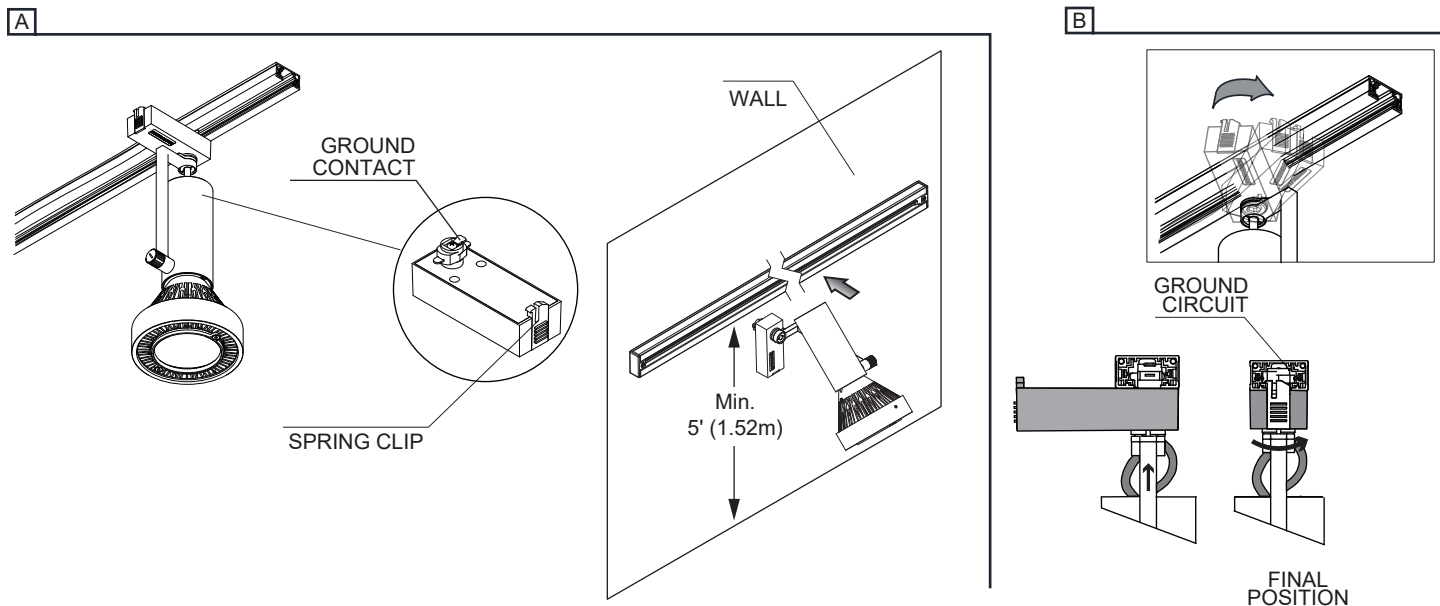

REMOVING PROJECTOR FROM TRACK (1620W)

A- TO REMOVE THE PROJECTOR FROM THE TRACK, PULL THE SPRING CLIP UNTIL THE CLIP IS OUTSIDE THE TRACK SLOT

B- WHILE PULLING THE TRACK ADAPTOR, ROTATE A QUARTER TURN IN ANY DIRECTION AND PULL THE PROJECTOR TO REMOVE IT FROM THE TRACK.

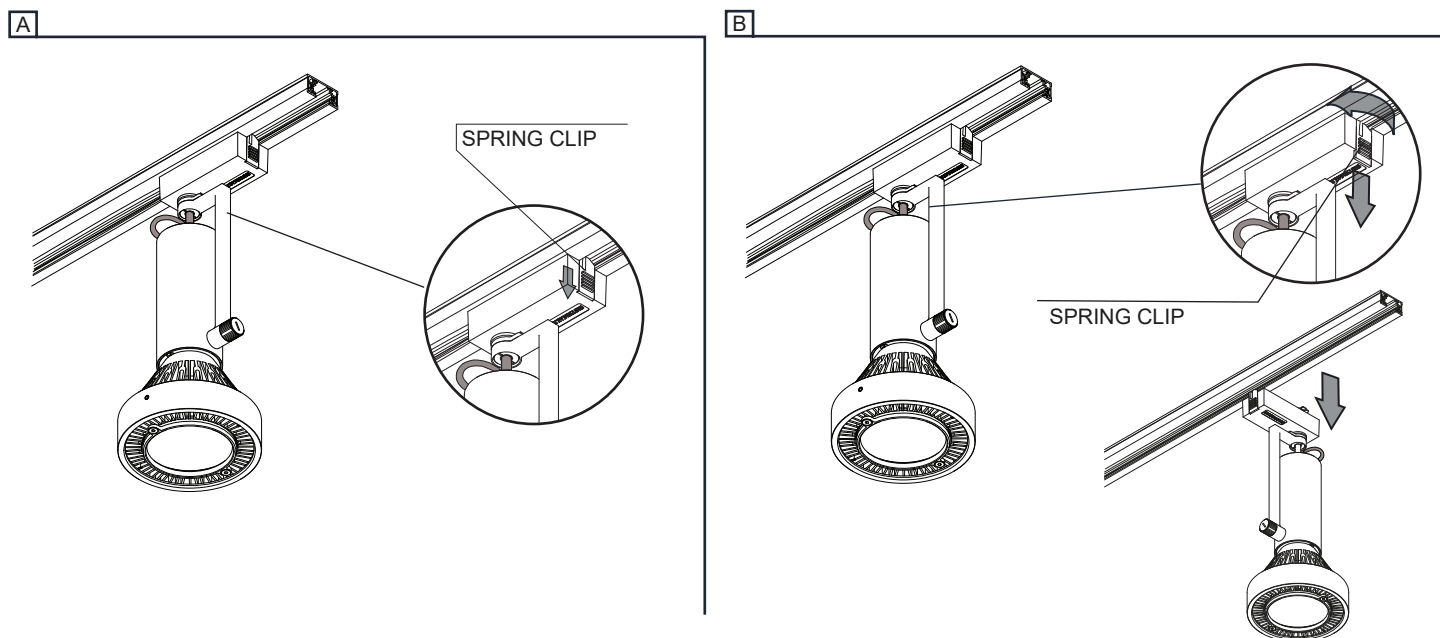

PAN ANGLE POSITION (1620S/1620W)

A- ADJUST THE DESIRED PAN POSITION. (MAXIMUM OF 330° AXIAL ROTATION)

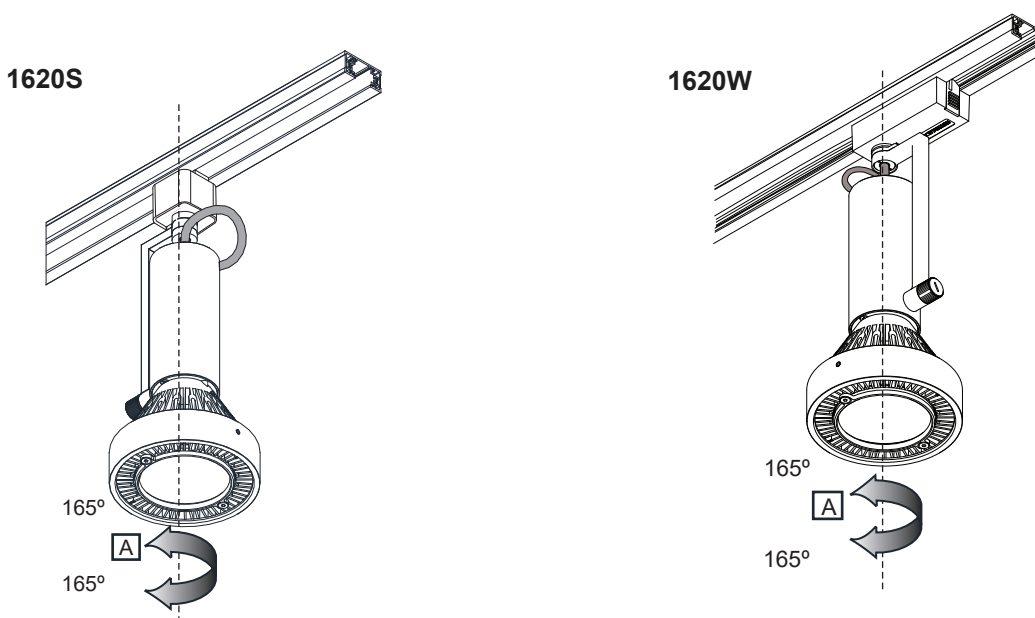

TILT ANGLE POSITION (1620S/1620W)

A- ADJUST THE DESIRED POSITION AND LOCK WITH THE LOCKING THUMB SCREW. YOU CAN USE A SLOT SCREW DRIVER FOR AN EVEN BETTER TIGHT ADJUSTMENT. (MAXIMUM OF 270° AXIAL ROTATION)

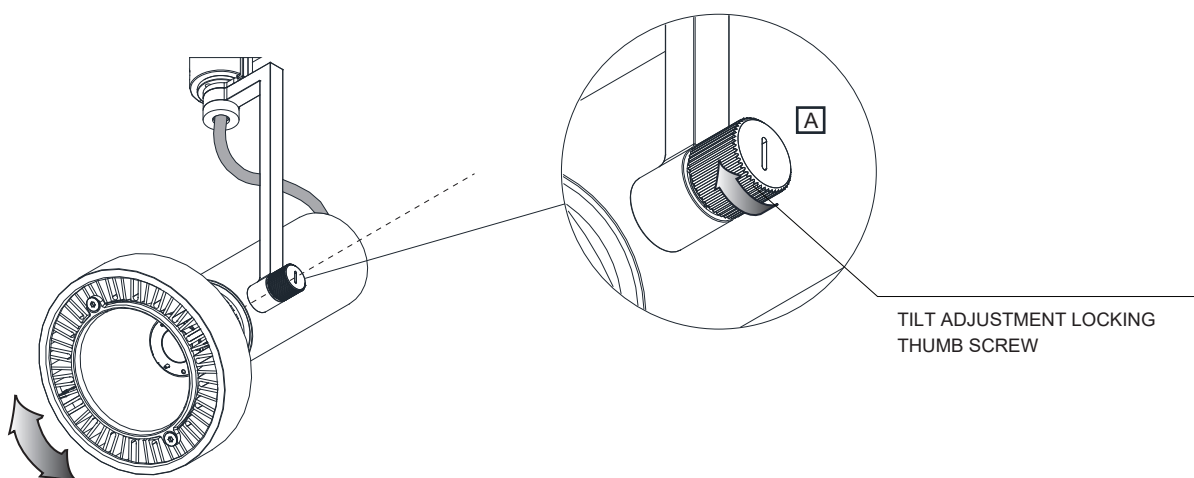

REPLACING OPTIC

A- UNSCREW THE TWO ALLEN KEY SCREWS TO REMOVE THE OPTIC HOLDER.

B- INSERT THE LENS OR THE LOUVER IN THE O-RING.

C- INSERT AND RE-INSTALL THE OPTIC HOLDER BACK IN PLACE.

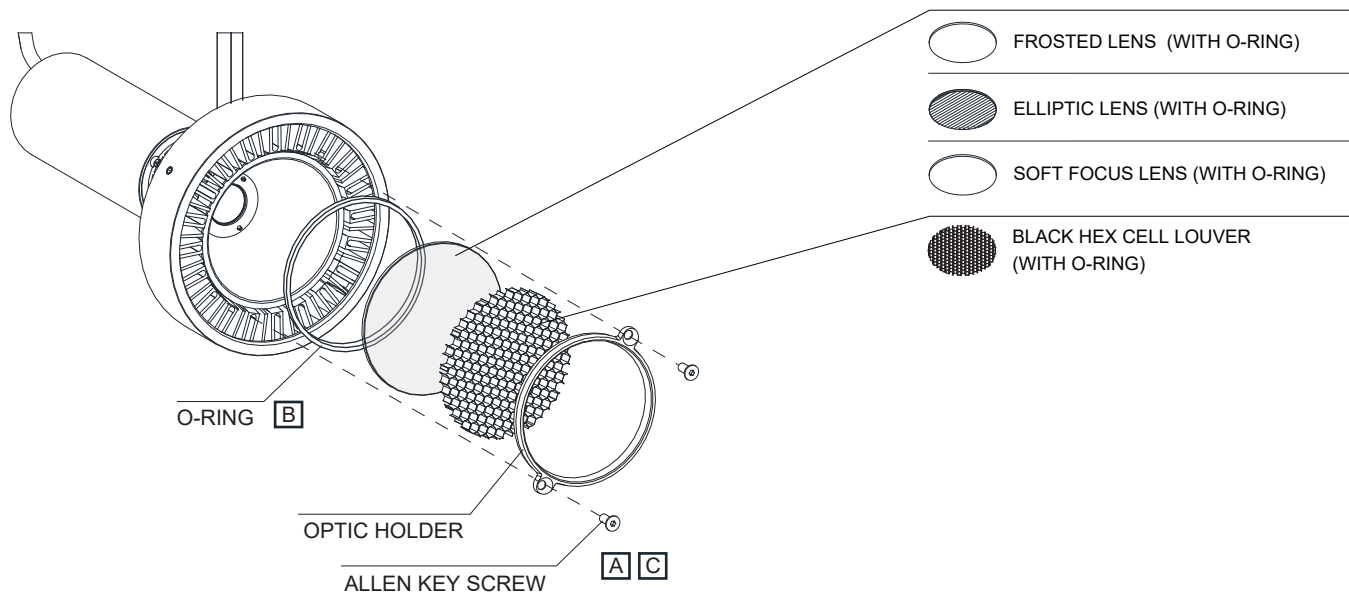

ACCESSORIES (MAXIMUM OF TWO ACCESSORIES IN COMBINATION, REFLECTORS DO NOT COUNT AS ACCESSORY)

A- UNSCREW THE TWO ALLEN KEY SCREWS TO REMOVE THE OPTIC HOLDER.

B- REPLACE THE REFLECTOR OR INSERT ACCESSORY AND RE-INSTALL THE OPTICAL HOLDER BACK IN PLACE.

