

**IMPORTANT** - READ CAREFULLY BEFORE INSTALLING FIXTURE. RETAIN THESE INSTRUCTIONS FOR FUTURE REFERENCE.  
THIS PRODUCT MUST BE INSTALLED IN ACCORDANCE WITH THE NATIONAL ELECTRICAL CODE AND ALL APPLICABLE LOCAL CODES, BY A PERSON FAMILIAR WITH THE CONSTRUCTION AND OPERATION OF THE PRODUCT, AND THE HAZARDS INVOLVED. PROPER GROUNDING IS REQUIRED FOR SAFETY.

## INSTALLING PROJECTOR ON ONE CIRCUIT TRACK (120V)

FOR USE WITH **JUNO'S T SERIES** TRACK SYSTEM ONLY (120V)

- A - PULL THE ADAPTOR HOUSING DOWN TO INSERT IN THE TRACK FOLLOWING INITIAL POSITION SHOWN BELOW.  
B - PUSH THE PROJECTOR INTO TRACK AND ROTATE THE TRACK ADAPTOR A QUARTER TURN IN THE PROPER DIRECTION IN ORDER TO ALLOW ELECTRICAL BOUNDING. MAKE SURE THE ADAPTOR IS LOCKED IN PLACE, FOLLOWING FINAL POSITION SHOWN BELOW.

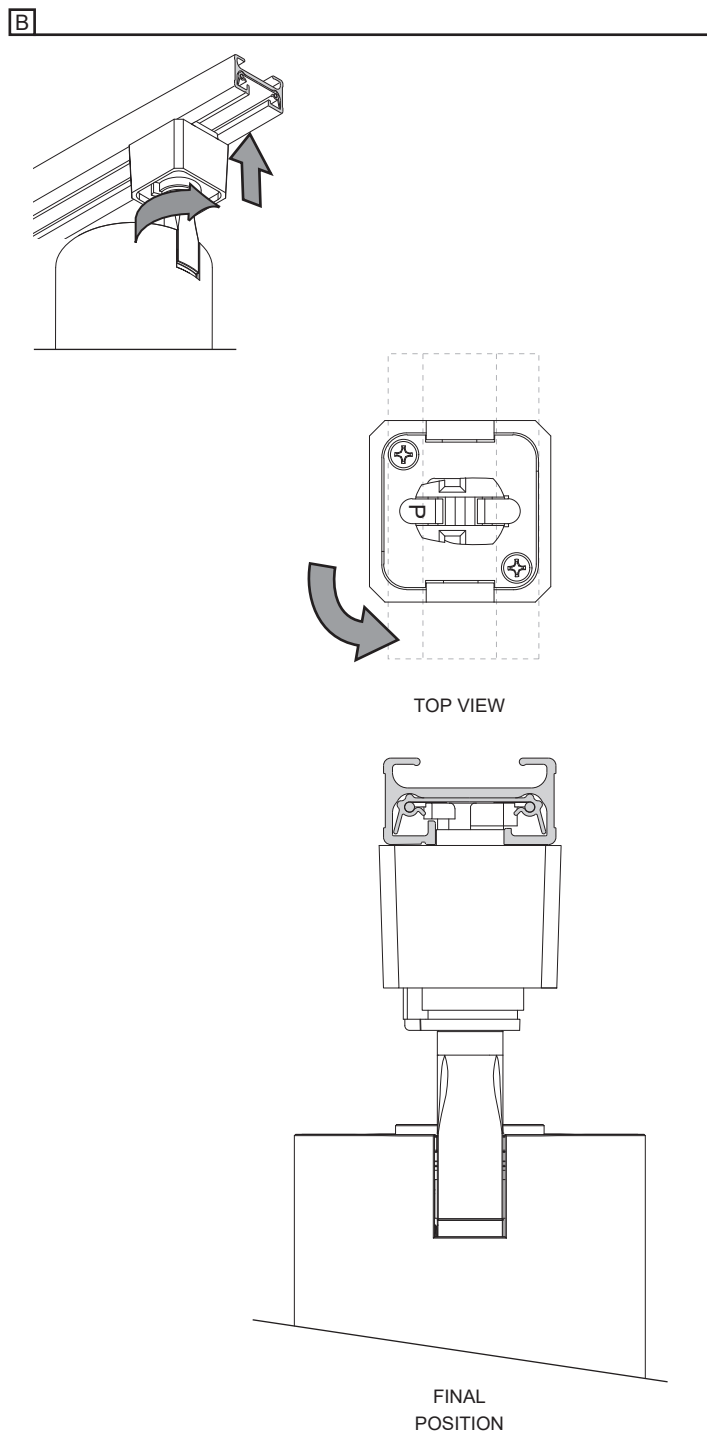
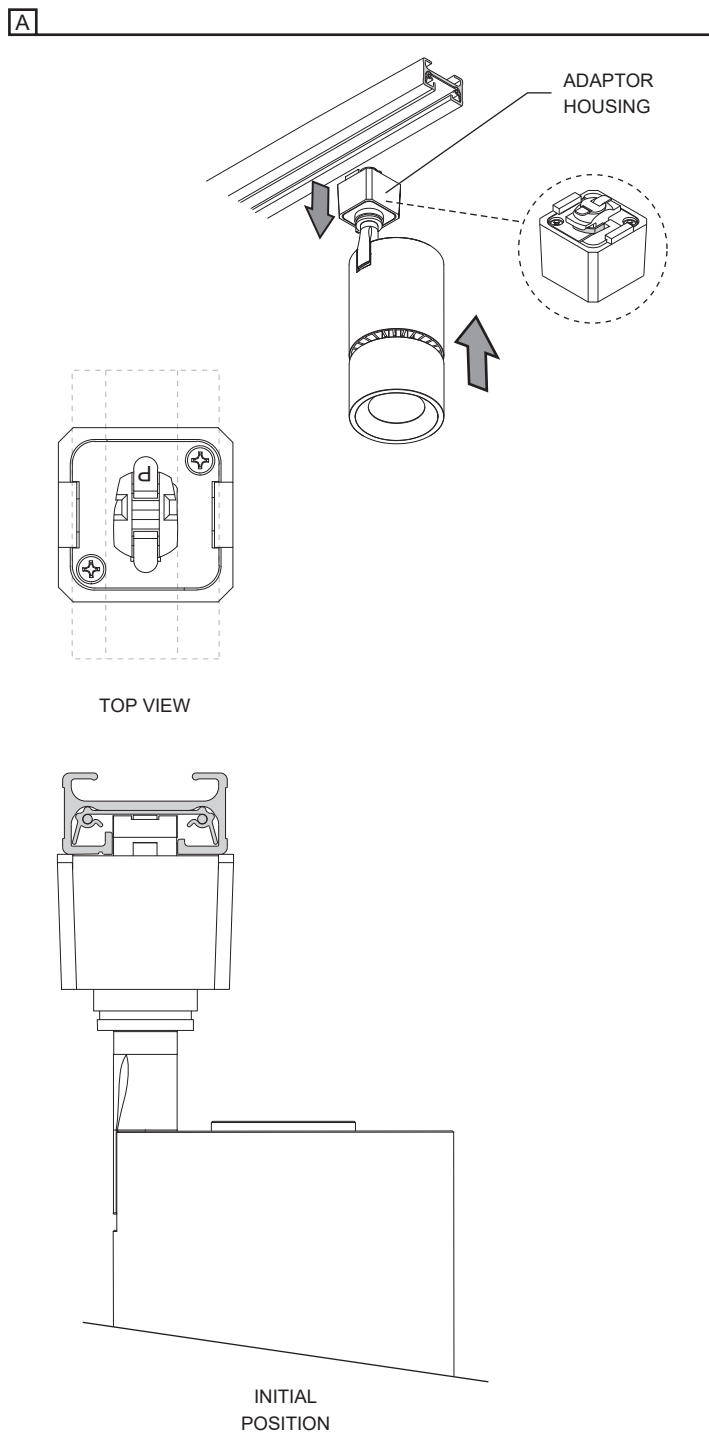

## REMOVING PROJECTOR FROM ONE CIRCUIT TRACK (1770J)

A - PULL DOWN THE TRACK ADAPTOR HOUSING TO UNLOCK IT FROM THE TRACK SLOT.

B - HOLDING THE TRACK ADAPTOR HOUSING DOWN, ROTATE A QUARTER TURN IN ANY DIRECTION AND PULL DOWN THE PROJECTOR TO REMOVE IT FROM THE TRACK.

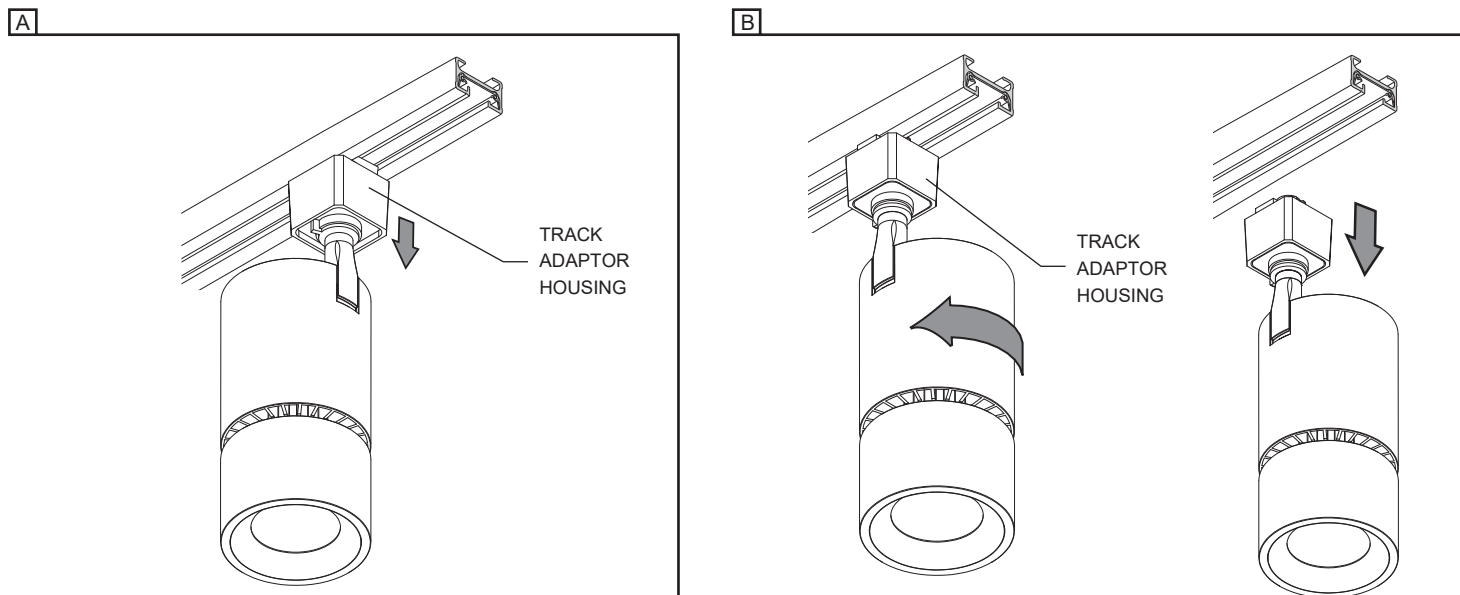

## PAN ANGLE POSITION (1770J)

A - ROTATE THE FIXTURE TO DESIRED PAN POSITION (MAXIMUM OF 330° AXIAL ROTATION).

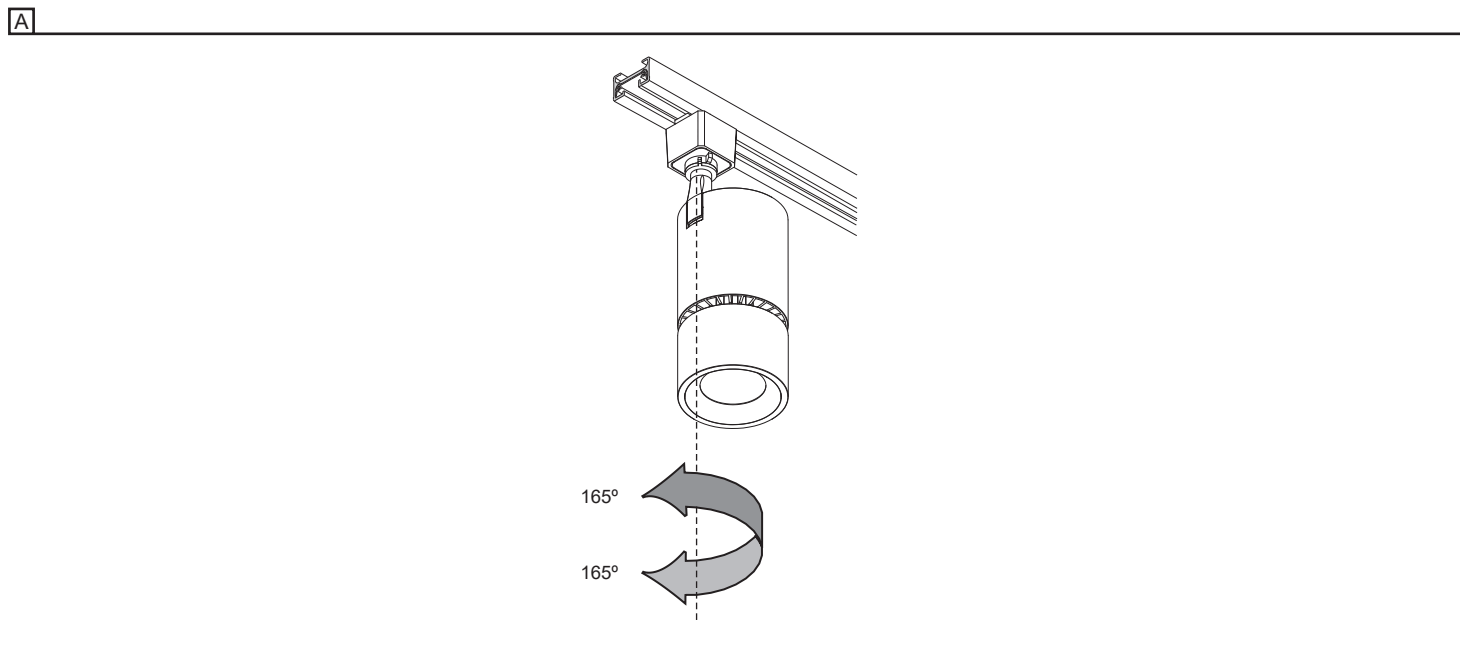

## TILT ANGLE POSITION (1770J)

A - ROTATE THE FIXTURE TO DESIRED TILT POSITION (MAXIMUM OF 90° AXIAL ROTATION).

A

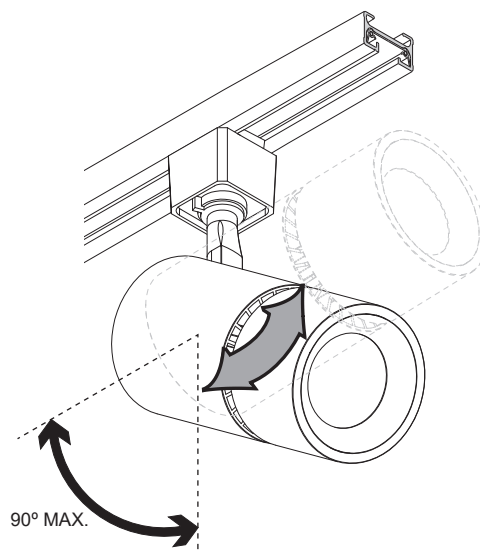

## REPLACING OPTIC FOR REFLECTOR MODELS

A - UNSCREW THE OPTIC HOLDER TO ACCESS THE REFLECTOR.

B - REPLACE THE REFLECTOR AND RE-INSTALL THE OPTIC HOLDER BACK IN PLACE.

A + B

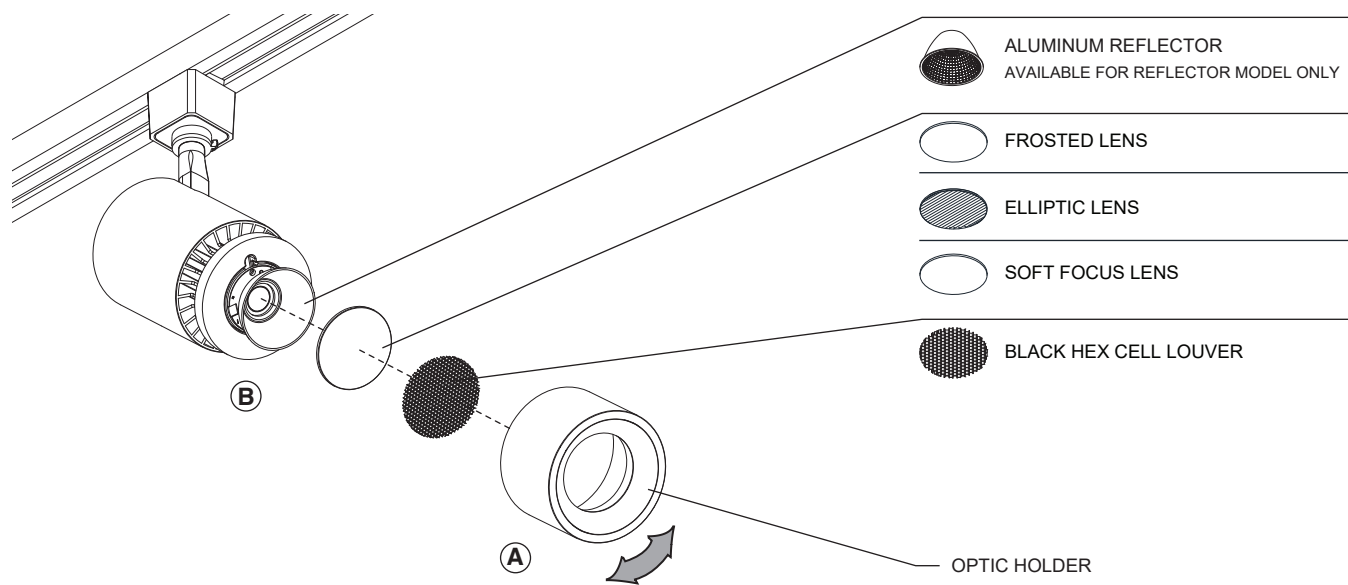

## ACCESSORIES

A - UNSCREW THE OPTIC HOLDER

B - PLACE ACCESSORY BETWEEN THE OPTIC HOLDER AND THE ACCESSORY HOLDER

C - RE-INSTALL THE OPTIC HOLDER BACK IN PLACE.

A + B + C

