

IMPORTANT - READ CAREFULLY BEFORE INSTALLING FIXTURE. RETAIN THESE INSTRUCTIONS FOR FUTURE REFERENCE.

THIS PRODUCT MUST BE INSTALLED IN ACCORDANCE WITH THE NATIONAL ELECTRICAL CODE AND ALL APPLICABLE LOCAL CODES, BY A PERSON FAMILIAR WITH THE CONSTRUCTION AND OPERATION OF THE PRODUCT, AND THE HAZARDS INVOLVED.

NEW CONCRETE INSTALLATION PREPARATION (WITH FLANGE ACCESSORY S2148)

A- PREPARE THE DESIRED DRAINING USING 8"-12" (20-30cm) OF GRAVEL UNDER THE FLANGE.

B- INSTALL AN APPROPRIATE ELECTRICAL CONDUIT (**NOT INCLUDED**) THROUGH THE FLANGE.

C- FEED CABLE THROUGH THE ELECTRICAL CONDUIT.

D- POUR CONCRETE IN AND MAKE SURE THE FLANGE SITS 3/16" (5mm) OVER THE TOP OF THE SLAB.

A + B + C

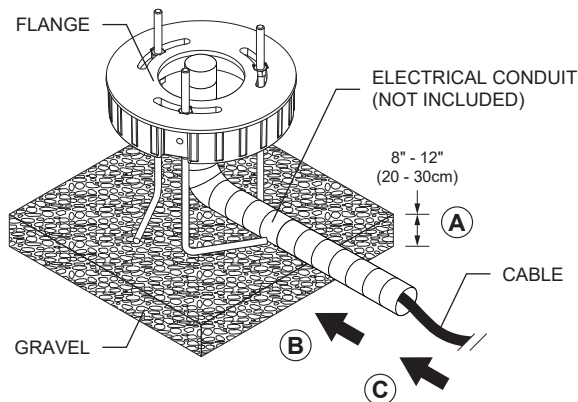

D

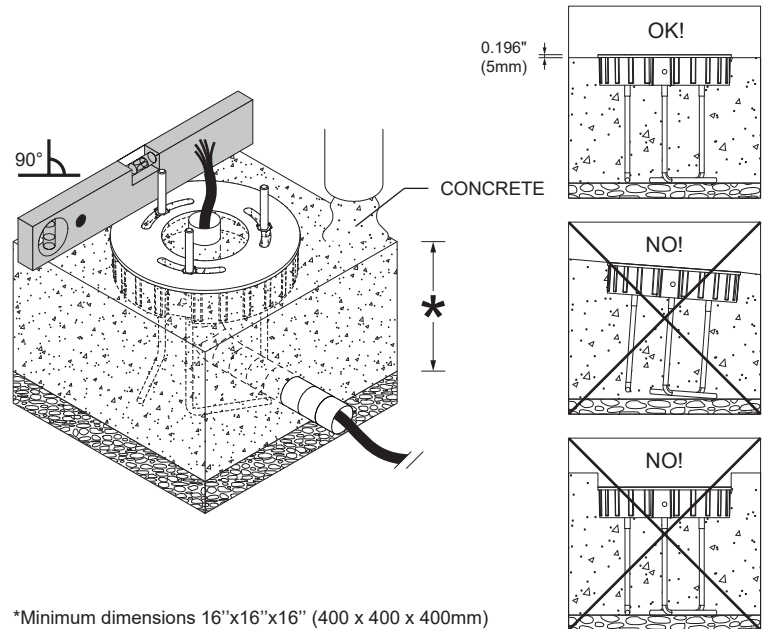

PRE-EXISTING SURFACE INSTALLATION PREPARATION

A- DRILL (3) HOLES AT 120° IN THE SOLID SURFACE (SEE DIMENSIONS BELOW).

B- INSERT #5/16 OR M8 THREADED ANCHOR RODS (NOT INCLUDED) INTO THE HOLES. USE THE APPROPRIATE ADHESIVE (NOT INCLUDED) TO SECURE THE RODS IN PLACE.

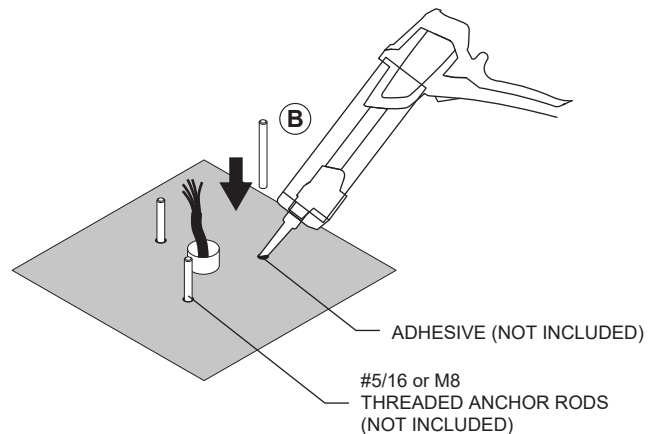
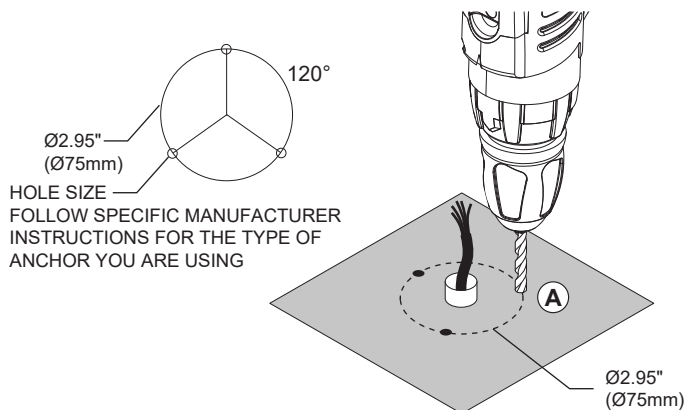

BOLLARD ASSEMBLY

A- **BOLLARD SHIFT WITH 1 HEAD.** THE BOLLARD WITH ONE SINGLE HEAD WILL BE READY TO INSTALL. GO TO PAGE 4 FOR CONNECTION AND INSTALLATION. GO TO PAGE 6 FOR HEAD ADJUSTMENT.

A

CODES 1 HEAD : SSHF4-1-025-XXX-1XXX-NA-NA-REM-XX
SSHf4-1-037-XXX-1XXX-NA-NA-REM-XX

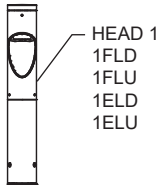

BOX 1/1

HEAD 1
ORIENTATION DOWN
1FLD
1FLU
1ELD

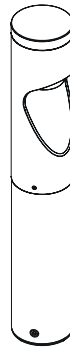

HEAD 1
ORIENTATION UP
1FLU
1ELU



A- **BOLLARD SHIFT WITH 2 HEADS.** THE BOX 1/2 CONTAINS THE BODY, BASE AND FIRST HEAD. THE BOX 2/2 CONTAIN THE HEAD 2.

B- REMOVE THE CAP FROM HEAD 1. PASS THE HEAD 2 CABLE IN THE HEAD 1 UNTIL YOU CAN SEE THE WIRE AT THE BOTTOM. INSTALL HEAD 2, JOINER SHOULD ENTER IN HEAD 1. TIGHTEN SET SCREWS. PUT BACK THE CAP ON HEAD 2. TIGHTEN THE CAP SCREWS. GO TO PAGE 4 FOR CONNECTION AND INSTALLATION. GO TO PAGE 6 FOR HEAD ADJUSTMENT.

A + B

CODES 2 HEAD : SSHF4-2-037-XXX-1XXX-2XXX-NA-REM-XX
SSHf4-2-050-XXX-1XXX-2XXX-NA-REM-XX

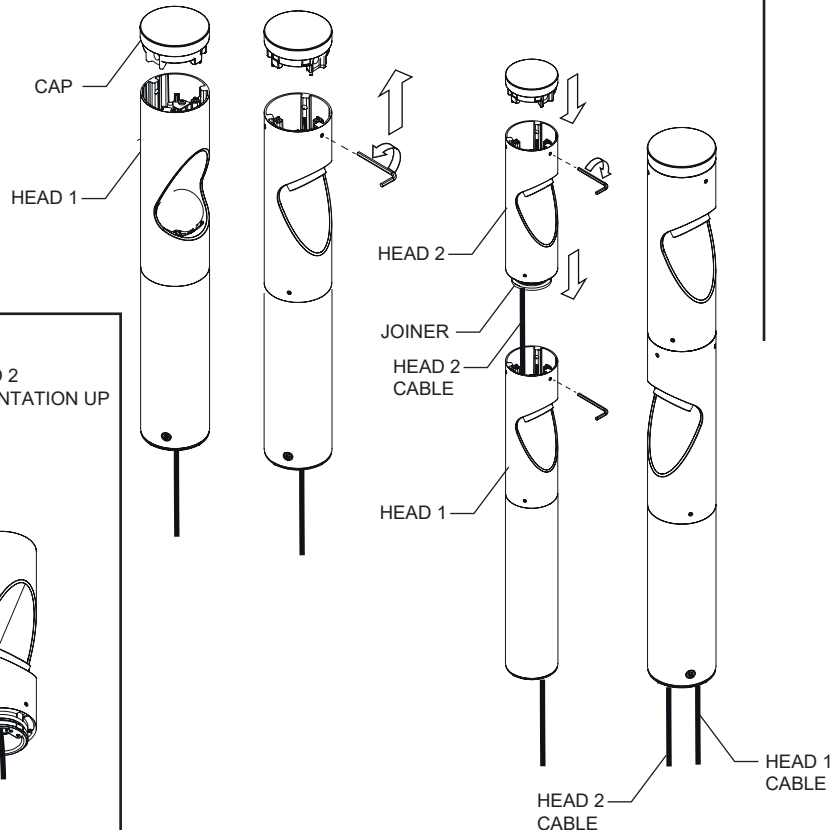
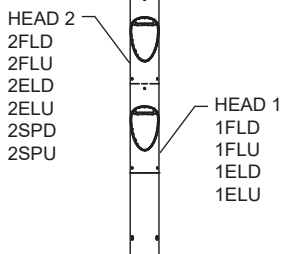

BOX 1/2

HEAD 1
ORIENTATION DOWN
1FLD
1ELD

HEAD 1
ORIENTATION UP
1FLU
1ELU

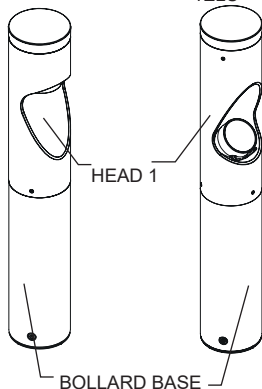

BOX 2/2

HEAD 2
ORIENTATION DOWN
2SPD
2FLD
2ELD

HEAD 2
ORIENTATION UP
2SPU
2FLU
2ELU

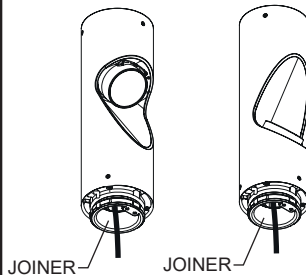

BOLLARD ASSEMBLY

- A- **BOLLARD SHIFT WITH 3 HEADS.** THE BOX 1/3 CONTAINS THE BASE AND FIRST HEAD. THE BOX 2/3 CONTAINS THE HEAD 2. THE BOX 3/3 CONTAINS THE HEAD 3.
- B- REMOVE THE CAP FROM HEAD 1. PASS THE HEAD 2 CABLE IN THE HEAD 1 UNTIL YOU CAN SEE THE WIRE AT THE BOTTOM. INSTALL HEAD 2, JOINER SHOULD ENTER IN HEAD 1. TIGHTEN SET SCREWS. REPEAT THESE TWO STEPS FOR HEAD 3. PUT BACK THE CAP ON HEAD 3. TIGHTEN THE CAP SCREWS. GO TO PAGE 4 FOR CONNECTION AND INSTALLATION. GO TO PAGE 6 FOR HEAD ADJUSTMENT.

A + B

CODES 3 HEAD : SSHF4-3-050-XXX-1XXX-2XXX-3XXX-REM-XX, SSHF4-3-062-XXX-1XXX-2XXX-3XXX-REM-XX

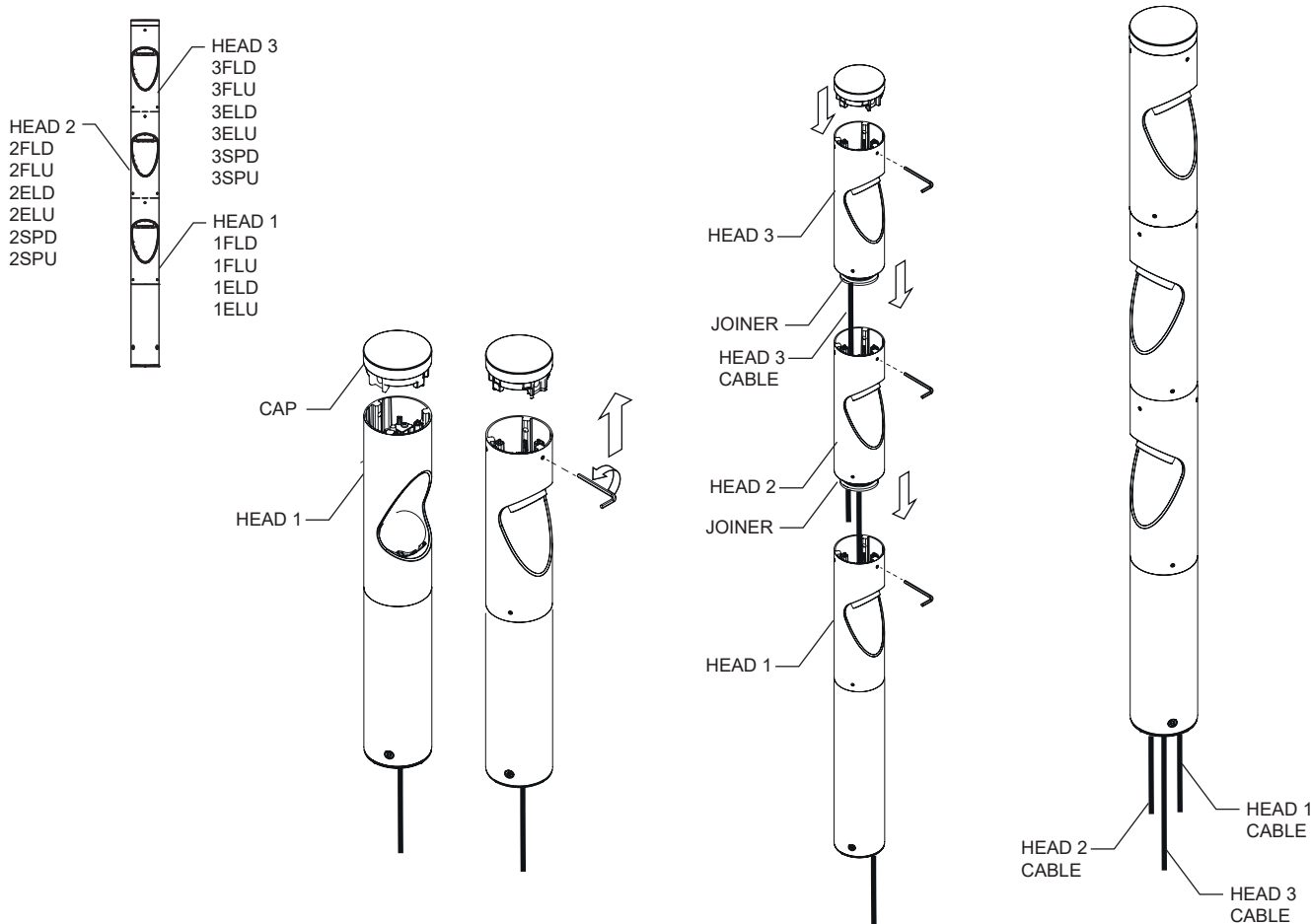
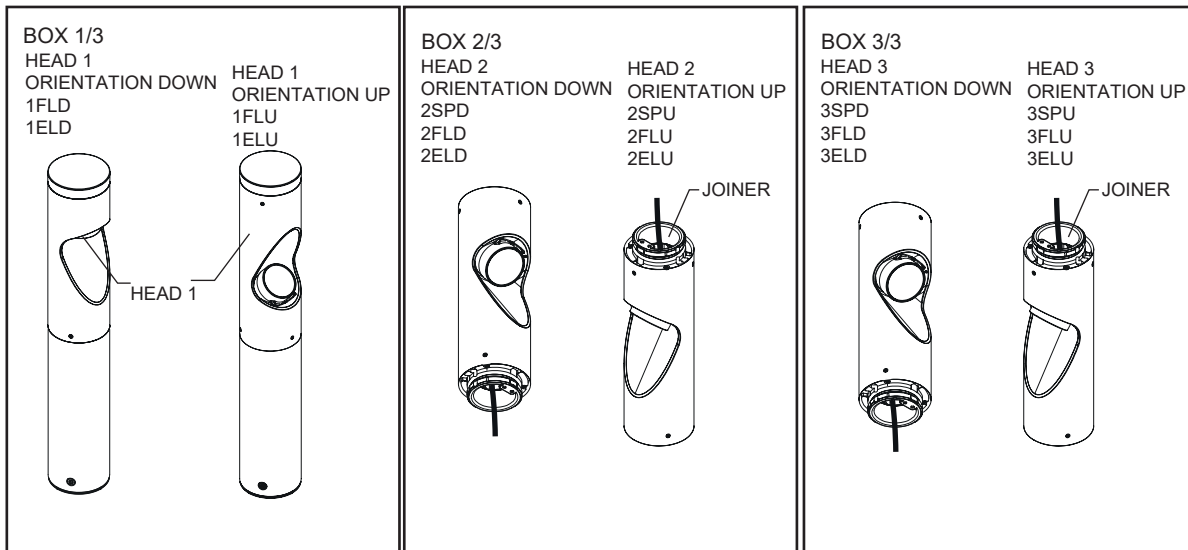

FIXTURE INSTALLATION, CONNECTION TO POWER CLASS 2 (REM)

- A- UNFASTEN THE BODY SCREWS (3) USING THE ALLEN KEY (INCLUDED).
- B- REMOVE THE BOLLARD BODY FROM THE BOLLARD BASE.
- C- LOWER THE BOLLARD BASE ON THE FLANGE OR ON THE PRE INSTALLED ANCHOR RODS AND SCREW #5/16 OR M8 NUTS (M8 NUTS INCLUDED ONLY WITH FLANGE S2148) ON THE THREADED ANCHOR RODS.
- D- MAKE THE NECESSARY WIRE CONNECTIONS TO A POWER CLASS 2 USING WATERTIGHT TWIST CONNECTORS (NOT INCLUDED). EACH HEAD REQUIRES 350mA, 13W.

A + B

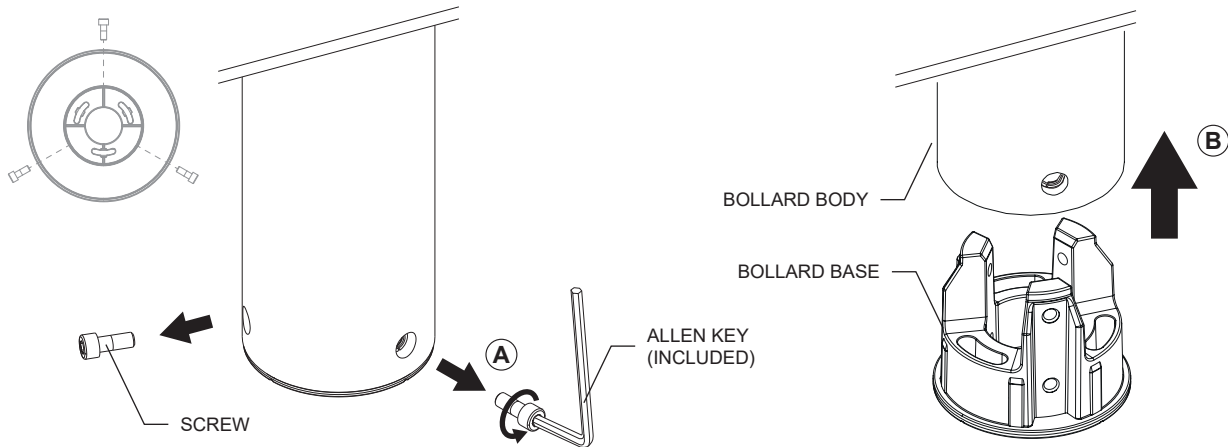

C + D

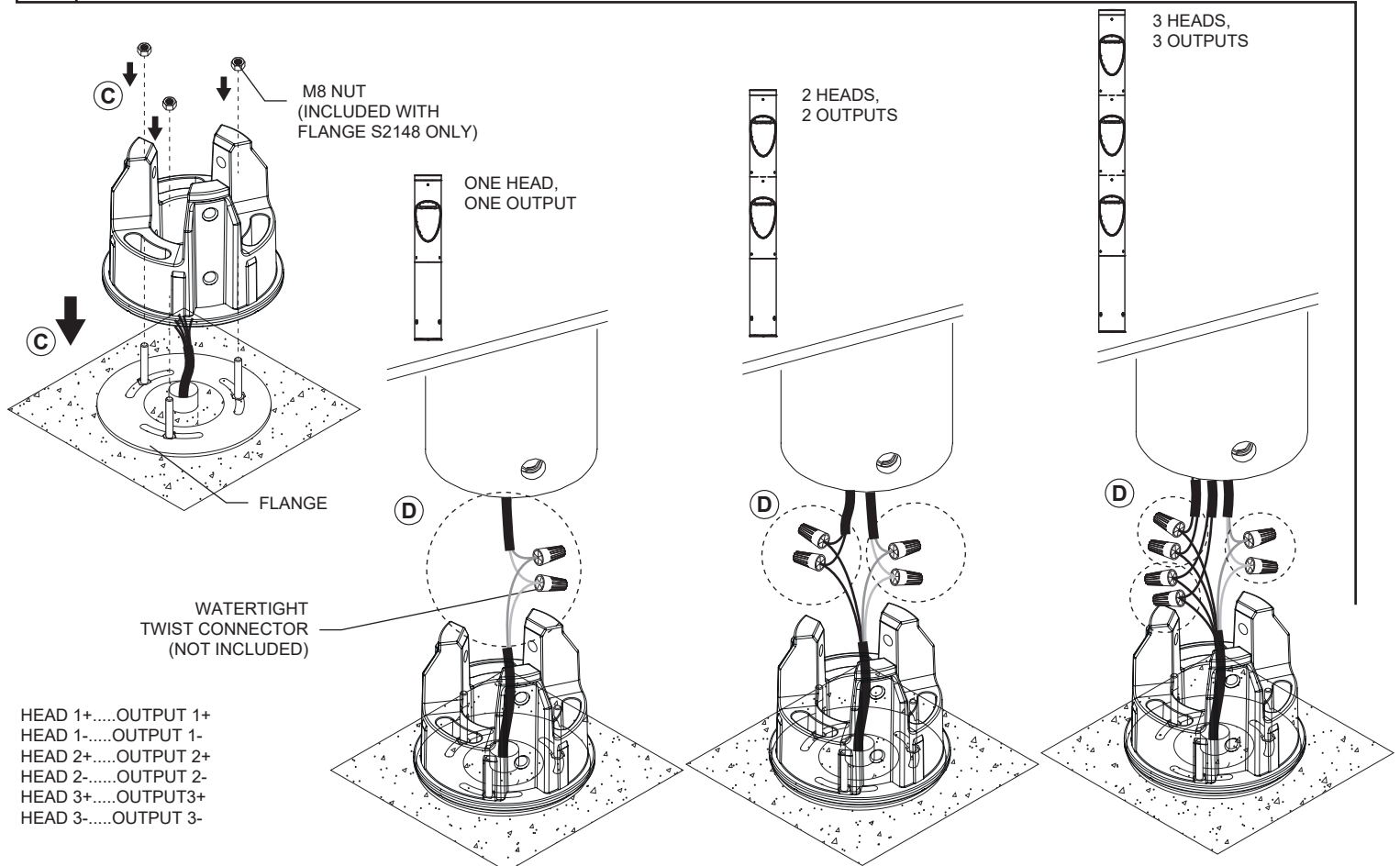

E- FASTEN THE ASSEMBLED BOLLARD BACK ON ITS BASE USING THE (3) SCREWS WITH THE ALLEN KEY (INCLUDED).

E

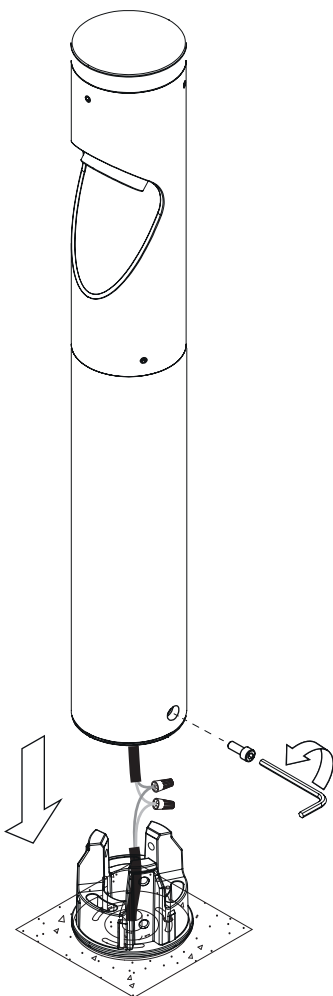

JOINER ADJUSTMENT

A- IF FOR ANY REASON YOU WANT TO SWITCH THE SIDE OF A HEAD, UNTIGHTEN THE 3 JOINER'S SCREWS AND REMOVE JOINER. PASS THE CABLE ON THE OTHER SIDE OF THE HEAD. FLIP THE JOINER TO THE OTHER SIDE AND TIGHTEN THE SCREWS.

A

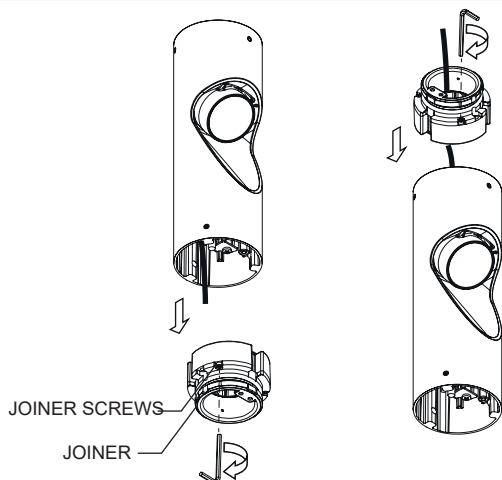

HEAD ADJUSTMENT

- A- FOR PAN ADJUSTMENT, UNTIGHTEN THE INDICATE SCREWS ON -A- AND TURN HEAD UNTIL GOOD POSITIONNING. REPEAT THE SAME STEPS FOR EACH HEADS AND TIGHTEN THE 3 SCREWS FROM EACH HEADS.
- B- FOR TILT ADJUSTMENT, UNTIGHTEN THE INDICATE SET SCREW ON -B- AND TILT HEAD UNTIL GOOD POSITIONNING. REPEAT THE SAME STEPS FOR EACH HEAD AND TIGHTEN EACH HEAD'S SET SCREW.

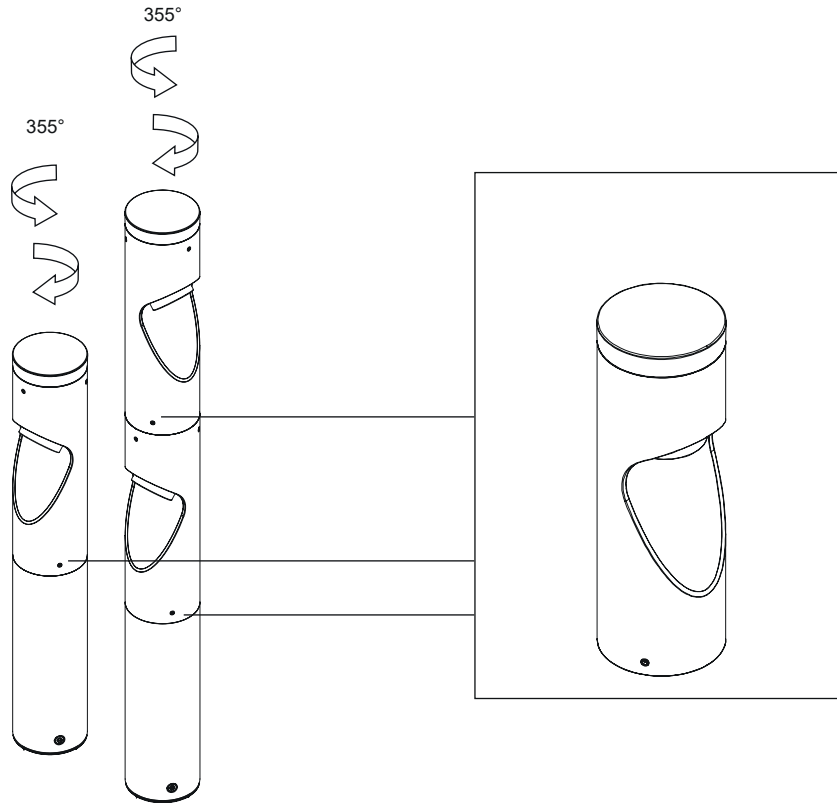
A**B**